

GF1 System Chart

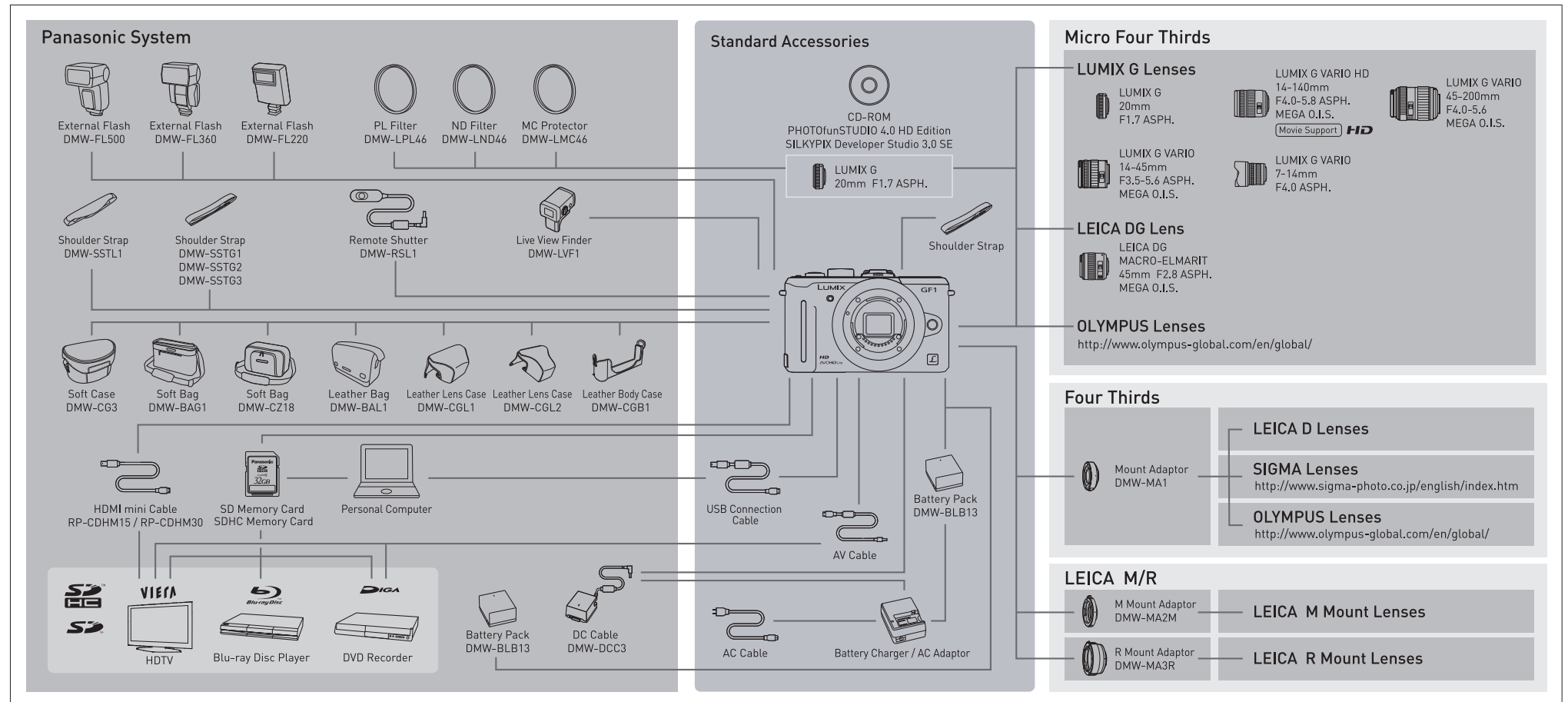

•Some functions of GF1 cannot be used when mounting the Four Thirds lenses with the Mount Adaptor DMW-MA1, the LEICA M or R lenses with the Mount Adaptor DMW-MA2M or DMW-MA3R. •Leica is a registered trademark of Leica Microsystems IR GmbH. •ELMARIT is a registered trademark of Leica Camera AG. •When a lens that does not support the Contrast AF function is mounted, operation will automatically switch to manual focus. •Confirm the operation information of compatible lenses at Customer Support <http://panasonic.jp/support/global/cs/dsc> (English). •For detailed information about the lenses made by SIGMA, OLYMPUS and LEICA, please see each company's website. •The DMW-BLB13 comes with a function to check whether the battery and unit can be safely used together. •Batteries made by other companies which have been certified by Panasonic may be used with these units, but we offer no guarantee as to the quality, performance or safety of such batteries. •Exercise care when purchasing batteries. Many fake or imitation batteries have been found among those sold at unusually low prices and those which customers cannot check for themselves before purchasing. •Please confirm the latest information about batteries on the following website. <http://panasonic.jp/support/global/cs/info/battery.html> (English). •The SDHC Memory Card can be used only if the SDHC logo is indicated on the equipment or in the operation manual. It cannot be used with equipment that supports only the SD Memory Card.