

Setup Guide for Wireless direct connection

1. Preparation

Please check Wi-Fi function of your mobile device is ON before setting up Wireless direct connection.

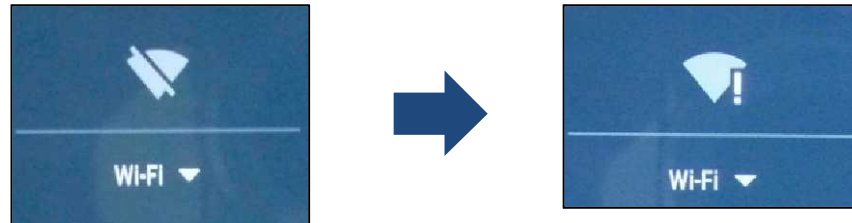

Tap this icon

2. Setup for first time (From second time, refer to page 5.)

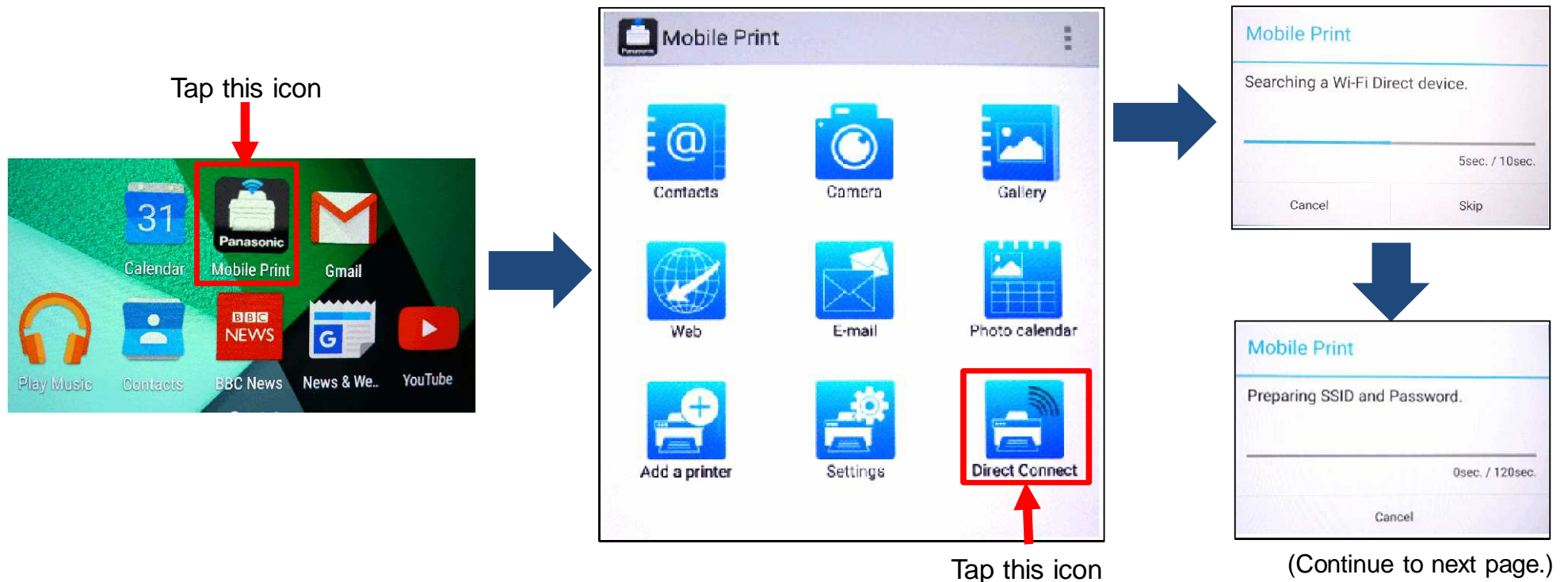

Mobile device

Start to operate MFP when this message is displayed.

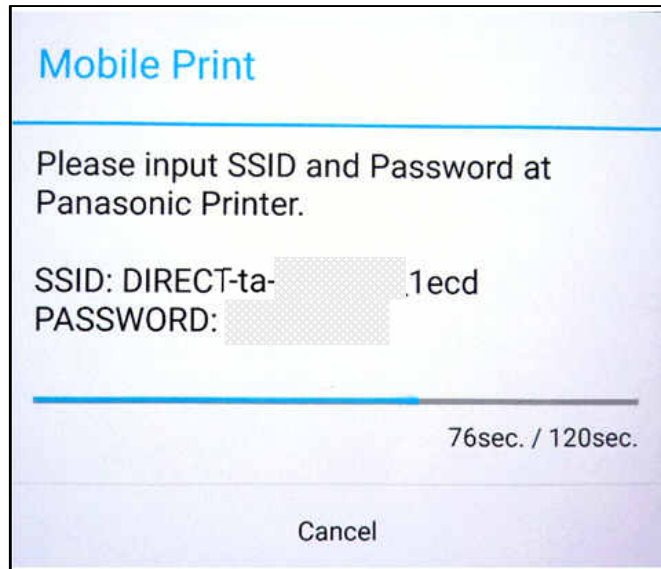

MFP

POWER SAVE
02 Jan. 0:42

COPIES:01
COPY:PRESS START

Follow the procedure in below by confirming above LCD message.

1 Press  twice.

MOBILE CONNECT
PRESS SET

2 Press 

SSID
SEARCHING...

SSID=DIRECT-ta-A

3 Press 

KEY=

(Continue to next page.)

Mobile device

MFP

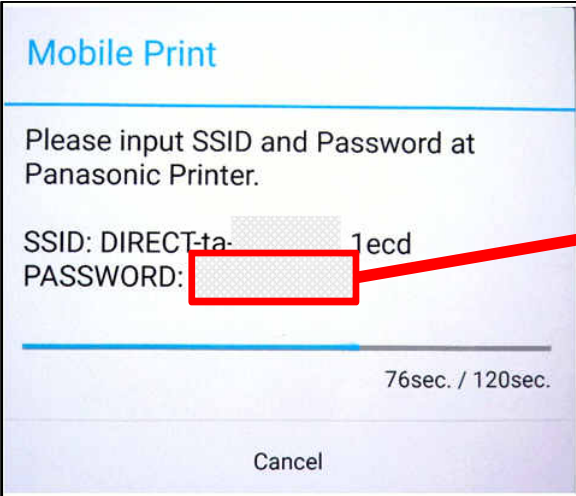

4 Enter password displayed on mobile device by key pad.



The dial keypad is used to enter characters and numbers.

- Press [◀] or [▶] to move the cursor.
- Press the dial keys to enter characters and numbers.
- Press [⊗] to erase the character or number highlighted by the cursor. Press and hold [⊗] to erase all characters or numbers.
- To enter another character located on the same dial key, press [▶] to move the cursor to the next space, then press the appropriate dial key.

[0]*1'2	[1]*1	[*]	[R]	[⊗]	[⊗]
0 @ () < > ! * # \$ % & \ ¥ * ^ ' ~ →	1 . _ - [] { } + / = , ; : ?	To switch between uppercase or lowercase letters.	Hyphen	To insert a space.	To delete a character.

*1 Several types of symbols cannot be entered for certain features.

*2 "¥" may be displayed as "¥" in some cases.

■ The following depends on the language selection (feature #110 on page 67).

"ENGLISH", "DUTCH", "CZECH", "HUNGARIAN", "SLOVAK", "FRENCH", "TURKISH"

[2]	[3]	[4]	[5]	[6]	[7]	[8]	[9]
ABC 2	DEF 3	GHI 4	JKL 5	MNO 6	PQRS 7	TUV 8	WXYZ 9
a b c 2	d e f 3	g h i 4	j k l 5	m n o 6	p q r s 7	t u v 8	w x y z 9

5 Press 



(Continue to next page.)

Mobile device

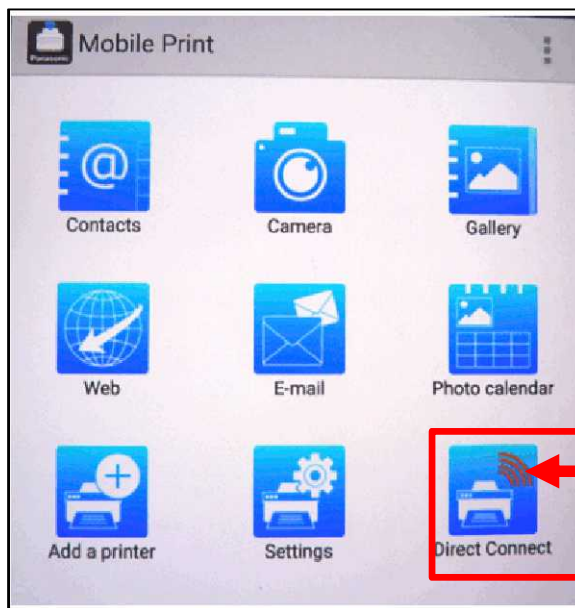
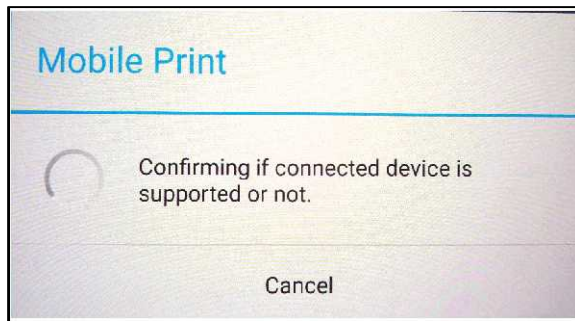

Changed to orange color

6 Tap Disconnect button after printing.

If you forget to disconnect, it is automatically disconnected.

You can change Auto-disconnection timer. (Refer to Q&A in this web site.)

MFP

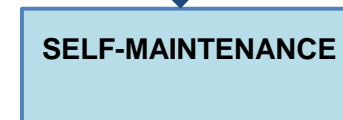
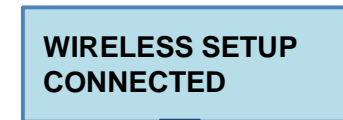

When "SELF-MAINTENANCE" message disappears, MFP is connected.

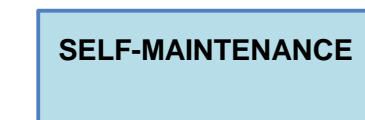
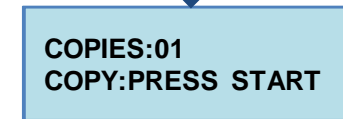

When "SELF-MAINTENANCE" message disappears, MFP is disconnected.

3. Setup for second time to same MFP

A. Disconnected case

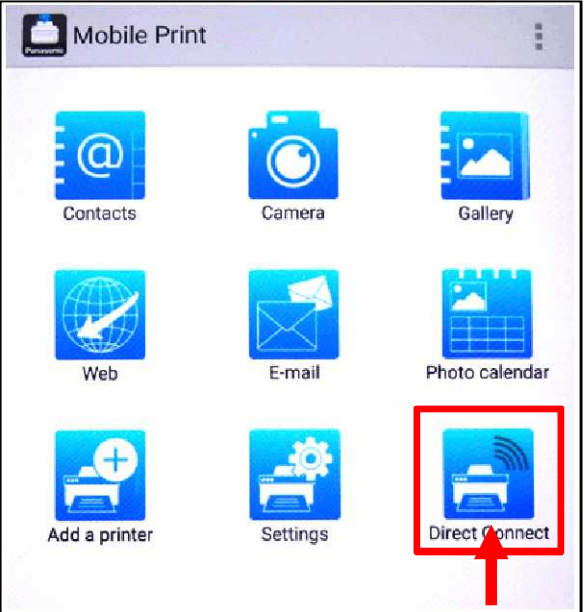

Tap this icon

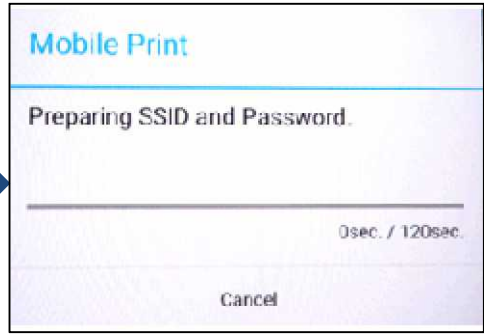

(Continue to next page.)

B. Connected case

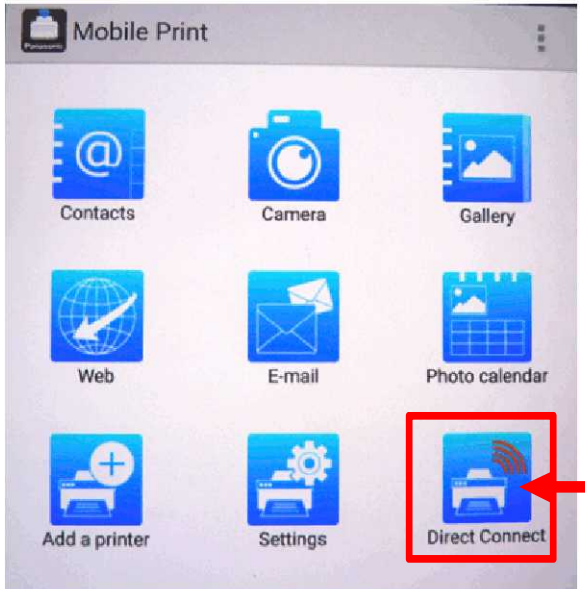

Tap this icon

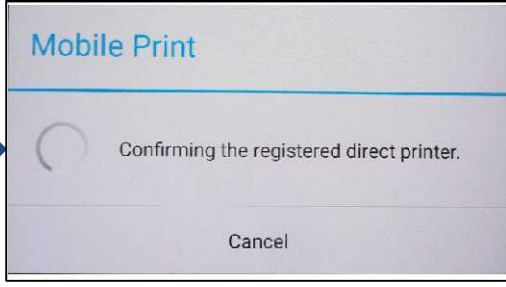

Mobile device

Start to operate MFP when this message is displayed.

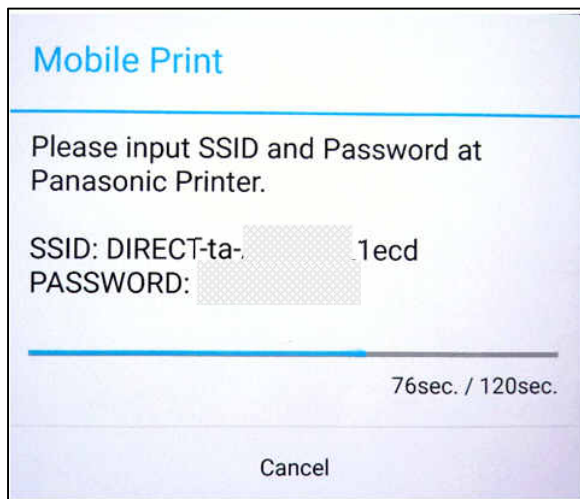

MFP

POWER SAVE
02 Jan. 0:42

COPIES:01
COPY:PRESS START

Follow the procedure in below by confirming above LCD message.

1 Press  twice.

MOBILE CONNECT
PRESS SET

2 Press 

SSID
SEARCHING...
↓
SSID=DIRECT-ta-A

3 Press 

WIRELESS SETUP
CONNECTING....

(Continue to next page.)

Mobile device

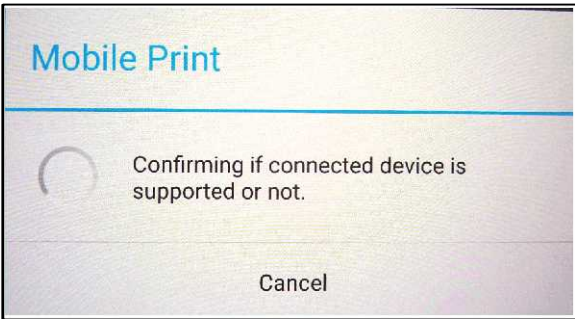

MFP

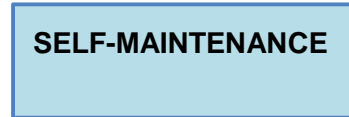
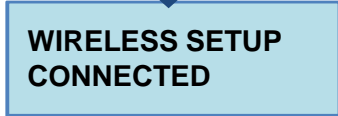
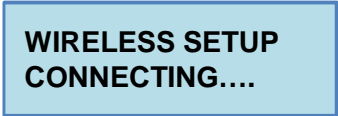

When "SELF-MAINTENANCE" message disappears, MFP is connected.

4 Tap Disconnect button after printing.
 If you forget to disconnect, it is automatically disconnected.
 You can change Auto-disconnection timer. (Refer to Q&A in this web site.)

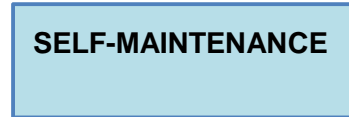

When "SELF-MAINTENANCE" message appears, MFP is disconnected.