

(4) Integrating HD Camera with hub features on iOS devices (Method 1)

If you have an existing hub and want to add an HD Camera with the integration of the hub's features, open the Home Network app and select Settings.

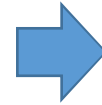

Plug in the HD camera and wait for the led to turn solid green then press the setup button on the camera and select Next

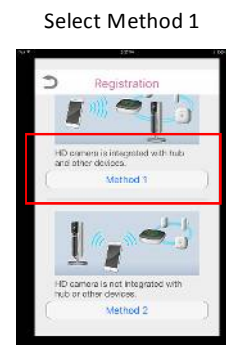
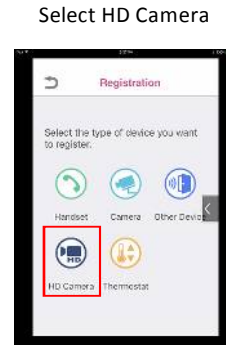
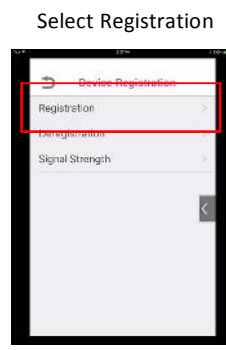
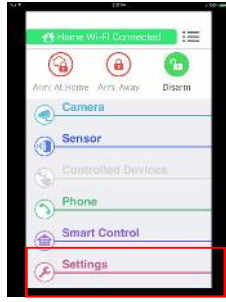
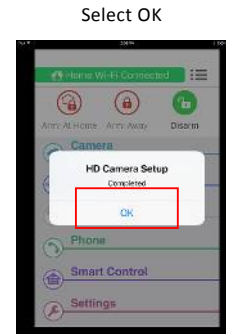
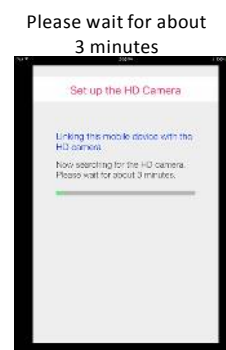
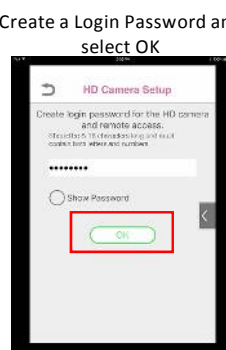
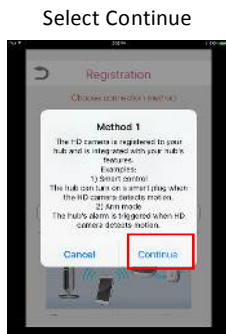

Select Camera

Select your integrated HD Camera

Enter the Login password you created and press OK to see a Live view

Completed !

