

High-Tro-Reel

<Tension Type>

Multi-Lead Indoor Use Insulated Trolleys 3P-4P 60A UL Listed 

A recommended power supply system for hoists and cranes. Installed using tension applied to both ends of the unit.

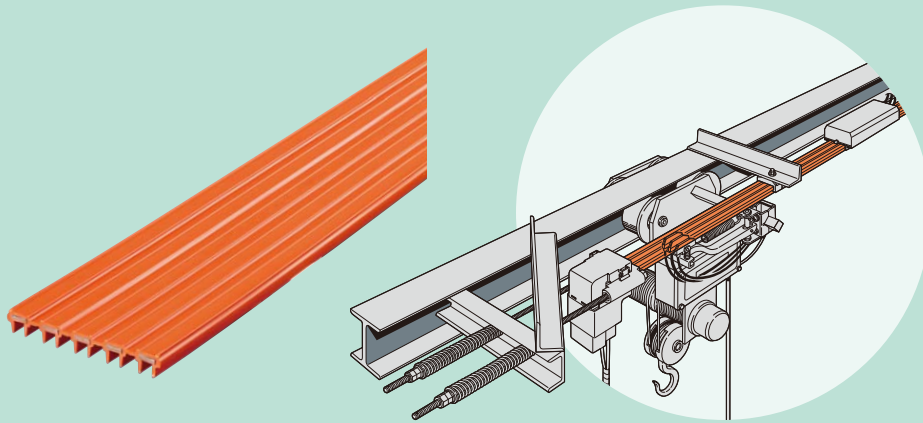

Reduces installation space to one-third.

Use of a multiple-lead system eliminates the need to provide space between leads as required in conventional insulated trolleys. This results in a space saving of 66% over the Tro-Reel insulated trolley.

●High-Tro-Reel

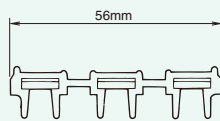

●Tro-Reel

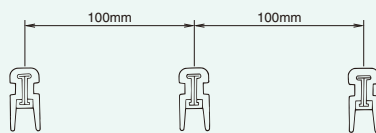

Reduces installation time.

Processes from unpacking to on-site cutting, setup, mounting onto the hangers and tension application can all be handled with the 3P unit. Its unique configuration eliminates the need for straightening and other adjustments after installation. This reduces installation time compared to conventional insulated trolleys.

50 meter jointless installation.

High-Tro-Reel coils are 50m long, so there is no need for joints in installations up to 50m. Using joiners can make even lines longer than 50m easy to install. With 60A and 90A units, joiners can supply power from anywhere on the line.

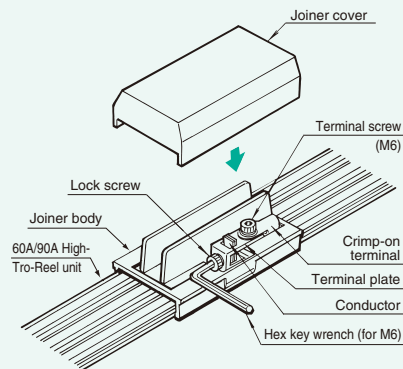

Perfect for powering hoists and cranes.

4P and 5P types are ideal for hoists and cranes requiring multiple lead wiring (including control leads) in a confined space.

Dependable power collection during travel.

Since the collector arms maintain stable contact pressure, there is less chance for the collectors to become separated from wires due to vibration or swinging.

⚠ Please follow the safety precautions on page 2.

Note : Refer to page 43 for the products with CE Mark.

60A/90A High-Tro-Reel units (for indoor use only)

- Rating 3P, 4P, 5P at 600V, 60A, 90A
- Conductor materials 60A: Steel (8mm²) + Copper (20mm²), 90A: Copper (28mm²)
- Insulating sheath material Rigid PVC (heat resistance: 75°C) Orange (hazard color) (Munsell 2.5YR 6/13)



※5P(DH5767)

60A

Cat. No.	Rating	Length	Weight (kg)
DH5761	3P 600V 60A	10m	10.2
DH5763		30m	30.5
DH5765		50m	50.9
DH5762	4P 600V 60A	10m	13.8
DH5764		30m	41.5
DH5766		50m	69.1
DH5767	5P 600V 60A	10m	17.1
DH5768		30m	51.3
DH5769		50m	85.4

60A (UL Listed)

Cat. No.	Rating	Length	Weight (kg)
DH5761U	3P 600V 60A	10m	10.2
DH5763U		30m	30.5
DH5765U		50m	50.9
DH5762U	4P 600V 60A	10m	13.8
DH5764U		30m	41.5
DH5766U		50m	69.1

※Available in coil form only. Contact us in case of non-standard length.

●Cross-section

3P60A

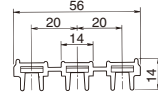

3P90A

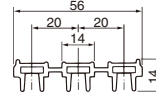

4P60A

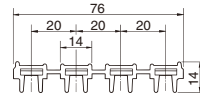

4P90A

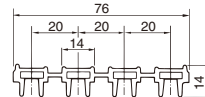

5P60A

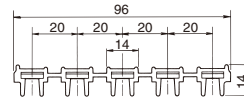

5P90A

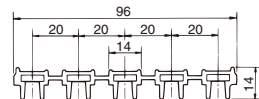

90A

Cat. No.	Rating	Length	Weight (kg)
DH5791	3P 600V 90A	10m	10.6
DH5793		30m	31.7
DH5795		50m	52.8
DH5792	4P 600V 90A	10m	14.2
DH5794		30m	42.6
DH5796		50m	71.0
DH5797	5P 600V 90A	10m	17.9
DH5798		30m	53.6
DH5799		50m	89.3

※Available in coil form only. Contact us in case of non-standard length.

150A/200A High-Tro-Reel units (for indoor use and machine interior use only)

- Rating 3P, 4P at 600V, 150A, 200A
- Conductor material 150A/200A: Copper (46.2mm²),
- Insulating sheath materials 150A: Rigid PVC (heat resistance: 75°C) 200A: Rigid PVC (heat resistance: 95°C) Orange (hazard color) (Munsell 2.5YR 6/13)

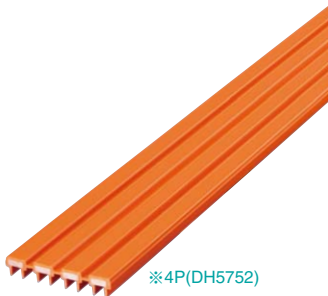

※4P(DH5752)

150A

Cat. No.	Rating	Length	Weight (kg)
DH5751	3P 600V 150A	10m	15.2
DH5753		30m	45.5
DH5755		50m	75.8
DH5752	4P 600V 150A	10m	20.4
DH5754		30m	61.1
DH5756		50m	101.8

※Available in coil form only. Contact us in case of non-standard length.

●Cross-section

3P150A

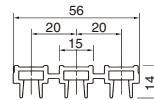

3P200A

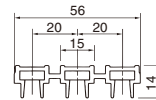

4P150A

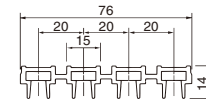

4P200A

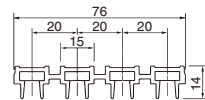

200A

Cat. No.	Rating	Length	Weight (kg)
DH5731	3P 600V 200A	10m	15.2
DH5733		30m	45.5
DH5735		50m	75.8
DH5732	4P 600V 200A	10m	20.2
DH5734		30m	60.5
DH5736		50m	100.8

※Available in coil form only. Contact us in case of non-standard length.

End tension insulator

Attached to both ends of the High-Tro-Reel unit to absorb expansion and contraction due to temperature fluctuations.
For 60A, 90A, 150A, and 200A.

Note: Can be used with lines 100m or less in length.

- With feed-in terminal (Cable bottom-out type).
For 60A, 90A, 150A and 200A.

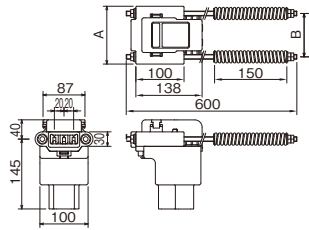
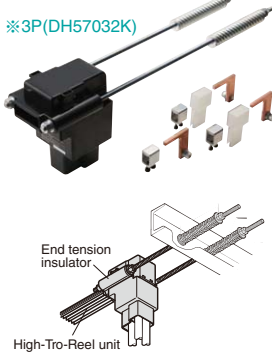

Drawing shows a 3P end tension insulator.

- With feed-in terminal (Cable side-out type).
For 60A, 90A, 150A and 200A.

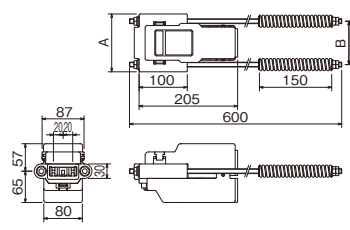

Drawing shows a 3P end tension insulator.

- Without feed-in terminal.
For 60A, 90A, 150A and 200A.

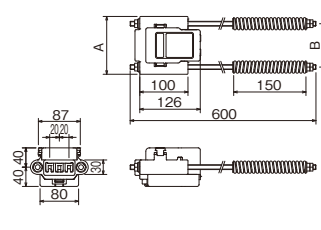
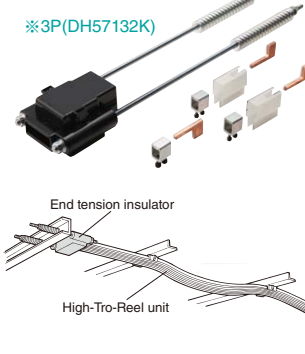

Drawing shows a 3P end tension insulator.

After setting the High-Tro-Reel unit, the terminal, and the terminal plate in the end tension insulator. The terminal plate and the terminal where fixed bolt M6x12 was tightened with the specified torque cannot be used again.

Don't use them again.

Please inquire of store purchased when the terminal and the terminal plate are necessary.

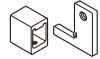

	A	B
3P	120	90
4P	140	110
5P	160	130

- With feed-in terminal (Cable bottom-out type)

Cat. No.	Type	Weight (kg)	Units per box	Units per carton
UL DH57032K	For 3P	1.8	—	1
UL DH57042K	For 4P	2.1	—	1
DH57052	For 5P	2.4	—	1

- With feed-in terminal (Cable side-out type)

Cat. No.	Type	Weight (kg)	Units per box	Units per carton
UL DH57034K	For 3P	1.8	—	1
UL DH57044K	For 4P	2.1	—	1
DH57054	For 5P	2.4	—	1

- Without feed-in terminal

Cat. No.	Type	Weight (kg)	Units per box	Units per carton
UL DH57132K	For 3P	1.7	—	1
UL DH57142K	For 4P	2.0	—	1
DH57152	For 5P	2.3	—	1

End tension insulator for lateral movement

Tension insulator for use in short-distance line internal wiring such as in cranes. Since the end tension insulator comes equipped with inward-facing springs for tension application, the High-Tro-Reel provides the most effective use of factory space.

For installation procedures, please refer to the specialized installation manual.

- With feed-in terminal (Cable bottom-out type).
For 60A, 90A, 150A and 200A.

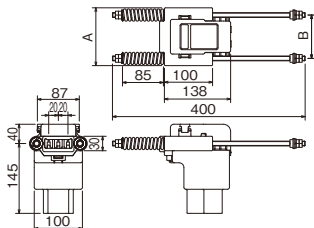
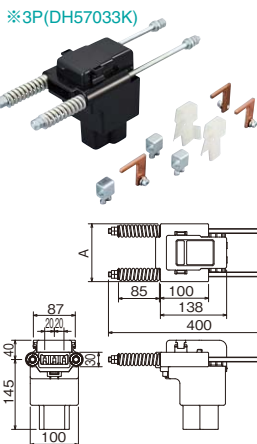

Drawing shows a 3P end tension insulator.

- With feed-in terminal (Cable side-out type).
For 60A, 90A, 150A and 200A.

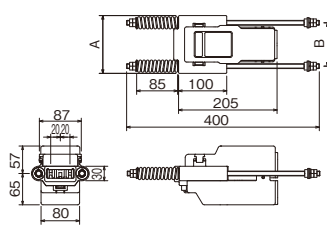
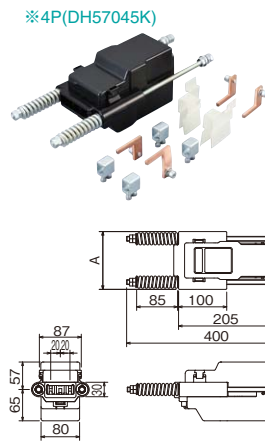

Drawing shows a 3P end tension insulator.

- Without feed-in terminal.
For 60A, 90A, 150A and 200A.

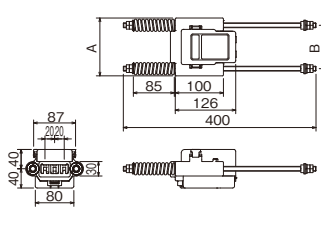
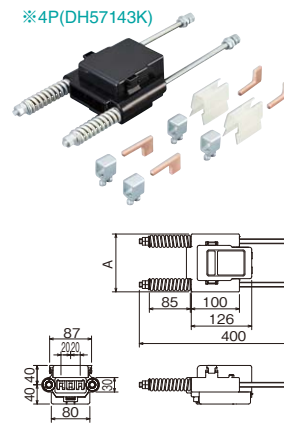

Drawing shows a 3P end tension insulator.

After setting the High-Tro-Reel unit, the terminal, and the terminal plate in the end tension insulator. The terminal plate and the terminal where fixed bolt M6x12 was tightened with the specified torque cannot be used again.

Don't use them again.

Please inquire of store purchased when the terminal and the terminal plate are necessary.

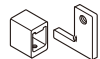

	A	B
3P	120	90
4P	140	110
5P	160	130

- With feed-in terminal (Cable bottom-out type)

Cat. No.	Type	Weight (kg)	Units per box	Units per carton
UL DH57033K	For 3P	1.5	—	1
UL DH57043K	For 4P	1.8	—	1
DH57053	For 5P	1.8	—	1

- With feed-in terminal (Cable side-out type)

Cat. No.	Type	Weight (kg)	Units per box	Units per carton
UL DH57035K	For 3P	1.5	—	1
UL DH57045K	For 4P	1.8	—	1
DH57055	For 5P	1.8	—	1

- Without feed-in terminal

Cat. No.	Type	Weight (kg)	Units per box	Units per carton
UL DH57133K	For 3P	1.4	—	1
UL DH57143K	For 4P	1.7	—	1
DH57153	For 5P	1.7	—	1

Joiner

Used to connect the High-Tro-Reel units. Can also supply power from anywhere on the line (60A and 90A types).

- With feed-in terminal
For 60A and 90A



※4P(DH5724K2)

- Without feed-in terminal
For 150A and 200A



※4P(DH5727K1)

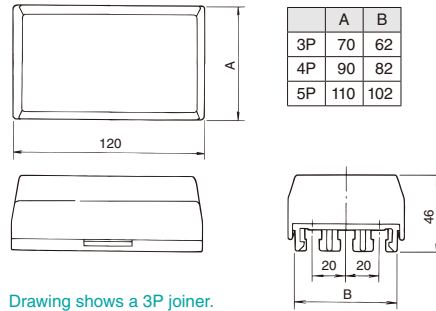

Drawing shows a 3P joiner.

Cat. No.	Type	Rating	Weight (kg)	Units per box	Units per carton
DH5723K	For 3P, 60A/90A	3P 600V 90A	0.18	1	20
DH5724K2	For 4P, 60A/90A	4P 600V 90A	0.31	1	10
DH5725	For 5P, 60A/90A	5P 600V 90A	0.37	1	10
DH5726	For 3P, 150A/200A	3P 600V 200A	0.20	1	20
DH5727K1	For 4P, 150A/200A	4P 600V 200A	0.26	1	10

Center feed-in joiner

Used to feed power from anywhere on the line and connect the High-Tro-Reel units (150A and 200A types).

- With feed-in terminal
For 150A and 200A



※4P(DH57271)

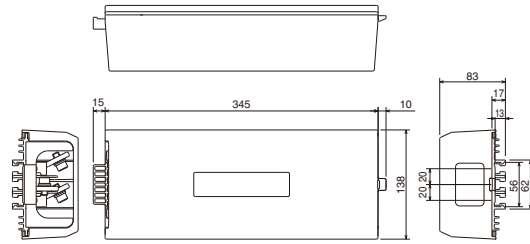

Drawing shows a 3P center feed-in joiner.

Cat. No.	Type	Rating	Weight (kg)	Units per box	Units per carton
DH57261	For 3P, 150A/200A	3P 600V 200A	1.9	—	1
DH57271	For 4P, 150A/200A	4P 600V 200A	2.2	—	1

Hanger

UL Listed

Used to mount the High-Tro-Reel units on the side of a rail. Can also be used with tension type units. Standard support interval is 400mm.

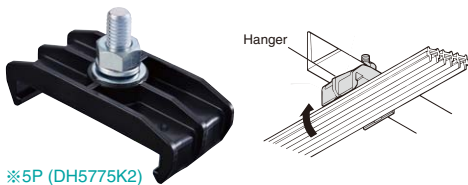

※5P (DH5775K2)

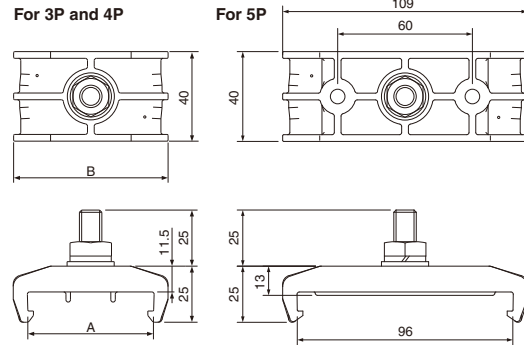

Drawing shows 3P and 5P hangers. 3P and 4P types are not equipped with a ϕ 6.5mm hole.

	A	B
3P	56	69
4P	76	89

Cat. No.	Type	Weight (kg)	Units per box	Units per carton
DH5773K2	For 3P	0.06	20	100
DH5774K2	For 4P	0.07	10	50
DH5775K2	For 5P	0.08	10	50

Collector arm

Attached to the moving equipment and used to supply power from the High-Tro-Reel unit to the equipment.

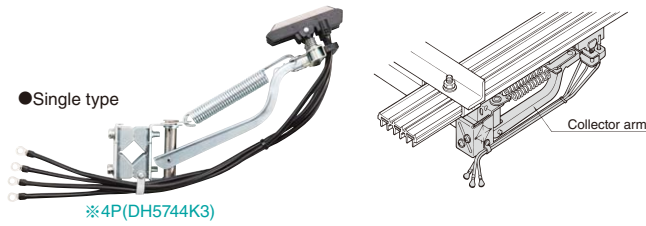

Collector arms can be linked together and used in tandem configuration when it is critical that the collectors are not separated from the wires.



Cat. No.	Rating	Weight (kg)	Units per box	Units per carton
UL DH5743K3	3P 600V 30A	0.67	—	1
UL DH5744K3	4P 600V 30A	0.98	—	1
DH5745K2	5P 600V 30A	1.08	—	1
DH5746K2	3P 600V 60A	0.81	—	1
DH5747K2	4P 600V 60A	1.16	—	1
DH5748K2	5P 600V 60A	1.32	—	1
DH5741K2	3P 600V 100A	1.06	—	1
DH5742K2	4P 600V 100A	1.41	—	1

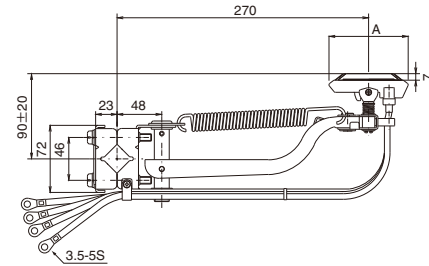

※Drawing shows 4P collector arm.

Collector arm support parts for transverse

Applicable for 30A, 60A, and 100A collector arms. When installing a collector arm horizontally, mounted collector arm support parts for transverse on base of the collector arm as shown.

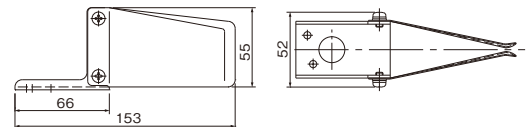
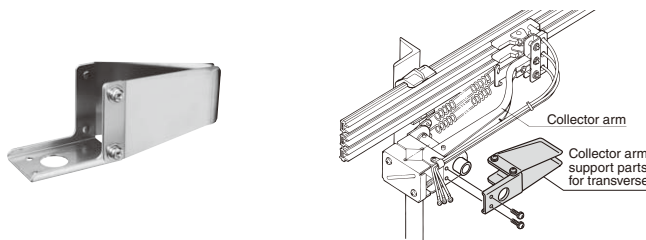

The above shows when it is installed.

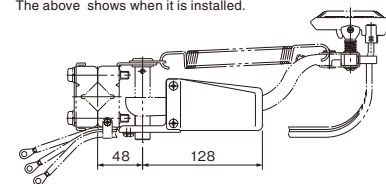

Cat. No.	Weight (kg)	Units per box	Units per carton
DH5249K	0.13	1	24

Collector (replacement parts)

The number of collectors in a set conforms to the number of poles. Replace collectors when they wear down to the replacement indication line (approx. 5,000km).

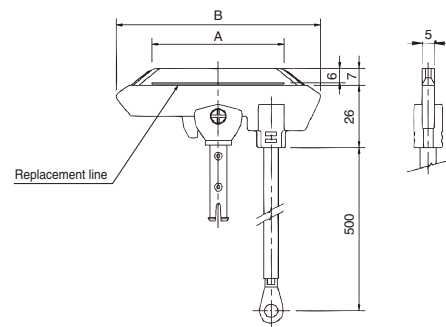
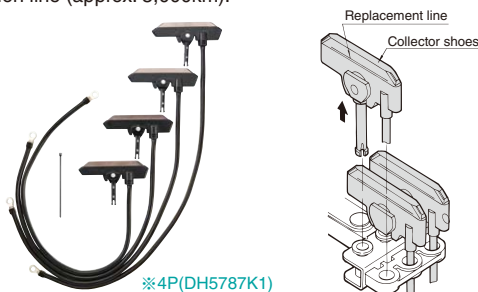

Cat. No.	Rating	Units per box	Units per carton
DH5783K1	3P 600V 30A	1	30
DH5784K1	4P 600V 30A	1	20
DH5785K1	5P 600V 30A	1	20
DH5786K1	3P 600V 60A	1	30
DH5787K1	4P 600V 60A	1	20
DH5788K1	5P 600V 60A	1	20
DH5781K2	3P 600V 100A	1	20
DH5782K2	4P 600V 100A	1	10

	A	B	Crimp-on terminal
30A	55	85	R3.5-5S 3.5-R5 R3.5-5
60A	70	100	R8-6
100A	95	125	R14-6