

使用说明书(简化版)

电动螺丝刀

型号 EYADA系列
WA型号
WB型号



重要信息

使用本产品之前,请先仔细阅读说明书,并妥加保管,以便日后使用。

请在购买国以外控制使用无线功能。

否则会与各国的法令及规定等发生冲突。

所在地区不供货的型号,请参阅最新总目录。

原版说明书:英文

原版说明书译本:其他语言

目次

产品特点	2
安全注意事项	4
各部分的名称	
系统配置	
动作模式	
设置步骤一览	
使用前的准备	10
使用方法	
与控制器配对	
通过Web浏览器设置	
通过主体设置	
性能、规格	14
无线通信注意事项	16
维护、保管	17
错误显示	18
索引	
许可规定	26

使用前

准备

操作

其他

灰色内容不在本简版使用说明书范围之内。

如需阅读有关本产品说明的全部内容,请获取电子档使用说明书(下载版)。

如需完整版使用说明书,请参见官网。

<https://panasonic.net/electricworks/ecm/powerelctrictools/download/>



产品特点

本产品是一款搭载无刷电机的电动螺丝刀，具有轻便、易握持的特点。

本产品易于操作，无需更换刷子，具有良好的易维护性，可让作业变得更舒适。

※ 通过和控制器端连接，可以批量设置各种功能。
(请务必连接控制器使用)

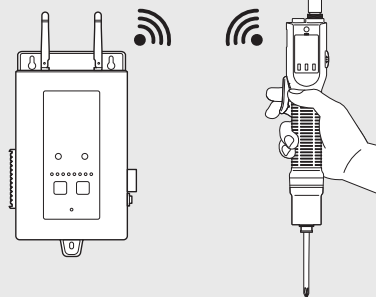

■ 请勿忘记紧固螺丝 **WEB使用说明书 P. 40**

设置要进行紧固的螺丝数量。

■ 想知道紧固状态 **WEB使用说明书 P. 26**

设置判定指示灯。

■ 想进行螺丝紧固合格与否判定 **WEB使用说明书 P. 33~36**

设置参数的上下限值。

■ 想选择拉杆启动、按压启动

WEB使用说明书 P. 21

设置启动方式。

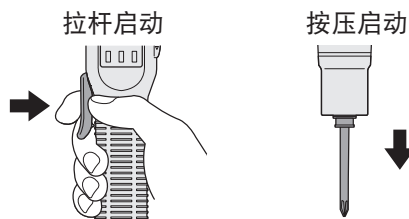

■ 想减少工具的取错率

设置工具的使用顺序。

※ 请参见控制器(EYARW1)的使用说明书中记载的“设置紧固控制模式”。

■ 想知道、保留紧固数据

可通过计算机的Web浏览器确认紧固履历数据。

如果使用另售的控制器管理软件，不仅可以自动收集紧固履历数据，还可进行简单的数据分析。

■ 想知道、保留紧固扭矩值 **WEB使用说明书 P. 33**

保留扭矩换算值。需要设置修正值。(仅WA型号)

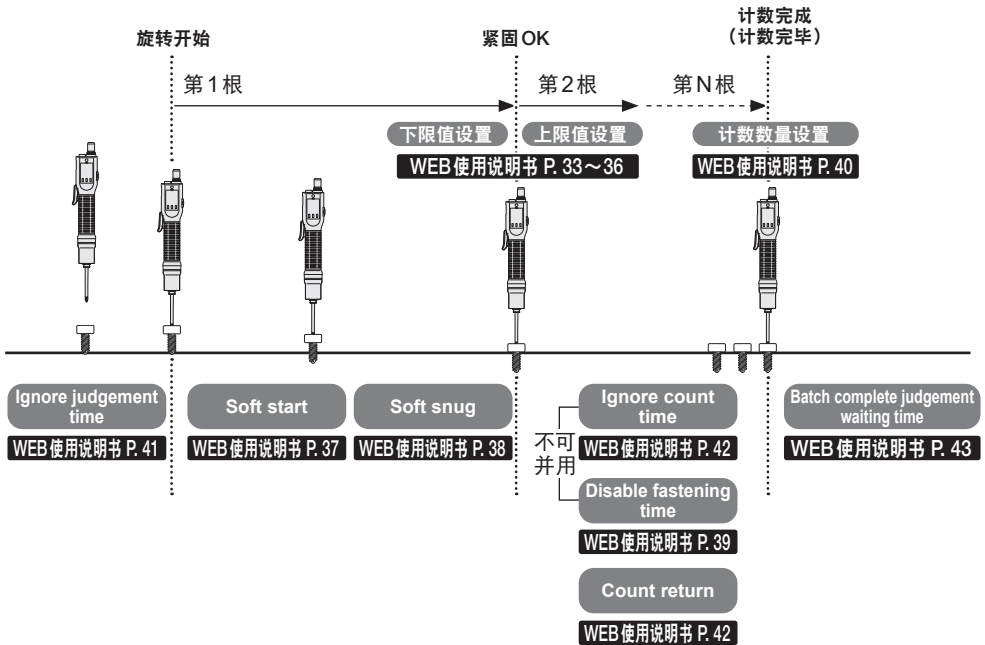

■ 螺丝紧固中的主要支持功能





以下情形时	支持功能	参照页
想将意外的短时间旋转排除在判定之外。	Ignore judgement time	WEB 使用说明书 41
想让开始时的旋转变慢。(防拧斜等)	Soft start	WEB 使用说明书 37
想让着座前的旋转变慢。(缓和冲击等)	Soft snug	WEB 使用说明书 38
不想对二次紧固进行计数。(一定时间)	Ignore count time	WEB 使用说明书 42
想禁止二次紧固。(一定时间)	Disable fastening time	WEB 使用说明书 39
想设置反转作业时的计数处理。	Count return	WEB 使用说明书 42
想设置最终数量之后进行反转作业时的处理。	Batch complete judgement waiting time	WEB 使用说明书 43



为了防止对人的危害和财产的损害,请务必遵守说明事项。

■ 针对错误使用时产生的危害和损害程度进行区分并说明。

 警告	可能造成死亡或重伤的内容。
 注意	可能造成轻伤或发生财产损害危险的内容。

■ 使用以下图片符号表示必须遵守的内容。(以下是图片符号的示例)

 绝对禁止的内容。
 必须执行的内容。

 警告	
 务必遵守	<ul style="list-style-type: none">● 日常管理扭矩。 如不遵守,将会因扭矩变动而造成螺丝松动,引发事故。
	<ul style="list-style-type: none">● 中断作业时及不使用时,确认没有运行。● 更换钻头和配件时,以及保管主体时,请务必将正/反转扳手置于开关锁定位置,并拔出电源适配器的电源线。 如不遵守,可能会因意外运行而引发事故。
	<ul style="list-style-type: none">● 使用过程中,保持主体不动,避免左右摆动。 否则可能会导致人员受伤。
	<ul style="list-style-type: none">● 在声音嘈杂的作业环境中,要佩戴耳塞、帽扇(耳罩)等隔音防护用品。 如不遵守,可能会损伤听力。
	<ul style="list-style-type: none">● 作业时要使用护目镜。 如不遵守,可能会损伤眼睛、喉咙。
	<ul style="list-style-type: none">● 电源插头要切实插到底。 如未插到底,可能会因触电或发热而引起火灾。 请勿使用损伤的插头、松动的插座。

警告

● **定期清除电源插头上的灰尘等。**

如果插头上积有灰尘等,就会因受潮等而造成绝缘不良,继而引发火灾。
请拔出电源插头,用干布擦拭。

● **使用指定的配件或附件。**

如不遵守,可能会造成人员受伤。

● **作业场所要足够明亮。**

昏暗会使视线变差,从而导致事故或人员受伤。

● **加工物要牢固固定。**

否则可能会发生意外移动,导致人员受伤。
使用夹钳或虎钳等固定,确保安全。

● **使用过程中,如果主体使用状况变差,或发出异音,请立即关闭开关,停止使用。**

请咨询您所购买的销售店或 Panasonic 客户咨询中心。如果继续使用,将导致人员受伤。

● **请按照使用说明书牢固安装钻头等尖头工具类及配件。**

如未安装牢固,可能会因脱落而导致人员受伤。

● **拆除用于调节的键及扳手等工具类后再使用。**

如不遵守,可能会因意外脱落而导致人员受伤。

● **穿着整洁的衣物进行作业。**

- 请勿穿着宽松的衣物及佩戴项链等饰品,否则可能会被卷入旋转部。
- 在室外进行作业时,建议穿着防滑鞋。
- 请用帽子或发套等将长发包住。

● **高空作业时,确保底下无人,并用绳索等拴住,以免主体掉落。**

否则,主体掉落可能会导致人员受伤。

● **使用本公司专用螺丝刀电源线、电源适配器、电源线。**

如不遵守,可能会导致事故及人员受伤。



务必遵守

警告

- **使用时请勿超过插座和配线器具的额定值。仅限在电气额定范围内使用。**

如果由于并联等方式超出额定值, 会因发热而引起火灾。

- **请勿损坏螺丝刀电源线、电源线、电源插头。(不要损伤、破坏、加工、靠近发热器具、强行弯曲、拧扭、拉伸、放置重物、夹入、捆扎)**

如果在本产品损伤的情况下使用, 会造成触电、短路、火灾。

定期检查电线和插头, 如有破损, 请咨询销售商。

- **主体冒烟时, 请勿吸入烟气。**

否则会对身体造成损害。

- **作业刚结束时, 请勿触摸钻头等尖头工具类和螺丝、切屑。**

否则会因高温而烫伤。

- **请勿用于非指定用途。**

否则可能会造成人员受伤。

- **主体沾有油等异物时, 请勿使用。**

否则, 主体可能会掉落从而引发事故。

此外, 如果油等异物进入主体内部, 可能会导致发热、起火、破裂。

- **使用过程中, 身体或身体部位请勿靠近钻头等旋转部及切屑。**

否则, 可能会意外碰到脱落或破损的钻头及切屑, 从而造成人员受伤。请定期更换钻头等尖头工具。

- **请勿在其他设备上使用本公司专用螺丝刀电源线、电源适配器、电源线。**

否则可能会引发事故或导致人员受伤。

- **请勿在周边有石棉的环境下(包括清除作业)使用。**

否则可能会损害健康。

石棉是一种会严重危害人体健康的物质, 例如会导致肺癌等, 请充分注意。



禁止

警告



禁止

- 不使用时,将电源插头从插座中拔出。
如不遵守,将会因绝缘老化而导致触电或漏电起火。



禁止接触

- 打雷后,请勿触摸本产品及电源插头。
否则会触电。



禁止拆解

- 不得改装。且不可拆解或维修。
否则可能会引起火灾、触电、人员受伤。
维修事宜请咨询您所购买的销售店或本公司咨询窗口。



禁止淋水

请勿进行以下操作。

- 请勿在淋雨或潮湿场所使用或放置。
- 使用时不要浸入水中。
否则可能会出现冒烟、起火、破裂。



禁止湿手

- 请勿用湿手从插座中插拔电源插头。
否则可能会触电。

注意



务必遵守

- **主体发烫时,应中断作业,待温度下降后再使用。**
如不遵守,可能会造成烫伤。
- **拔出电源插头时,请务必握住电源插头拔出,而不是拉扯电源线。**
如果拉扯电源线拔出,将会导致触电、短路。
- **使用前,请确认主体、尖头工具和其他零件有无损伤,是否能正常运转。**
如不遵守,可能会因破损等而造成人员受伤。
- **请保持作业场所干净整洁。**
场所和作业台散乱会引发事故。
- **充分注意操作、作业方法及周围状况等,以常识进行作业。**
如不遵守,可能会引发事故或导致人员受伤。
- **壁挂安装电源适配器时,需用螺丝牢牢固定,防止掉落。**
否则可能会因掉落而导致人员受伤。



禁止

- **请勿放置在儿童可以触及的场所。**
否则可能会引发事故或故障。
- **请勿将主体存放在温度为 50 °C 以上的场所。**
否则可能导致动作异常。
- **请勿在电机锁定时强行使用。**
否则可能会出现冒烟、起火。
请用与性能适配的速度作业,以便安全高效地进行作业。

⚠ 注意



禁止

- **请勿在不合理的姿势下作业。**

否则可能会摔倒而受伤。
请时刻注意脚底,保持平衡。

- **疲劳时请勿使用。**

否则可能会引发事故或人员受伤。

- **请勿让儿童等非作业人员靠近车间或触碰主体。**

否则可能会导致人员受伤。

- **请勿随身携带电线。**

否则,可能会因主体掉落导致人员受伤。

使用前的准备

使用正/反转扳手

使用正/反转扳手可以更改电动螺丝刀的旋转方向,或锁定启动。

开关位置	旋转方向
R	反转(左转)
○	开关锁定状态
F	正转(右转)

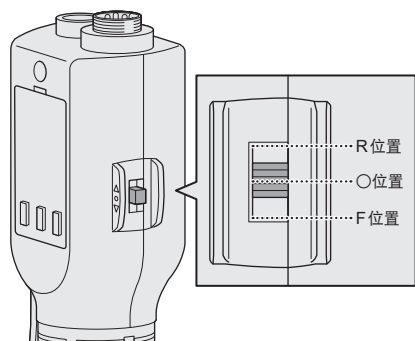

开关锁定

如将正/反转扳手切换至“○”的位置,会锁定电动螺丝刀的启动而不旋转。安装配件和钻头时,或不进行作业时,请将正/反转扳手切换至“○”的位置,置于开关锁定状态。

通知

- 如在旋转中操作正/反转扳手,会强制停止旋转。

安装螺丝刀挂具

- 1 将螺丝刀挂具向两侧轻拉**
如用力拉螺丝刀挂具,将无法复原。请用安装、拆卸所需的力度进行操作。

- 2 放入螺丝刀挂具安装孔**

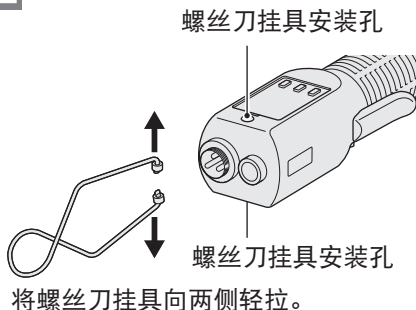

请按图中所示安装螺丝刀挂具和工具平衡器。

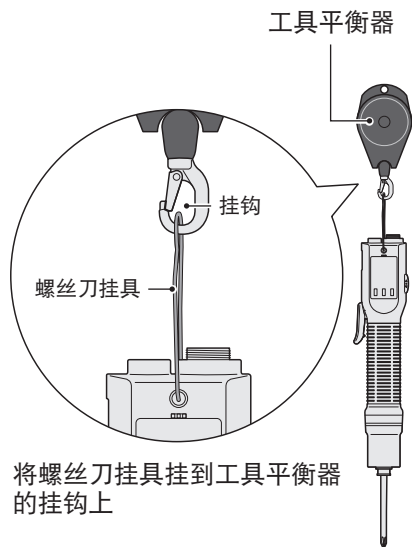

安装钻头

要求

- 安装、拆卸钻头时,请将正/反转扳手置于“○(开关锁定状态)”的位置,然后关闭电源适配器的电源开关。

P. 10、13

■ 本机可安装的钻头

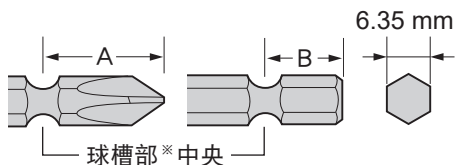

※ 不可使用不含球槽部的直钻头。

A 的长度 (双头钻头)	12 mm~17.5 mm
B 的长度 (单头钻头)	9 mm~13 mm

1 拉伸钻套

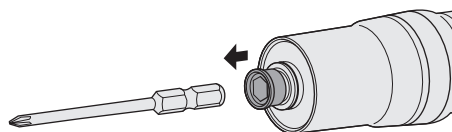

2 插入钻头

请在钻套拉伸的状态下插入。

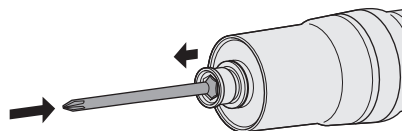

3 松开钻套

请轻拉钻头,确认不会脱落。

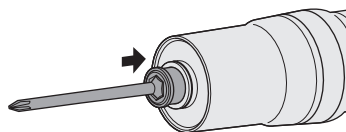

拆卸钻头

要求

- 作业刚结束时,请勿触摸钻头 etc 尖头工具类及螺丝。否则会因高温而烫伤。

1 拉伸钻套

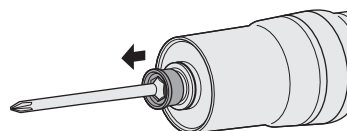

2 拆下钻头

请在钻套拉伸的状态下拔出。

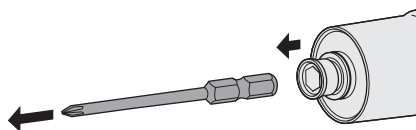

准备

使用前的准备 (续)

安装握柄附件

所有机型均可安装。
(仅EYADA407WA·WB标配)

可阻断联轴器运转时的反作用力,减轻疲劳。

以拉杆启动方式使用时

将握柄附件的槽和握柄的加强筋对齐

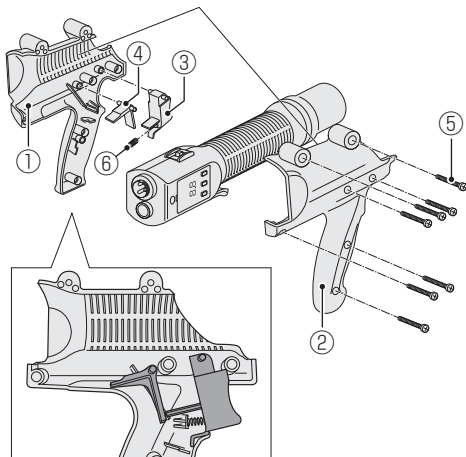

以按压启动方式使用时

将握柄附件的槽和握柄的加强筋对齐

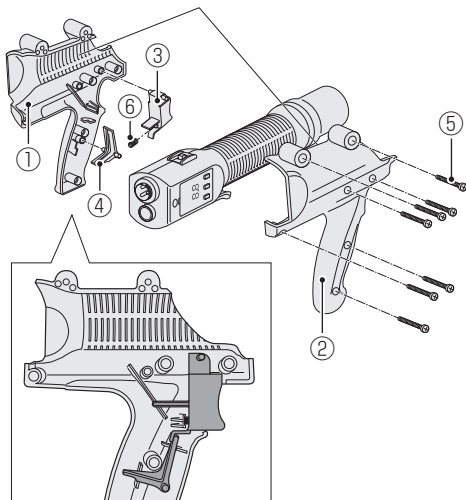

套件内容

①	握柄附件(A) … 1个
②	握柄附件(B) … 1个
③	触发器 … 1个
④	接头 … 1个
⑤	螺丝 … 7个
⑥	弹簧 … 1个

要求

- 安装、拆卸握柄附件时,请将正/反转扳手置于“○(开关锁定状态)”的位置,然后关闭电源适配器的电源开关。

P. 10、13

- 请先将钻头拆下后,再安装、拆卸握柄附件。
- 请用螺丝固定握柄附件后,再确认螺丝有无松动、摇晃、偏离。

1 将握柄附件(A)的槽和主体握柄的加强筋对齐

2 将触发器和接头安装到图中的位置

3 将握柄附件(B)的槽和主体握柄的加强筋对齐

4 紧固螺丝
请确认螺丝有无松动、摇晃、偏离。

螺丝刀挂具安装孔(2处)

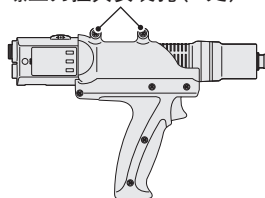

连接电源

要求

- 请将正/反转扳手置于“○”的位置，锁定开关后进行连接。 **P. 10**
- 请勿使用非本公司的电源（螺丝刀电源线、电源适配器、电源线）。此外，请勿在其他设备上使用本公司专用电源和电源线。
- 长期不使用时，建议从插座中拔出电源线。即使未打开本产品电源，也会消耗电量。

1 将螺丝刀电源线连接到电源适配器和本产品

请确认连接器的方向，正确安装。
用接头环固定。

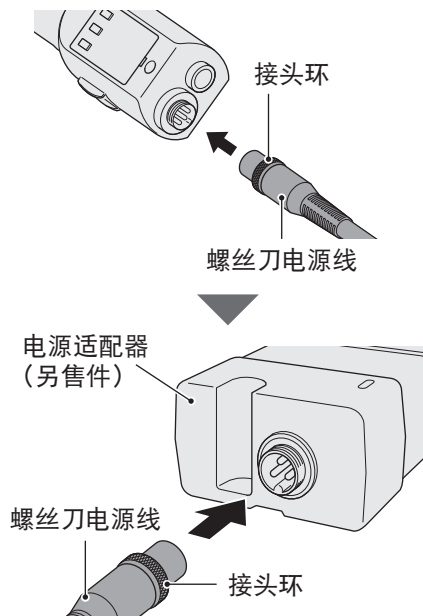

2 将电源线安装到电源适配器

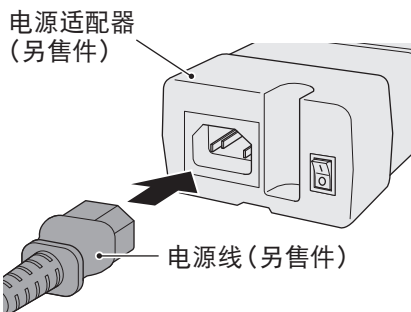

3 确认电源适配器的电源开关已关闭

电源 OFF 时，电源指示灯熄灭。

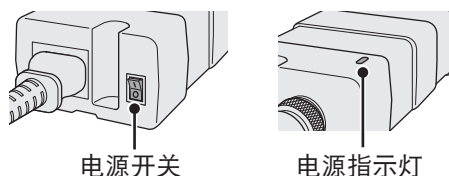

4 将电源插头插入插座

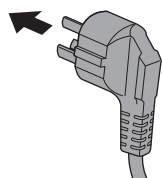

例：中国大陆

5 打开电源适配器的电源开关

电源指示灯亮绿灯。

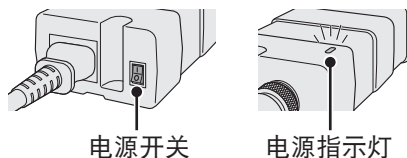

准备

性能、规格

主体性能

型号	EYADA112WA EYADA112WB	EYADA212WA EYADA212WB	EYADA218WA EYADA218WB	EYADA407WA EYADA407WB
建议作业	小螺丝： M2~M3.5	小螺丝： M2.5~M4.5	小螺丝： M2.5~M4	小螺丝： M3.5~M5
扭矩设置范围	0.1 N·m~1.0 N·m	0.3 N·m~2.5 N·m	0.3 N·m~2.0 N·m	1.5 N·m~4.4 N·m
扭矩设置档位	96档			
紧固扭矩精度*	±10%			
转速	1200转/分钟 (10档调节)	1200转/分钟 (10档调节)	1800转/分钟 (10档调节)	650转/分钟 (10档调节)

<测量条件> 按本公司规定的测量条件。

※因作业情况不同,紧固扭矩、紧固扭矩精度会发生变动。使用前,请务必通过实际作业进行确认。

※紧固扭矩精度并非扭矩换算值的精度。

※所在地区不供货的型号,请参阅最新总目录。

主体规格

电源	由电源适配器(另售件)供电 AC100-240 V 50/60 Hz		
电机	无刷电机(DC30 V)		
钻套	单触式钻头锁紧方式 适用钻头(对边6.35 mm六角柄、单头9 mm~13 mm、双头12 mm~17.5 mm)		
大小(大概尺寸)	全长:271 mm/握柄直径:φ 38 mm		
质量(重量)	约630 g		
开关方式	拉杆启动方式/按压启动方式 兼用(1台即可切换)		
无线通信标准	无线 LAN (IEEE.802.11 a/b/g/n)		
频带	2.412-2.472 GHz / 5.180-5.240 GHz		
通道数	2.4 GHz 频带:1ch-13ch / 5 GHz 频带:36、40、44、48ch		
输出信号(※1)	<ul style="list-style-type: none"> <li style="width: 33%;">• 紧固 OK <li style="width: 33%;">• 反转 <li style="width: 33%;">• 计数数量 <li style="width: 33%;">• 紧固 NG (NOK) <li style="width: 33%;">• 工具序列号 <li style="width: 33%;">• 累计驱动时间 <li style="width: 33%;">• 计数完成(计数完毕) <li style="width: 33%;">• 时间 <li style="width: 33%;">• 累计数量等 <li style="width: 33%;">• 时序完成 <li style="width: 33%;">• 旋转时间 <li style="width: 33%;">• 扭矩换算值 <li style="width: 33%;">• 正转 <li style="width: 33%;">• 旋转次数 <li style="width: 33%;">(仅 WA 型号) 		
输入信号(※1)	驱动许可信号		
操作面板(显示屏)	7段显示		
操作按钮	OK按钮/▼按钮/▲按钮		

通知(指示灯)	4色显示(判定指示灯)
通知(蜂鸣器)	音量3档
数量计数时的设置	<ul style="list-style-type: none"> • Count method • Count return • Count reset • Ignore judgement time • Ignore Count Time • Batch complete judgement waiting time
螺丝紧固合格与否判定	<ul style="list-style-type: none"> • 旋转时间的上限/下限设置 • 旋转次数的上限/下限设置 • 扭矩换算值的上限/下限设置(仅WA型号)
螺丝紧固支持	<ul style="list-style-type: none"> • Soft start • Soft snug • Disable fastening time
时序控制	可以(需在控制器端设置)
其他	<ul style="list-style-type: none"> • 可通过控制器管理用软件(另售产品)进行工具批量设置、数据管理、数据简易分析 • 未连接控制器时,可在“Stand Alone Mode”下使用
通用规格	<ul style="list-style-type: none"> • 旋转方向切换(正转/反转) • 制动器ON/OFF设置
配件	<ul style="list-style-type: none"> • 螺丝刀电源线(2 m) • 螺丝刀挂具 • 联轴器盖 • 握柄附件(仅EYADA407WA·WB标配)
另售件	<ul style="list-style-type: none"> • 螺丝刀电源线(2 m/3 m) • 螺丝刀挂具 • 联轴器盖 • 握柄附件 • 电源适配器(带电源线)

此处的规格可能会因性能提高而发生变化。

※1 控制器端的输入输出信号。

电源适配器规格

型号	EYSZP001
输入电压	AC100-240 V 50/60 Hz 2.6 A
输出电压	DC30 V 3 A
待机功率	0.16 W(100 V) 0.21 W(240 V) ※ 未连接螺丝刀主体的状态
质量(重量)	约590 g
大小(大概尺寸)	全长(长边)177 mm×全高(厚度)44 mm×全宽(短边)76 mm
配件	电源线1 m(带接地插头。可从电源适配器主体拆装)

无线通信注意事项

使用WLAN设备的注意事项

该设备的工作频带与其他类型的设备(包括工业、科研和医疗设备,如微波炉)和电台(如工厂生产线中用于移动识别的驻地电台(有证)和低功率电台(无证)以及业余电台(有证))使用的频带相同。

1. 使用该设备前,请确认附近没有正在工作的移动识别用驻地电台、低功率电台或业余电台。
2. 如果设备对移动识别用驻地电台造成有害干扰,请立刻停止使用该频带并向以下支持中心咨询解决干扰的方案(例如安装隔断)。
3. 如果设备对移动识别用驻地电台、低功率电台或业余电台造成有害干扰或存在类似其他问题,请咨询支持中心。

■ 以下环境条件下可能产生噪声、无线电覆盖范围缩短或故障。

- 存在阻碍电波在无线工具单元与控制器之间正常传播的障碍物(如金属物体、钢筋混凝土物体)。
- 控制器天线被金属覆盖。
- 操作人员的身体干扰操作器(无线工具单元)与控制器之间的无线电传播。
- 附近存在导致噪声的微波炉、PC或任何其他设备。
- 无线工具单元和控制器附近有人使用手机或个人手持电话。

维护、保管

维护

■ 用软布擦拭

从插座中拔出电源插头,然后从主体拆下螺丝刀电源线,用干燥的软布擦拭。

请勿使用湿布、稀释液、苯、酒精等挥发性物品。

(否则会造成变色、变形、开裂)



■ 实施定期检查

- 请定期检查螺丝是否存在松动、破损、动作异常等情况。
- 请定期检查电源适配器是否破损。

保管

■ 请避免以下条件进行保管

- 车内等高温场所
- 阳光直射的场所
- 有水和潮湿等的场所
- 垃圾和粉尘多的场所
- 儿童可以触及的场所
- 有汽油等易燃物的场所
- 有掉落危险的场所

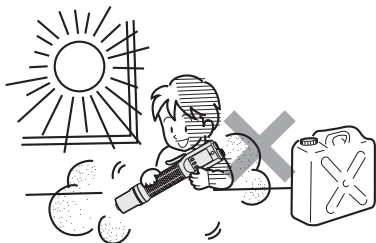

更新固件

请参见控制器(EYARW1)的使用说明书中记载的“更新固件”。

错误显示

主体错误显示

如有异常,主体的显示屏会闪烁错误标记。
请进行以下检查及处理。

- “E1”~“E9”:
按下OK按钮,错误显示消失。
- “EE”及“F2”~“Fb”:
按下OK按钮,或者通过操作开关,错误显示即会消失。

如果处理后仍有异常,请立即停止使用。
请将产品携至您所购买的销售店。

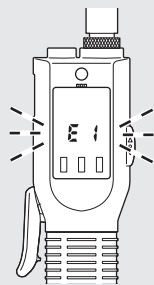

显示	可能的原因	处理
	主体内部的存储器或通信线异常等。	请先关闭电源,等待10秒后重新打开电源。 如无法恢复,请前往修理。
	主体发烫。	请中断作业,待温度下降后再使用。
	内部的保护传感器故障。	请前往修理。
	过载、电机故障等。	请消除发生过载的条件,重新进行确认。 如果仍未恢复,请前往修理。
	电源线类连接不正确。	请确认电源线类的连接情况以及是否存在断线。 如果电源线类未发现异常,则可能是电源适配器存在异常,请前往修理。

显示	可能的原因	处理
E7	主体电路发生异常、故障等。	请前往修理。
E9	<ul style="list-style-type: none"> • 未与控制器配对。 • 控制器解除了工具的配对。 	请与控制器配对。 WEB使用说明书 P. 28
	<ul style="list-style-type: none"> • 控制器与工具的距离过远。 • 与控制器之间有遮挡物。 	确认控制器与工具的距离。 确认工具或控制器的周边是否有遮挡物。 ※ 与控制器之间的建议通信距离(2.4 GHz时:约16 m, 5 GHz时:约10 m)以内
	<ul style="list-style-type: none"> • 未打开控制器电源。 • 控制器的安装场所、天线方向不正确。 	确认控制器的电源是否打开。 确认控制器的天线状态。 (参见控制器的使用说明书中的“安装注意事项”)
EE	未设置工具的紧固参数。	从控制器设置工具的紧固参数。 (参见控制器的使用说明书中的“设置工具的紧固参数”)



错误显示 (续)

显示	可能的原因	处理
	未设置坚固控制模式。	从控制器设置坚固控制模式。 (参见控制器的使用说明书中的“设置坚固控制模式”)
	控制器的动作模式设置为“Repeat mode (Basic mode)”,未注册批处理。	从控制器进行批处理注册。 (参见控制器的使用说明书中的“设置坚固控制模式”)
	控制器的动作模式设置为“Repeat mode (Sequence mode)”,处于依次等待中。	确认时序设置。 (参见控制器的使用说明书中的“设置坚固控制模式”)
	控制器的动作模式设置为“External control mode”,没有来自外部设备的控制指示。	确认控制器的I/O输入、外部设备(PLC等)。 (参见控制器的使用说明书中的“设置坚固控制模式”)
	工具的内部配线断线。	请前往修理。
	快速操作开关几次。	在接收到控制器的信号之前不要进行开关操作。 请稍后再操作。

■ 作业中发生时的错误显示

显示	可能的原因	处理
F2	在紧固作业中,联轴器运转之前主体停止。	这并非产品异常。 请让主体动作,直至联轴器运转。
F3	在紧固作业中,超过了旋转时间的上限、下限值范围。	这并非产品异常。 请确认工件及旋转时间的设定值。 WEB 使用说明书 P. 36
F4	在紧固作业中,旋转次数超过上限、下限值的范围。	这并非产品异常。 请确认工件以及旋转次数的设定值。 WEB 使用说明书 P. 35
F5	在紧固作业中,扭矩换算值超过上限、下限值的范围。	这并非产品异常。 请确认工件以及扭矩换算值的设定值。 WEB 使用说明书 P. 33
F6	在紧固作业中更改正/反转扳手。	请勿在紧固作业中操作正/反转扳手。
F8	在紧固作业中,发生过载、电机故障。	请消除发生过载的条件,重新进行确认。 如果仍未恢复,请前往修理。

错误显示 (续)

显示	可能的原因	处理
	在紧固作业中,电源线类发生连接不良。	请确认电源线类的连接情况以及是否存在断线。 如果电源线类未发现异常,则可能是电源适配器存在异常,请前往修理。
	在紧固作业中,内部保护传感器发生故障。	请前往修理。
	在紧固作业中,主体发烫。	请中断作业,待温度下降后再使用。

紧固履历的错误信息

可通过web浏览器访问控制器,从作业履历画面确认紧固履历。 **WEB使用说明书 P.46**

	NOK信息	错误消息	原因	措施
1	Error	High temperature	<ul style="list-style-type: none"> 工具达到高温,保护停止 	<ul style="list-style-type: none"> 冷却后再使用 (注意不要产生结露) <连续异常时> 重新评估作业环境 确认材料条件 重新评估电源适配器
2	Error	Motor sensor error	<ul style="list-style-type: none"> 工具的温度传感器或电流传感器检测到异常 	<ul style="list-style-type: none"> 频发确认 - 如果频发,请前往修理(电路故障)
3	Error	Tool locked	<ul style="list-style-type: none"> 工具的电机不旋转,保护停止 - 作业环境所致 - 主体所致 	<ul style="list-style-type: none"> 重新评估作业环境 (有无异常负荷、作业人员的工具使用方法)
4	Error	Low voltage	<ul style="list-style-type: none"> 在电源周围检测到异常电压,保护停止 - 作业环境所致 - 电源适配器或主体所致 	<ul style="list-style-type: none"> 重新评估电源适配器 保养端子部(确认灰尘附着、端子磨损) 频发确认 - 如果频发,请前往修理
5	Error	Overcurrent	<ul style="list-style-type: none"> 工具检测到异常电流,保护停止 - 作业环境所致 - 主体所致 	<ul style="list-style-type: none"> 重新评估作业环境 (有无异常负荷、作业人员的工具使用方法)

错误显示 (续)

	NOK 信息	错误消息	原因	措施
6	Error	Rotation direction changed	<ul style="list-style-type: none"> 在作业中,正/反转扳手设置变化,保护停止 	<ul style="list-style-type: none"> 重新评估作业环境 (作业人员的工具使用方法)
7	Error	Parameter error	<ul style="list-style-type: none"> 参数不在设置范围内 	<ul style="list-style-type: none"> 确认参数设置 重新设置参数
8	Torque	Torque exceeded	<ul style="list-style-type: none"> 紧固时的扭矩换算值超过上限扭矩换算值设置 	<ul style="list-style-type: none"> 确认设置内容 重新评估构件条件 禁用上限扭矩换算值设置
9	Torque	Torque insufficient	<ul style="list-style-type: none"> 紧固时的扭矩换算值低于下限扭矩换算值设置 	<ul style="list-style-type: none"> 确认设置内容 重新评估材料条件 禁用下限扭矩换算值设置
10	Rotation count	Rotation count exceeded	<ul style="list-style-type: none"> 紧固时的工具前端部旋转次数超过上限旋转次数设置 	<ul style="list-style-type: none"> 确认设置内容 重新评估材料条件 禁用上限旋转次数设置
11	Rotation count	Rotation count insufficient	<ul style="list-style-type: none"> 紧固时的工具前端部旋转次数低于下限旋转次数设置 	<ul style="list-style-type: none"> 确认设置内容 重新评估材料条件 禁用下限旋转次数设置
12	Rotation time	Rotation time exceeded	<ul style="list-style-type: none"> 紧固时的工具前端部旋转时间超过上限旋转时间设置 	<ul style="list-style-type: none"> 确认设置内容 重新评估材料条件 禁用上限旋转时间设置

	NOK 信息	错误消息	原因	措施
13	Rotation time	Rotation time insufficient	<ul style="list-style-type: none"> • 紧固时的工具前端部旋转时间低于上限旋转时间设置 	<ul style="list-style-type: none"> • 确认设置内容 • 重新评估材料条件 • 禁用下限旋转时间设置
14	Clutch	Stop before clutch actuation	<ul style="list-style-type: none"> • 联轴器运转前紧固结束 <ul style="list-style-type: none"> - 紧固时, 在联轴器运转之前停止了主体 - 紧固时, 因其他 NOK 停止 	<p>< 在联轴器运转之前停止了主体时 ></p> <ul style="list-style-type: none"> • 重新评估作业环境 • 确认材料条件 <p>< 显示为其他紧固 NOK 时 ></p> <ul style="list-style-type: none"> • 确认紧固 NOK 内容后处理

许可规定

■ 软件许可条款

本产品包含以下类型软件。

- (1) 松下公司 (Panasonic) 独立开发的软件
- (2) 第三方持有并授权 Panasonic 使用的软件
- (3) 开源软件

以上第 (3) 类软件的分发预计将独立使用;但本公司对此不提供任何形式的担保,包括针对“适销性”或“特殊用途适切性”的隐式担保。

请参见从以下网址获取的说明书中给出的详细条款 & 条件和版权事项。



<https://panasonic.net/electricworks/ecm/powerelctrictools/download/>

产品中有害物质的名称及含量

部件名称	有毒有害物质或元素					
	铅(Pb)	汞(Hg)	镉(Cd)	6价铬 (Cr(VI))	多溴联苯 (PBB)	多溴二苯醚 (PBDE)
外壳	○	○	○	○	○	○
回路基板	×	○	○	○	○	○
马达	○	○	○	○	○	○
其他付属品	○	○	○	○	○	○
机构部	○	○	○	○	○	○

本表格依据 SJ/T11364 的规定编制。

○:表示该有害物质在该部件所有均质材料中的含量均在GB/T 26572规定的限量要求以下。

×:表示该有害物质至少在该部件的某一均质材料中的含量超出GB/T 26572规定的限量要求。

执行标准	电动工具: GB/T 3883.1-2014, GB/T 3883.202-2019 GB 4343.1-2018, GB 17625.1-2012
	电源适配器: GB 4943.1-2022, GB/T 9254.1-2021, GB 17625.1-2012

- (一) 符合“微功率短距离无线电发射设备目录和技术要求”的具体条款和使用场景,采用的天线类型和性能,控制、调整及开关等使用方法;
- (二) 不得擅自改变使用场景或使用条件、扩大发射频率范围、加大发射功率(包括额外加装射频功率放大器),不得擅自更改发射天线;
- (三) 不得对其他合法的无线电台(站)产生有害干扰,也不得提出免受有害干扰保护;
- (四) 应当承受辐射射频能量的工业、科学及医疗(ISM)应用设备的干扰或其他合法的无线电台(站)干扰;
- (五) 如对其他合法的无线电台(站)产生有害干扰时,应立即停止使用,并采取措施消除干扰后方可继续使用;
- (六) 在航空器内和依据法律法规、国家有关规定、标准划设的射电天文台、气象雷达站、卫星地球站(含测控、测距、接收、导航站)等军民用无线电台(站)、机场等的电磁环境保护区域内使用微功率设备,应当遵守电磁环境保护及相关行业主管部门的规定;
- (七) 禁止在以机场跑道中心点为圆心、半径 5000 米的区域内使用各类模型遥控器;
- (八) 微功率设备使用时温度和电压的环境条件。

■ CMIIT ID表显示位置

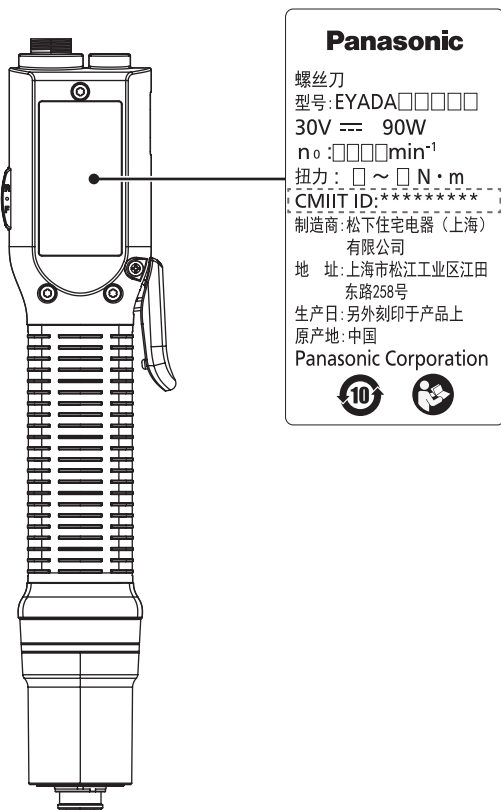

■ 无线功能作用:

在工具和控制器间进行无线通信的配对及数据双向通信(工具的设置信息、紧固作业结果等)

Operating Instructions (Simplified version)

Electric Screwdriver

Model No.: EYADA Series
Model No. WA
Model No. WB

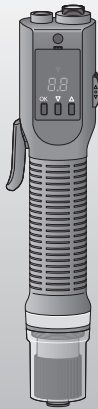

IMPORTANT

Read and follow the safety and operating instructions before using this product.
Do not use the wireless function outside the country where you purchased the product.
Doing so may violate the local laws and regulations.
In your area, including models that are not on sale.
Please refer to the latest general catalogue.

Original instructions: English
Translation of the original instructions:
Other languages

Table of Contents

FEATURES OF PRODUCT.....	2	BEFORE USE
SAFETY PRECAUTIONS	4	
NAMES OF PARTS		
SYSTEM CONFIGURATION		
RUNNING MODE		
GUIDE TO SETUP PROCEDURES		

PREPARATION BEFORE USE ..	10	PREPARATION
---------------------------	----	-------------

HOW TO USE		OPERATION
PAIRING WITH THE CONTROLLER		
SETTING VIA A WEB BROWSER		
SETTING ON THE TOOL		

CAPACITY AND SPECIFICATIONS	14	OTHERS
PRECAUTIONS FOR WIRELESS COMMUNICATION	16	
CLEANING AND STORAGE	17	
ERROR CODES.....	18	
INDEX		
LICENCE TERMS	26	

The dimmed contents are out of the scope of this simple operating instructions.
To read all contents of explanation about the product, access the operating instructions (download version) available as electronic data.

For full version Operating Instructions, please refer to the web site.
<https://panasonic.net/electricworks/ecm/powerelctrictools/download/>



FEATURES OF PRODUCT

This unit is a compact and easy-to-grip Electric Screwdriver equipped with a brushless motor.

It handles well and is very easy to maintain because there is no need to replace a brush, thereby providing a comfortable working experience.

* Connecting tools to the controller allows collective setting of functions.
(Be sure to connect them to the controller before starting collective setting)

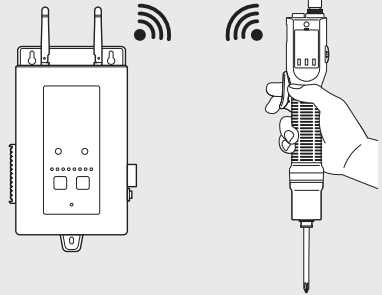

■ To prevent leaving screws unfastened **Web Manual P. 40**

Set the number of screws to fasten.

■ To check the fastening status **Web Manual P. 26**

Set the detection lamp.

■ To perform fastening quality judgement **Web Manual P. 33 to 36**

Set the upper and lower limits of parameters.

■ To select lever start or push start

Web Manual P. 21

Set the start mode.

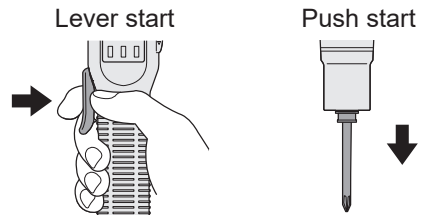

■ To prevent tool mix-ups

Set the order of using tools.

* Refer to "SETTING THE FASTENING CONTROL MODE" in the Operating Instructions of the controller (EYARW1).

■ To check or save the fastening data

Check the fastening history data via a web browser on a PC.

Use the separately sold Controller Management Software to automate collection of the fastening history data and conduct simple data analysis.

■ To check or save the fastening torque values **Web Manual P. 33**

Save the converted torque. You need to set an offset. (Model No. WA only)

■ Support functions helpful for screw fastening

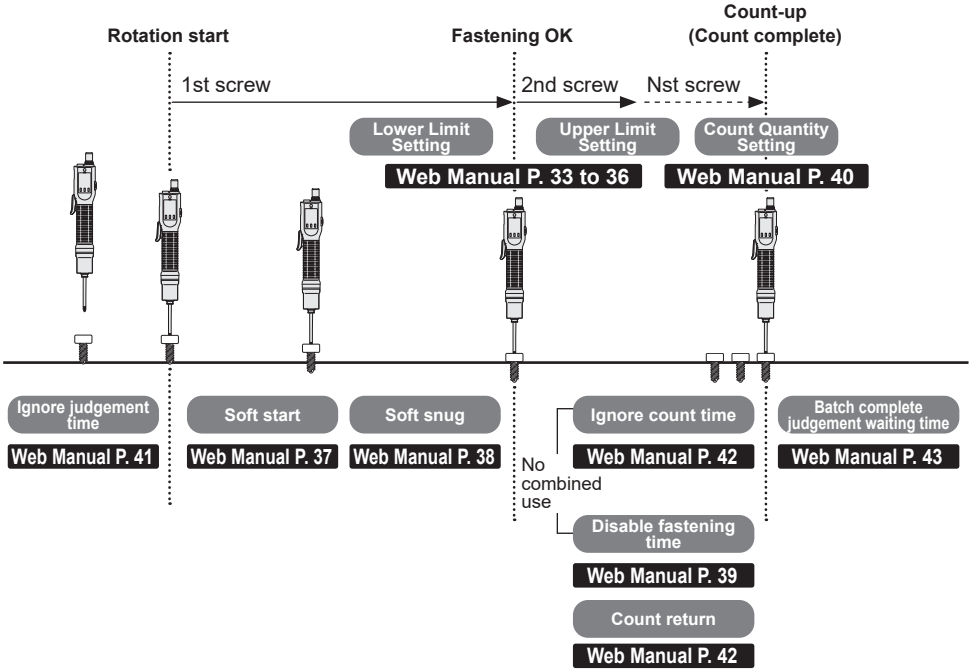



Task	Support function	Reference page
Ignore unexpected momentary rotations when performing judgement.	Ignore judgement time	Web Manual 41
Slow the rotation rate at the start (to prevent galling, etc.).	Soft start	Web Manual 37
Slow the rotation rate before snugging (to minimise an impact, etc.).	Soft snug	Web Manual 38
Prevent counting refastenings (during a specific period).	Ignore count time	Web Manual 42
Prevent refastenings (during a specific period).	Disable fastening time	Web Manual 39
Set how to count reverse rotations.	Count return	Web Manual 42
Set how reverse rotations should be treated after the last screw is fastened.	Batch complete judgement waiting time	Web Manual 43

SAFETY PRECAUTIONS



Always adhere to the instructions



Below are the instructions you should always adhere to, to prevent human harm and property damage.

■ The severity of harm and damage caused by incorrect use is presented with the following.

 WARNING	May cause death or serious injury.
 CAUTION	May cause minor injury or property damage.

■ The content that should be observed is presented with the following symbols. (The following are examples)

 You MUST NOT do the action.
 You MUST do the action.

 WARNING	
 Mandatory	<ul style="list-style-type: none">● Perform daily management of torque. Failure to observe this may cause loose screws due to torque fluctuations, resulting in an accident.
	<ul style="list-style-type: none">● When interrupting work or when not using the tool, ensure that it is not operating.● When replacing a bit or accessories, or when storing the tool, always set the forward/reverse lever to the trigger switch lock position, and disconnect the power cord. Failure to observe this may cause unexpected operation, resulting in an accident.
	<ul style="list-style-type: none">● Hold the tool securely to avoid being swung around during use. Failure to observe this may cause injury.
	<ul style="list-style-type: none">● Wear ear protectors such as earplugs or earmuffs in noisy work environments. Failure to observe this may adversely affect hearing.
	<ul style="list-style-type: none">● Use protective glasses during work. Failure to observe this may cause injury to the eyes or throat.
	<ul style="list-style-type: none">● Insert the power plug all the way seated. Incomplete insertion may cause electric shock or heat generation resulting in fire. Do not use a damaged plug or loose socket.

WARNING

● **Clean dust off the power plug routinely.**

Accumulated dust on the plug may absorb moisture and cause poor insulation resulting in fire.

Disconnect the power plug and wipe it with dry cloth.

● **Use the specified accessories and attachments.**

Failure to observe this may cause injury.

● **Keep the workplace sufficiently bright.**

Poor visibility in a dark workplace may lead to an accident or injury.

● **Fix the workpiece firmly.**

Failure to observe this may cause unexpected movement, resulting in injury. For safety, use clamps or vices for fixing it.

● **If the tool malfunctions or makes abnormal noises during use, immediately turn off the trigger switch and stop using it.**

Consult your dealer or Panasonic Customer Support Centre. Using it as is may result in injury.

● **Following the Operating Instructions, attach a bit or other pointed tools, and accessories securely.**

Failure to securely attach them may cause detachment, resulting in injury.

● **Before use, remove a key, wrench, and other tools used for adjustment.**

Failure to observe this may cause unexpected detachment, resulting in injury.

● **Work in proper attire.**

- Do not wear baggy clothing or accessories such as a necklace, because they may get caught in rotating parts.
- When working outdoors, you are recommended to use footwear with non-slip soles.
- Cover long hair with a cap or a hair cover.

● **When working at heights, thoroughly check that there are no people below and use wires or others to prevent the tool from falling.**

Otherwise someone may be injured if the tool falls.

● **Use only the screwdriver cord, power adapter, and power cord designed specifically for our screwdrivers.**

Failure to observe this may cause an accident or injury.



Mandatory

WARNING

- **Do not use a socket or wiring device in the manner of exceeding the rated value. Use only within electrical rated range.**

Exceeding the rated value due to an overloaded socket may cause heat generation resulting in fire.

- **Do not damage the screwdriver cord, power cord, or power plug. (Avoid damaging, breaking, modifying, putting close to a heat source, bending with force, twisting, pulling, putting a heavy load on it, pinching, or binding.)**

Using the damaged cord or plug may result in electric shock, short circuit, or fire.

Check the cord and plug periodically and if any damage, consult your dealer.

- **When smoke is emitted from the tool, do not inhale the smoke.**

It may be harmful to your body.

- **Immediately after work, do not touch a bit or other pointed tools, screws, or chips.**

They are hot and may cause burns.

- **Do not use the tool for any other purpose than intended.**

Failure to observe this may cause injury.

- **Do not use the tool with oil or other foreign material attached to it.**

Otherwise an accident may occur if the tool falls.

Also, such oil or other foreign material may enter the inside, resulting in generation of heat, fire, or burst.

- **While using a bit or other rotating parts, keep your body or a part of your body away from the rotating parts or chips.**

You may be injured when an unexpectedly detached or damaged bit or chips hit you. Replace a bit or other pointed tools periodically.

- **Do not use the screwdriver cord, power adapter, or power cord designed specifically for our screwdrivers to operate other devices.**

Failure to observe this may cause an accident or injury.

- **Do not use the tool in an environment where asbestos exists nearby (including an environment where asbestos is being removed).**





Doing so may adversely affect health.

Great care should be given to asbestos, because this substance causes lung cancer or other serious health damage.



Prohibited

WARNING

 Prohibited	<ul style="list-style-type: none">● Disconnect the power plug between uses. Failure to observe this may cause poor insulation resulting in electric shock or fire from electric leakage.
 No touching	<ul style="list-style-type: none">● If it is thundering, do not touch this unit or the power plug. Failure to observe this may result in electric shock.
 No disassembly	<ul style="list-style-type: none">● Do not modify the tool. Do not disassemble or repair the tool. Doing so may cause fire, electric shock, or injury. For repair, consult your dealer or our customer support team.
 Keep dry	<p>Avoid the following use of tools.</p> <ul style="list-style-type: none">● Do not use or leave them exposed to rain or moisture.● Do not use them immersed under water. Failure to observe this may cause smoke, fire, or burst.
 No wet hand	<ul style="list-style-type: none">● Do not use a wet hand to connect or disconnect the power plug to or from the outlet. Failure to observe this may cause electric shock.

CAUTION



Mandatory

- **If the tool becomes hot, interrupt the work and wait for it to cool down before use.**
Failure to observe this may cause burns.
- **To disconnect the power plug, always hold the power plug without pulling the cord.**
Pulling the cord may cause electric shock or short circuit.
- **Before use, check the tool, pointed tool, and other parts for any damage and confirm their normal operation.**
Failure to observe this may cause damage, resulting in injury.
- **Keep the workplace clean.**
A disordered workplace or work table may lead to an accident.
- **Consider well how to handle and work, pay attention to the surrounding environment, and use common sense during work.**
Failure to observe this may cause an accident or injury.
- **When installing the power adapter on a wall, securely screw it to prevent it from falling.**
Otherwise, the power adapter may fall, injuring someone.



Prohibited

- **Do not put the tool in a place accessible by a child.**
Failure to observe this may cause an accident or trouble.
- **Do not store the main body in a place where the temperature may rise to 50 °C or higher.**
Failure to observe this may lead to abnormal operation.
- **Do not use the tool in such a forceful manner that causes the motor to lock.**
Failure to observe this may cause smoke or fire.
In order to work safely and efficiently, work at a speed that matches the ability.

CAUTION



Prohibited

- **Do not work in an unusual position.**
Otherwise you may fall over and be injured.
Always stand on a stable footing and keep a good balance.
- **Do not use the tool when you are tired.**
Failure to observe this may cause an accident or injury.
- **Do not allow a child or any other person who is not an operator to come near the workplace or touch the tool.**
Doing so may cause injury.
- **Do not hold only the cord to carry the tool.**
Doing so may cause the tool to fall, resulting in injury.

PREPARATION BEFORE USE

Using Forward/Reverse Lever

With the forward/reverse lever, you can change the rotation direction of the Electric Screwdriver or lock the start.

Trigger switch position	Rotation direction
R	Reverse (Anticlockwise)
○	Trigger switch locked
F	Forward (Clockwise)

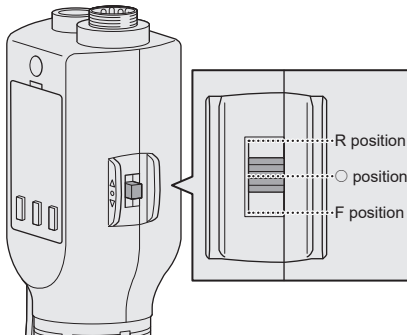

Trigger switch lock

When you switch the forward/reverse lever to the “○” position, the start of the Electric Screwdriver is locked and it does not rotate.

When attaching accessories or a bit, or when not working, switch the forward/reverse lever to the “○” position to lock the trigger switch.

NOTE

- If the forward/reverse lever is switched while the motor is in action, the motor is forcibly stopped to rotate.

1 Pull the screwdriver hanger lightly on both sides.

Pulling the screwdriver hanger hard may prevent it from returning to its original position.

Perform attachment and removal with necessary force.

2 Put it into the screwdriver hanger mounting hole.

Screwdriver hanger mounting hole

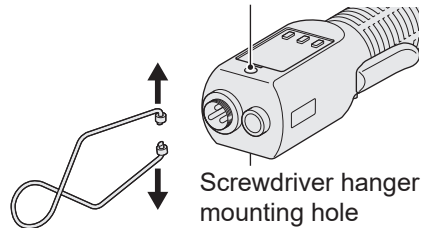

Pull the screwdriver hanger lightly on both sides.

Attach the screwdriver hanger and the tool balancer as shown in the figure.

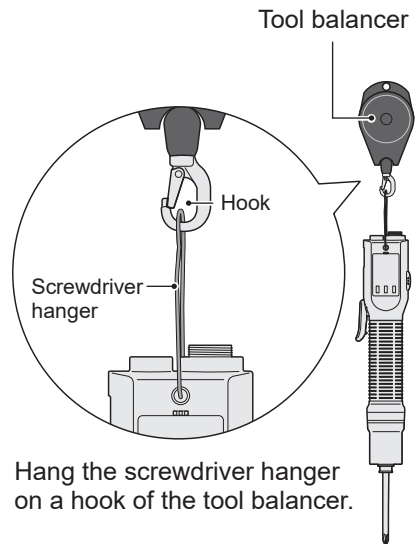

Hang the screwdriver hanger on a hook of the tool balancer.

Attaching Bit

ATTENTION

- When attaching or removing a bit, set the forward/reverse lever to the "○ (Trigger switch locked)" position, and turn OFF the power switch of the power adapter. **P. 10, 13**

1 Pull the bit holder.

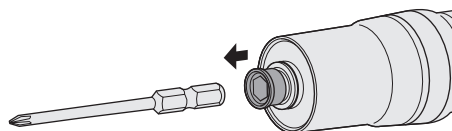

2 Insert a bit.

Insert it with the bit holder pulled.

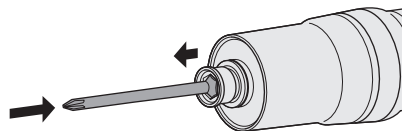

3 Release the bit holder.

Check that the bit does not come off, by pulling it lightly.

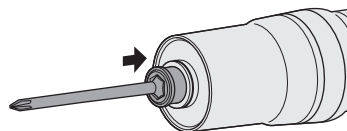

Bits That Can Be Attached to This Unit

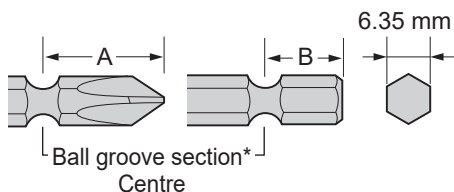

* Straight bits without a ball groove section cannot be used.

Length of A (Double-ended bit)	12 mm to 17.5 mm
Length of B (Single-ended bit)	9 mm to 13 mm

Removing Bit

ATTENTION

- Immediately after work, do not touch a bit or other pointed tools, or screws. They are hot and may cause burns.

1 Pull the bit holder.

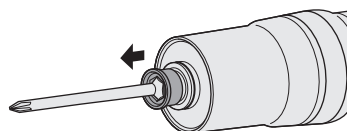

2 Remove the bit.

Pull it out with the bit holder pulled.

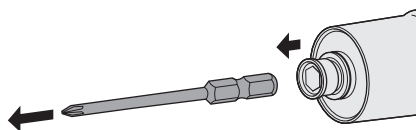

PREPARATION BEFORE USE (cont.)

Attaching Grip Attachment

The grip attachment can be attached to all models.

(Supplied for EYADA407WA·WB only)

It can absorb the reactive force during clutch activation, which helps reduce fatigue.

Use in lever start mode

Align grooves in the grip attachment with ribs on the grip.

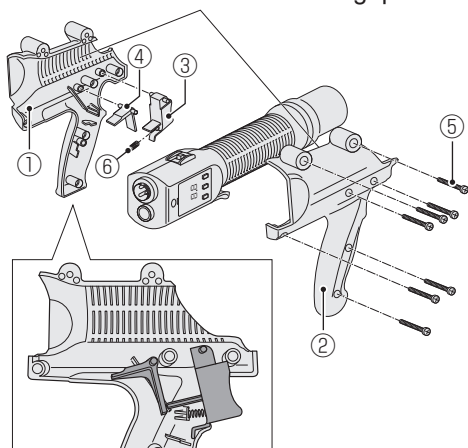

Use in push start mode

Align grooves in the grip attachment with ribs on the grip.

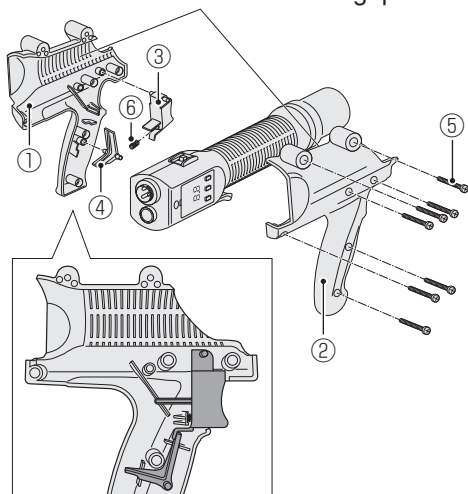

Components of the attachment

①	Grip attachment (A) × 1
②	Grip attachment (B) × 1
③	Trigger × 1
④	Joint × 1
⑤	Screw × 7
⑥	Spring × 1

ATTENTION

- When attaching or removing the grip attachment, set the forward/reverse lever to the “○ (Trigger switch locked)” position, and turn OFF the power switch of the power adapter.
P. 10, 13
- Remove the bit before attaching or removing the grip attachment.
- After fixing the grip attachment with screws, check for any loose screws, backlash, or misalignment.

- 1** Align grooves in the grip attachment (A) with ribs on the tool grip.
- 2** Attach the trigger and the joint to the positions shown in the figure.
- 3** Align grooves in the grip attachment (B) with ribs on the tool grip.
- 4** Fasten the screws.
Check for any loose screws, backlash, or misalignment.

Screwdriver hanger mounting hole (x 2)

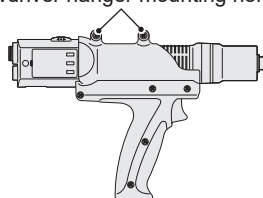

Connecting to Power Supply

ATTENTION

- Before connection, set the forward/reverse lever to the “○” position to lock the trigger switch. **P. 10**
- Use only our power supply (screwdriver cord, power adapter, and power cord). Also, do not use the power supply or cord designed specifically to this unit to operate other devices.
- When not using the tool for a long time, you are recommended to disconnect the power cord from the outlet. This unit consumes power even while it is turned off.

1 Connect the screwdriver cord to the power adapter and this unit.

Check the orientation of the connector and attach it correctly. Fix it with a joint ring.

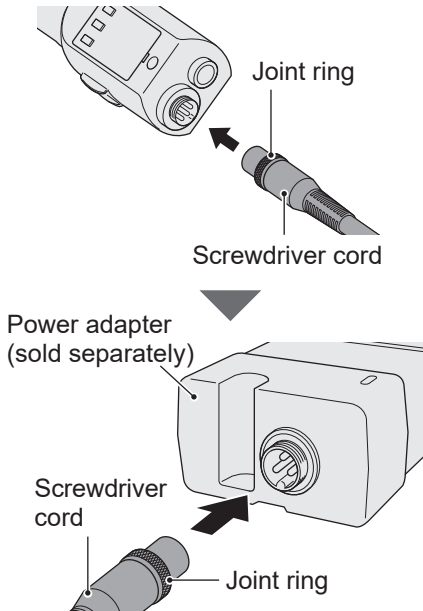

2 Attach the power cord to the power adapter.

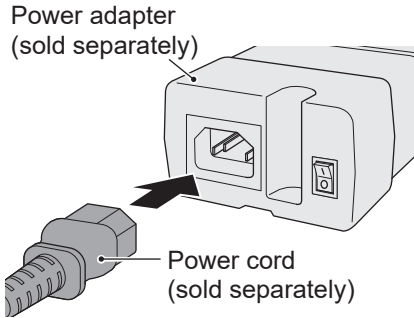

3 Check that the power switch of the power adapter is OFF.

When the power supply is OFF, the power lamp is off.

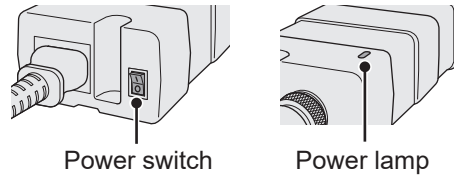

4 Connect the power plug to the outlet.

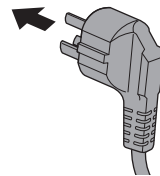

Example: For China

5 Turn ON the power switch of the power adapter.

The power lamp lights up green.

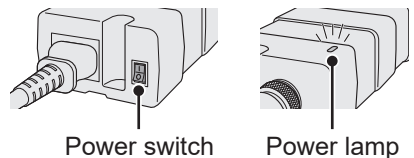

CAPACITY AND SPECIFICATIONS

Tool Capacity

Model No.	EYADA112WA EYADA112WB	EYADA212WA EYADA212WB	EYADA218WA EYADA218WB	EYADA407WA EYADA407WB
Recommended Work	Machine screw: M2 to M3.5	Machine screw: M2.5 to M4.5	Machine screw: M2.5 to M4	Machine screw: M3.5 to M5
Torque Setting Range	0.1 N·m to 1.0 N·m	0.3 N·m to 2.5 N·m	0.3 N·m to 2.0 N·m	1.5 N·m to 4.4 N·m
Torque Setting Steps	96 steps			
Fastening Torque Accuracy*	±10%			
Speed	1200 revolutions per minute (10-step adjustment)	1200 revolutions per minute (10-step adjustment)	1800 revolutions per minute (10-step adjustment)	650 revolutions per minute (10-step adjustment)

<Measurement conditions>

Based on our specified measurement conditions.

* Fastening torque and fastening torque accuracy vary depending on the work status. Be sure to check them with actual work before use.

* The accuracy of fastening torque is not the accuracy of converted torque.

* In your area, including models that are not on sale. Please refer to the latest general catalogue.

Tool Specifications

Power Supply	Power supplied by power adapter (sold separately) 100 to 240 V AC 50/60 Hz		
Motor	Brushless motor (30 V DC)		
Bit Holder	One-touch bit locking mechanism Applicable bits (hex shank of 6.35 mm across flats, single-ended 9 mm to 13 mm, double-ended 12 mm to 17.5 mm)		
Size (Estimated Dimensions)	Overall Length: 271 mm / Grip diameter: ϕ 38 mm		
Mass (Weight)	About 630 g		
Trigger Switch Mode	Both lever start mode and push start mode available (Switchable on a single unit)		
Wireless Communication Standard	Wireless LAN (IEEE802.11a/b/g/n)		
Frequency Band	2.412-2.472 GHz / 5.180-5.240 GHz		
Number of channels	2.4 GHz: 1 to 13 channels / 5 GHz: 36, 40, 44, 48 channels		
Output Signals* ¹	<ul style="list-style-type: none"> • Fastening OK • Fastening NG (NOK) • Count-up (Count complete) • Sequence complete • Forward 	<ul style="list-style-type: none"> • Reverse • Serial numbers of tools • Time • Rotation time • Rotation (times) 	<ul style="list-style-type: none"> • Count quantity • Accumulated driving time • Accumulated quantity, etc. • Converted torque (Model No. WA only)
Input Signals* ¹	Drive permission signal		
Operation Panel (Display)	7-segment display		
Operation Button	OK button / ▼ button / ▲ button		

Notification (Lamp)	4-colour display (Detection lamp)
Notification (Buzzer)	3 steps of volume
Settings for Quantity Count	<ul style="list-style-type: none"> • Count method • Count return • Count reset • Ignore judgement time • Ignore Count Time • Batch complete judgement waiting time
Screw Fastening Quality Determination	<ul style="list-style-type: none"> • Rotation time upper/lower limit setting • Rotation (times) upper/lower limit setting Converted torque upper/lower limit setting (Model No. WA only)
Screw Fastening Support	<ul style="list-style-type: none"> • Soft start • Soft snug • Disable fastening time
Sequence Control	Possible (Setting required on the controller side).
Others	<ul style="list-style-type: none"> • Collective setting of tools, data management, and simple data analysis is possible with the Controller Management Software (sold separately) • Able to run in the "Stand Alone Mode" when not connected to the controller.
Common Specifications	<ul style="list-style-type: none"> • Rotation direction switching (Forward/Reverse) • Braking ON/OFF setting
Included Items	<ul style="list-style-type: none"> • Screwdriver cord (2 m) • Screwdriver hanger • Clutch cover • Grip attachment (Supplied for EYADA407WA·WB only)
Separately Sold Items	<ul style="list-style-type: none"> • Screwdriver cord (2 m/3 m) • Screwdriver hanger • Clutch cover • Grip attachment • Power adapter (with a power cord)

These specifications are subject to change for performance improvement.

*1 Input/output signals on the controller side.

Power Adapter Specifications

Model No.	EYSZP001
Input Voltage	100 - 240 V AC, 50/60 Hz 2.6 A
Output Voltage	30 V DC, 3 A
Standby Power	0.16 W (100 V) 0.21 W (240 V) * When the screwdriver itself is not connected
Mass (Weight)	About 590 g
Size (Estimated Dimensions)	Overall Length (Long Side) 177 mm × Overall Height (Thickness) 44 mm × Overall Width (Short Side) 76 mm
Included Items	Power cord 1 m (With grounding plug. Detachable from power adapter itself)

Cautions for using a WLAN device

The device uses a frequency band shared with other types of equipment including industrial, scientific, and medical devices (e.g., a microwave) and radio stations such as a premises radio station (licenced) and low-power radio station (unlicenced) for mobile identification used in factory manufacturing lines and an amateur radio station (licenced).

1. Before using the device, confirm that there is no premises or low-power radio station for mobile identification or no amateur radio station operating in the vicinity.
2. If the device causes harmful interference with a premises radio station for mobile identification, stop use of the band immediately and consult the support centre below for the solution of the interference problem (e.g., installing a partition).
3. If the device causes harmful interference with a premises or low-power radio station for mobile identification or an amateur radio station or such other problems, consult the support centre.

■ There may be noise, shorter radio coverage, or malfunction occurring in the following environmental conditions.

- There is an obstruction (e.g., a metal or reinforced concrete object) that prevents smooth radio propagation between the wireless-enabled tool unit and the controller.
- The antennas of the controller are covered with metal.
- An operator's body is interfering with radio propagation between an operator (the wireless-enabled tool unit) and the controller.
- There is a microwave, PC, or any other device causing noise in the vicinity.
- A cell-phone or PHS phone is used near the wireless-enabled tool unit and the controller.

CLEANING AND STORAGE

Cleaning

■ Wiping with Soft Cloth

Disconnect the power plug from the outlet, remove the screwdriver cord from the tool, and then wipe it with dry soft cloth.

Do not use wet cloth, thinner, benzene, alcohol, or other volatile liquids.
(Cause of discolouration, deformation, or crack)

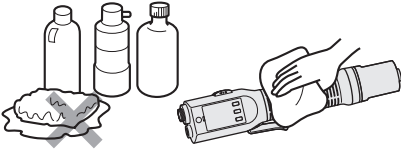

■ Conducting Periodic Inspection

- Periodically inspect for any loose screws, damage, or abnormal operation.
- Periodically inspect the power adapter for any signs of damage.

Storage

■ Avoid the following conditions during storage.

- Car cabin or other hot places
- Places exposed to direct sunlight
- Places exposed to water or dampness
- Places with a lot of foreign bodies or dust
- Places within reach of children
- Places with gasoline or other flammables
- Places with risk of fall

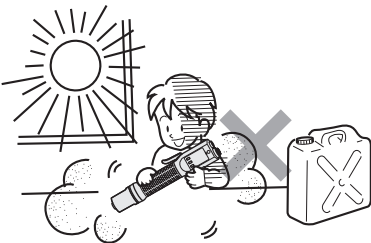

Updating the Firmware

Refer to “Updating the Firmware” in the Operating Instructions of the controller (EYARW1).

ERROR CODES

Error Display on the Tool

If there is any problem, an error code blinks on the display of the tool.



Consult the table below and take a necessary action.

- [E1] to [E9]
Pressing the OK button will clear the error display.
- [EE] and [F2] to [Fb]:
Press the OK button. Or pressing a switch will clear the error display.

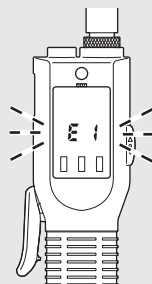
If the problem persists, stop the use immediately.
Bring it to your dealer.



Display	Possible cause	Action
E 1	An error occurred in the tool's internal memory or the communication line.	Turn the power off and wait approximately 10 seconds before turning it on again. When this does not eliminate the problem, send the tool for repair.
E 3	The tool is hot.	Interrupt the work and wait for it to cool down before use.
E 4	The internal protective sensor is out of order.	Send the tool for repair.
E 5	The tool is overloaded or the motor is out of order, for example.	Eliminate the condition(s) that caused the overload and recheck the condition. When this does not eliminate the problem, send the tool for repair.
E 6	A cord or cords are not correctly connected.	Check whether the cords are correctly connected and whether no cords are broken. When no abnormality is found in the cords, the power adapter may be failed. Send the tool for repair.

Display	Possible cause	Action
	<p>The tool circuit is failed or out of order, for example.</p>	<p>Send the tool for repair.</p>
	<ul style="list-style-type: none"> • The tool is not yet paired with the controller. • The controller unpaired the tool. 	<p>Pair the tool with the controller. Web Manual P. 28</p>
	<ul style="list-style-type: none"> • The controller is too far from the tool. • There is an obstacle between the tool and the controller. 	<p>Check the distance between the controller and the tool. Check for any obstacle around the tool and the controller. * Within the recommended distance between the tool and the controller (approximately 16 m for 2.4 GHz and 10 m for 5 GHz)</p>
	<ul style="list-style-type: none"> • The controller is powered off. • The installation place or antenna direction of the controller is inappropriate. 	<p>Check if the controller is powered on. Check the status of the controller's antenna. (Refer to "Cautions for Installation" in the Operating Instructions of the controller.)</p>
	<p>An error or failure occurred in the tool or the controller.</p> <p>Fastening parameters are not yet set for the tool.</p>	<p>Turn the power off and then on. (When this does not eliminate the problem, send the tool for repair.)</p> <p>On the controller, set fastening parameters for the tool. (Refer to "SETTING FASTENING PARAMETERS OF TOOLS" in the Operating Instructions of the controller.)</p>



ERROR CODES (cont.)

Display	Possible cause	Action
	<p>▶ The fastening control mode is not yet set.</p>	<p>On the controller, set the fastening control mode. (Refer to “SETTING THE FASTENING CONTROL MODE” in the Operating Instructions of the controller.)</p>
	<p>▶ The running mode is set to “Repeat mode (Basic mode)” on the controller and a batch is not yet registered.</p>	<p>On the controller, register a batch. (Refer to “SETTING THE FASTENING CONTROL MODE” in the Operating Instructions of the controller.)</p>
	<p>▶ The running mode is set to “Repeat mode (Sequence mode)” on the controller and the tool is in a queue.</p>	<p>Check the sequence setting. (Refer to “SETTING THE FASTENING CONTROL MODE” in the Operating Instructions of the controller.)</p>
	<p>▶ The running mode is set to “External control mode” on the controller and the tool has not received a control input from the external device.</p>	<p>Check the I/O input on the controller and the external device (PLC, etc.). (Refer to “SETTING THE FASTENING CONTROL MODE” in the Operating Instructions of the controller.)</p>
	<p>▶ The tool’s internal wiring is broken.</p>	<p>Send the tool for repair.</p>
	<p>▶ A switch was operated quickly several times.</p>	<p>A switch was operated before the reception of the signal from the controller. Wait a moment before operation.</p>

■ Error codes for errors that occur during work.

Display	Possible cause	Action
F 2	During a fastening process, the tool was stopped before the clutch activated.	Nothing is wrong with the product. Keep the tool in action until the clutch activates.
F 3	During a fastening process, the rotation time has become higher than the upper limit or lower than the lower limit.	Nothing is wrong with the product. Check the workpiece and the setting for the rotation time. Web Manual P. 36
F 4	During a fastening process, the number of rotations has become higher than the upper limit or lower than the lower limit.	Nothing is wrong with the product. Check the workpiece and the rotation (times) setting. Web Manual P. 35
F 5	During a fastening process, the converted torque has become higher than the upper limit or lower than the lower limit.	Nothing is wrong with the product. Check the workpiece and the converted torque setting. Web Manual P. 33
F 6	During a fastening process, the forward/reverse lever was switched.	Do not switch the forward/reverse lever during a fastening process.
F 8	During a fastening process, the tool was overloaded or the motor failed.	Eliminate the condition(s) that caused the overload and recheck the condition. When this does not eliminate the problem, send the tool for repair.

ERROR CODES (cont.)

Display	Possible cause	Action
	▶ During a fastening process, a cord or cords became poorly connected.	▶ Check whether the cords are correctly connected and whether no cords are broken. When no abnormality is found in the cords, the power adapter may be failed. Send the tool for repair.
	▶ During a fastening process, the internal protective sensor became out of order.	▶ Send the tool for repair.
	▶ During a fastening process, the tool became hot.	▶ Interrupt the work and wait for it to cool down before use.

Fastening History Error Messages

You can check the fastening history in the history screen by accessing the controller via a web browser. **Web Manual P. 46**

	NOK message	Error message	Cause	Action
1	Error	High temperature	<ul style="list-style-type: none"> • Operation stopped to protect the tool from high heat. 	<ul style="list-style-type: none"> • Cool it down before using it again. (Prevent condensation, etc.) <p><If the error persists></p> <ul style="list-style-type: none"> • Check the work environment. • Check the workpiece conditions. • Check the power adapter.
2	Error	Motor sensor error	<ul style="list-style-type: none"> • The temperature sensor or current sensor of the tool detected an error. 	<ul style="list-style-type: none"> • Check for frequency. - If the problem occurs frequently, send the tool for repair (due to circuit failure).
3	Error	Tool locked	<ul style="list-style-type: none"> • Operation stopped to protect the tool since there is no motor rotation. <ul style="list-style-type: none"> - Caused by the work environment - Caused by a failure in the tool 	<ul style="list-style-type: none"> • Check the work environment. (Check for abnormal load and check how the operator is using the tool.)
4	Error	Low voltage	<ul style="list-style-type: none"> • Operation stopped to protect the tool since abnormal voltage around the power supply was detected. <ul style="list-style-type: none"> - Caused by the work environment - Caused by a failure in the power adapter or the tool 	<ul style="list-style-type: none"> • Check the power adapter. • Check the terminal (for dust and wear). • Check for frequency. - If the problem occurs frequently, send the tool for repair.
5	Error	Overcurrent	<ul style="list-style-type: none"> • Operation stopped to protect the tool since abnormal current was detected. <ul style="list-style-type: none"> - Caused by the work environment - Caused by a failure in the tool 	<ul style="list-style-type: none"> • Check the work environment. (Check for abnormal load and check how the operator is using the tool.)

ERROR CODES (cont.)

	NOK message	Error message	Cause	Action
6	Error	Rotation direction changed	<ul style="list-style-type: none"> Operation stopped to protect the tool since the forward/reverse lever setting was changed during work. 	<ul style="list-style-type: none"> Check the work environment. (Check how the operator is using the tool.)
7	Error	Parameter error	<ul style="list-style-type: none"> The set parameter is outside the setting range. 	<ul style="list-style-type: none"> Check the parameter. Set the parameter again.
8	Torque	Torque exceeded	<ul style="list-style-type: none"> The converted torque has become higher than the set upper limit during fastening. 	<ul style="list-style-type: none"> Check the setting. Check the workpiece conditions. Disable the set upper limit of the converted torque.
9	Torque	Torque insufficient	<ul style="list-style-type: none"> The converted torque has become lower than the set lower limit during fastening. 	<ul style="list-style-type: none"> Check the setting. Check the workpiece conditions. Disable the set lower limit of the converted torque.
10	Rotation count	Rotation count exceeded	<ul style="list-style-type: none"> The number of rotations of the tool's tip has become higher than the set upper limit during fastening. 	<ul style="list-style-type: none"> Check the setting. Check the workpiece conditions. Disable the set upper limit of the rotation (times).
11	Rotation count	Rotation count insufficient	<ul style="list-style-type: none"> The number of rotations of the tool's tip has become lower than the set lower limit during fastening. 	<ul style="list-style-type: none"> Check the setting. Check the workpiece conditions. Disable the set lower limit of the rotation (times).
12	Rotation time	Rotation time exceeded	<ul style="list-style-type: none"> The rotation time of the tool's tip has become longer than the set upper limit during fastening. 	<ul style="list-style-type: none"> Check the setting. Check the workpiece conditions. Disable the set upper limit of the rotation time.

	NOK message	Error message	Cause	Action
13	Rotation time	Rotation time insufficient	<ul style="list-style-type: none"> • The rotation time of the tool's tip has become shorter than the set lower limit during fastening. 	<ul style="list-style-type: none"> • Check the setting. • Check the workpiece conditions. • Disable the set lower limit of the rotation time.
14	Clutch	Stop before clutch actuation	<ul style="list-style-type: none"> • Fastening ends before clutch is activated. - During fastening, the tool stopped before clutch is activated. - During fastening, the tool stopped due to NOK caused by any other reason. 	<p><When the tool stopped before clutch is activated></p> <ul style="list-style-type: none"> • Check the work environment. • Check the workpiece conditions. <p><When fastening NOK due to any other reason is indicated></p> <ul style="list-style-type: none"> • Check the content of the fastening NOK and take necessary actions.

LICENCE TERMS

■ Software Licence Terms

This product consists of following types of software.

- (1) Software developed independently by Panasonic Corporation (Panasonic)
- (2) Software that a third party holds and is licenced to Panasonic
- (3) Open-source software

The software in the category (3) above is distributed in anticipation of being useful on a standalone basis; however, we make no warranty of any kind, including not making an implied warranty of “merchantability” or “fitness for particular purpose.”

Please refer to the detailed terms, conditions and the copyright notice thereof shown in the instruction manual available from the following website.



<https://panasonic.net/electricworks/ecm/powerelctrictools/download/>

[India Only]

Information on hazardous constituents as specified in sub-rule1 of rule16 in electrical and electronic equipment.

Declaration of Conformity with the requirements of the E-Waste (Management) Amendment Rules, 2023 with the sub-rule1 of rule16 limits with respect to Lead, Mercury, Cadmium, Hexavalent chromium, Polybrominated biphenyls, Polybrominated diphenyl ethers.

The content of hazardous substance with the exemption of the applications listed in SCHEDULE II of the E-Waste (Management) Second Amendment Rules, 2023:

1. Lead (Pb) – not over 0.1% by weight.
2. Cadmium (Cd) – not over 0.01% by weight.
3. Mercury (Hg) – not over 0.1% by weight.
4. Hexavalent chromium (Cr6+) – not over 0.1% by weight.
5. Polybrominated biphenyls (PBBs) – not over 0.1% by weight.
6. Polybrominated diphenyl ethers (PBDEs) – not over 0.1% by weight.



For the purpose of recycling to facilitate effective utilization of resources, please return this product to a nearby authorized collection center, registered dismantler or recycler, or Panasonic service center when disposing of this product. Customer care number (Toll free) : 1800 103 1333 , 1800 105 1333 Please see the Panasonic website for further information on collection centers, etc. or call the customer care toll-free number <https://www.panasonic.com/in/corporate/e-waste-management.html>

Do's & Don'ts		
No.	Do's	Don'ts
1	All electrical and electronic products are required to be handed over only to the Authorized recycler.	The product should not be opened by the user himself / herself, but only by authorized service personnel.
2	The product should be handed over only to authorized recycler for disposal.	The product is not meant for re-sale to any unauthorized agencies / scrap dealers / kabariwalas.
3	Keep the product in an isolated area, after it becomes non-functional / unrepairable so as to prevent its accidental breakage.	The product is not meant for mixing into household waste stream.
4	Refer to Operating Instructions for handling of end of life products	Do not keep any replaced spare part(s) from the product in an exposed area.
5	Always dispose of products that have reached end of life at Panasonic Life Solutions India Authorized Service Centre.	Do not donate old electronic items to anybody. Do not dispose of your product in garbage bins along with municipal waste that ultimately reaches landfill.
6	Wherever possible or as instructed, separate the packaging material according to responsible waste disposal options and sorting for recycling.	Do not give e-waste to informal and unorganized sectors like Local Scrap Dealers / Rag Pickers.

[中国大陆]

松下住宅电器(上海)有限公司
上海市松江工业区江田东路 258 号
Panasonic 客户咨询电话：4008-209-376

Panasonic Corporation

1006, Oaza Kadoma, Kadoma-shi, Osaka 571-8501, Japan
<https://www.panasonic.com>

CN, EN
EY9311ADA203 2024.03 S
发行：2024年3月

中国印刷