

使用说明书 电动螺丝刀

型号 EYADA系列
XC型号

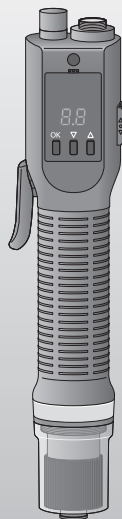

重要信息

使用本产品之前,请先详细阅读说明书,并妥加保管,以便日后使用。

所在地区不供货的型号,请参阅最新总目录。

原版说明书:英文

原版说明书译本:其他语言

目次

产品特点	2
安全注意事项	4
各部分的名称	10

使用前

使用前的准备	13
--------------	----

准备

使用方法	17
设置主体的功能 (设置模式)	22
计数菜单 (c + 数字)	25
实用程序菜单 (u + 数字)	32
通知菜单 (n + 数字)	39
基本设置菜单 (b + 数字)	41
通信电缆的使用方法	44

操作

性能、规格	49
维护、保管	51
错误显示	52
设置模式一览表	54
索引	56

其他

产品特点

本产品是一款搭载无刷电机的电动螺丝刀,具有轻便、易握持的特点。

本产品易于操作,无需更换刷子,具有良好的易维护性,可让作业变得更舒适。

※ 无需控制器即可在本机内进行各种功能的设置。

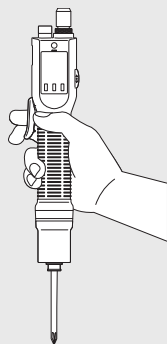

■ 请勿忘记紧固螺丝 P. 25

设置要进行紧固的螺丝数量。

■ 想知道紧固状态 P. 20、21

设置判定指示灯。

■ 想进行螺丝紧固合格与否判定 P. 35

设置旋转时间的上下限值。

■ 想选择拉杆启动、按压启动 P. 17

设置启动方式。

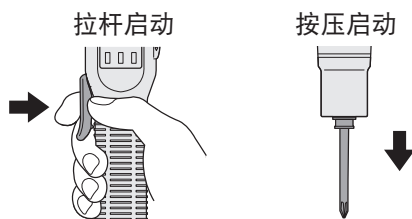

■ 想减少工具的取错率 P. 42

与外部设备(PLC等)配合设置工具的使用顺序。

■ 需要测量螺丝紧固时间 P. 38

使用秒表模式。

■ 需要导出作业结果 P. 44

使用另售的通信电缆,可输出数据。

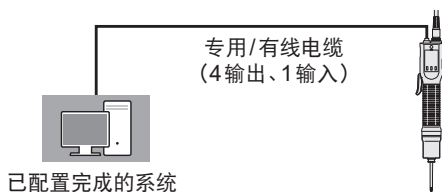

■ 螺丝紧固中的主要支持功能

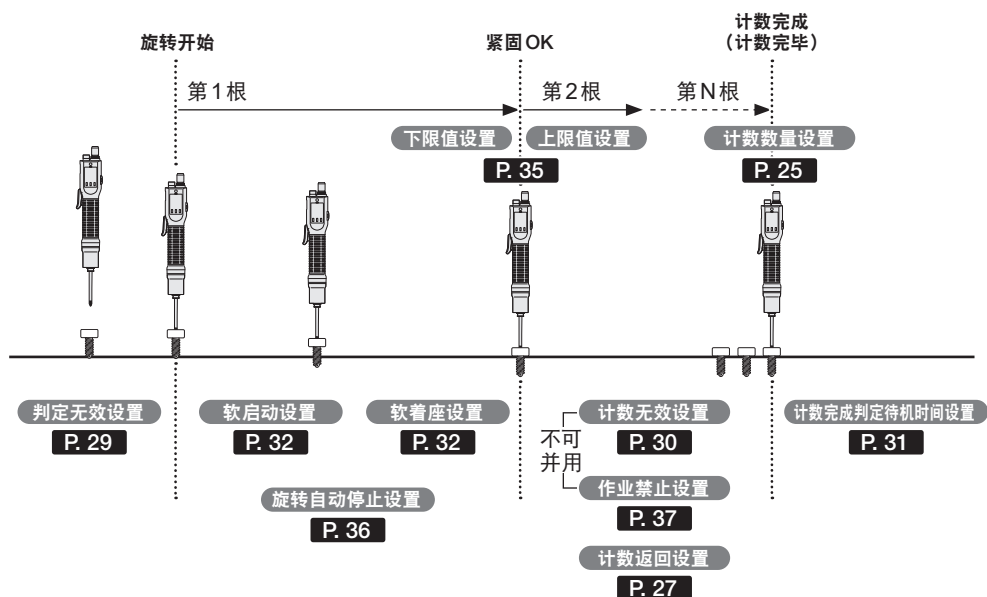



以下情形时	支持功能	参照页
想将意外的短时间旋转排除在判定之外。	判定无效设置	29
想让开始时的旋转变慢。 (防拧斜等)	软启动设置	32
想让着座前的旋转变慢。 (缓和冲击等)	软着座设置	32
需要在一定时间内停止旋转。 (攻丝等)	旋转自动停止设置	36
不想对二次紧固进行计数。 (一定时间)	计数无效设置	30
想禁止二次紧固。 (一定时间)	作业禁止设置	37
想设置反转作业时的计数处理。	计数返回设置	27
想设置最终数量之后进行反转作业时的处理。	计数完成判定待机时间设置	31



安全注意事项 请务必遵守



为了防止对人的危害和财产的损害,请必须遵守说明事项。

■ 针对错误使用时产生的危害和损害程度进行区分并说明。

 警告	可能造成死亡或重伤的内容。
 注意	可能造成轻伤或发生财产损失危险的内容。

■ 使用以下图片符号表示必须遵守的内容。(以下是图片符号的示例)

 绝对禁止的内容。
 必须执行的内容。

 警告	
 务必遵守	<ul style="list-style-type: none">● 日常管理扭矩。 如不遵守,将会因扭矩变动而造成螺丝松动,引发事故。
	<ul style="list-style-type: none">● 中断作业时及不使用时,确认没有运行。● 更换钻头和配件时,以及保管主体时,请务必将正/反转扳手置于开关锁定位置,并拔出电源适配器的电源线。 如不遵守,可能会因意外运行而引发事故。
	<ul style="list-style-type: none">● 使用过程中,保持主体不动,避免左右摆动。 否则可能会导致人员受伤。
	<ul style="list-style-type: none">● 在声音嘈杂的作业环境中,要佩戴耳塞、帽扇(耳罩)等隔音防护用具。 如不遵守,可能会损伤听力。
	<ul style="list-style-type: none">● 作业时要使用护目镜。 如不遵守,可能会损伤眼睛、喉咙。
	<ul style="list-style-type: none">● 电源插头要切实插到底。 如未插到底,可能会因触电或发热而引起火灾。 请勿使用损伤的插头、松动的插座。

警告



务必遵守

● **定期清除电源插头上的灰尘等。**

如果插头上积有灰尘等,就会因受潮等而造成绝缘不良,继而引发火灾。
请拔出电源插头,用干布擦拭。

● **使用指定的配件或附件。**

如不遵守,可能会造成人员受伤。

● **作业场所要足够明亮。**

昏暗会使视线变差,从而导致事故或人员受伤。

● **加工物要牢固固定。**

否则可能会发生意外移动,导致人员受伤。
使用夹钳或虎钳等固定,确保安全。

● **使用过程中,如果主体使用状况变差,或发出异音,请立即关闭开关,停止使用。**

请咨询您所购买的销售店或 Panasonic 客户咨询中心。如果继续使用,将导致人员受伤。

● **请按照使用说明书牢固安装钻头等尖头工具类及配件。**

如未安装牢固,可能会因脱落而导致人员受伤。

● **拆除用于调节的键及扳手等工具类后再使用。**

如不遵守,可能会因意外脱落而导致人员受伤。

● **穿着整洁的衣物进行作业。**

- 请勿穿着宽松的衣物及佩戴项链等饰品,否则可能会被卷入旋转部。
- 在室外进行作业时,建议穿着防滑鞋。
- 请用帽子或发套等将长发包住。

● **高空作业时,确保底下无人,并用绳索等拴住,以免主体掉落。**

否则,主体掉落可能会导致人员受伤。

● **使用本公司专用螺丝刀电源线、电源适配器、电源线。**

如不遵守,可能会导致事故及人员受伤。

警告



禁止

- **使用时请勿超过插座和配线器具的额定值。仅限在电气额定范围内使用。**

如果由于并联等方式超出额定值,会因发热而引起火灾。

- **请勿损坏螺丝刀电源线、电源线、电源插头。(不要损伤、破坏、加工、靠近发热器具、强行弯曲、拧扭、拉伸、放置重物、夹入、捆扎)**

如果在本产品损伤的情况下使用,会造成触电、短路、火灾。
定期检查电线和插头,如有破损,请咨询销售商。

- **主体冒烟时,请勿吸入烟气。**

否则会对身体造成损害。

- **作业刚结束时,请勿触摸钻头等尖头工具类和螺丝、切屑。**

否则会因高温而烫伤。

- **请勿用于非指定用途。**

否则可能会造成人员受伤。

- **主体沾有油等异物时,请勿使用。**

否则,主体可能会掉落从而引发事故。
此外,如果油等异物进入主体内部,可能会导致发热、起火、破裂。

- **使用过程中,身体或身体部位请勿靠近钻头等旋转部及切屑。**

否则,可能会意外碰到脱落或破损的钻头及切屑,从而造成人员受伤。请定期更换钻头等尖头工具。

- **请勿在其他设备上使用本公司专用螺丝刀电源线、电源适配器、电源线。**

否则可能会引发事故或导致人员受伤。

- **请勿在周边有石棉的环境下(包括清除作业)使用。**

否则可能会损害健康。
石棉是一种会严重危害人体健康的物质,例如会导致肺癌等,请充分注意。

警告



禁止

- **不使用时,将电源插头从插座中拔出。**
如不遵守,将会因绝缘老化而导致触电或漏电起火。



禁止接触

- **打雷后,请勿触摸本产品及电源插头。**
否则会触电。



禁止拆解

- **不得改装。且不可拆解或维修。**
否则可能会引起火灾、触电、人员受伤。
维修事宜请咨询您所购买的销售店或本公司咨询窗口。



禁止淋水

请勿进行以下操作。

- **请勿在淋雨或潮湿场所使用或放置。**
- **使用时不要浸入水中。**
否则可能会出现冒烟、起火、破裂。



禁止湿手

- **请勿用湿手从插座中插拔电源插头。**
否则可能会触电。

注意



务必遵守

- **主体发烫时,应中断作业,待温度下降后再使用。**
如不遵守,可能会造成烫伤。
- **拔出电源插头时,请务必握住电源插头拔出,而不是拉扯电源线。**
如果拉扯电源线拔出,将会导致触电、短路。
- **使用前,请确认主体、尖头工具和其他零件有无损伤,是否能正常运转。**
如不遵守,可能会因破损等而造成人员受伤。
- **请保持作业场所干净整齐。**
场所和作业台散乱会引发事故。
- **充分注意操作、作业方法及周围状况等,以常识进行作业。**
如不遵守,可能会引发事故或导致人员受伤。
- **壁挂安装电源适配器时,需用螺丝牢牢固定,防止掉落。**
否则可能会因掉落而导致人员受伤。



禁止

- **请勿放置在儿童可以触及的场所。**
否则可能会引发事故或故障。
- **请勿将主体存放在温度为 50 °C 以上的场所。**
否则可能导致动作异常。
- **请勿在电机锁定时强行使用。**
否则可能会出现冒烟、起火。
请用与性能适配的速度作业,以便安全高效地进行作业。

注意



禁止

● **请勿在不合理的姿势下作业。**

否则可能会摔倒而受伤。
请时刻注意脚底,保持平衡。

● **疲劳时请勿使用。**

否则可能会引发事故或人员受伤。

● **请勿让儿童等非作业人员靠近车间或触碰主体。**

否则可能会导致人员受伤。

● **请勿随身携带电线。**

否则,可能会因主体掉落导致人员受伤。

各部分的名称

主体

■ 正面

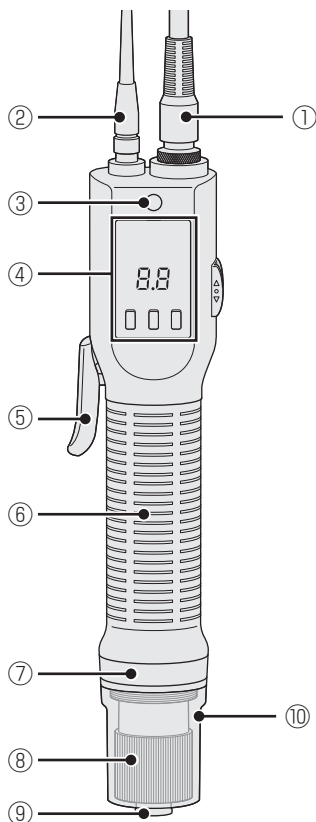

■ 侧面

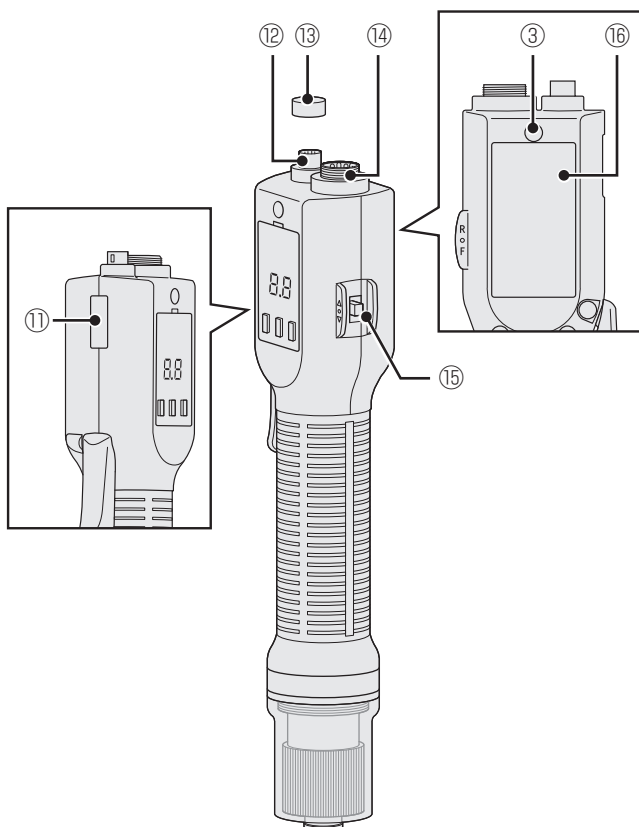

①	螺丝刀电源线
②	通信电缆
③	螺丝刀挂具安装孔
④	操作面板
⑤	拉杆开关
⑥	握柄
⑦	判定指示灯
⑧	联轴器手柄

⑨	钻套 (六角轴、6.35 mm)
⑩	联轴器盖
⑪	序列号牌
⑫	通信电缆连接部 [※]
⑬	盖帽
⑭	螺丝刀电源线连接部
⑮	正/反转扳手
⑯	额定值、警告、注意标识

※ 未连接通信电缆时,请装好盖帽。

■ 操作面板

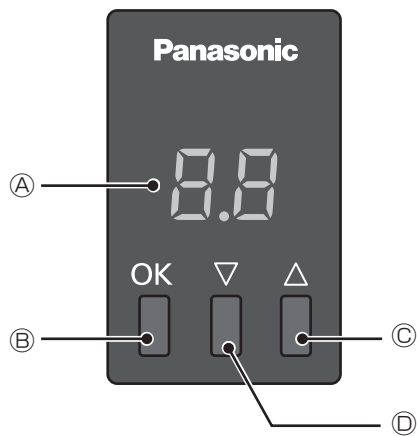

Ⓐ	显示屏
Ⓑ	OK 按钮

Ⓒ	▲按钮
Ⓓ	▼按钮

各部分名称 (续)

配件

(不附带钻头)

■ 2 m 螺丝刀电源线



■ 螺丝刀挂具



■ 联轴器盖

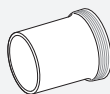

■ 握柄附件

※ 仅 EYADA407XC 标配



另售件

■ 电源适配器

(EYSZP001)

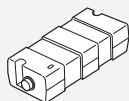

[仅中国适用]
电源线 1 m



[仅马来西亚适用]
电源线 1 m



[仅泰国适用]
电源线 1 m



[仅印度尼西亚适用]
电源线 1 m



[仅印度适用]
电源线 1 m



■ 螺丝刀挂具

(EYSXA100)



■ 3 m 通信电缆

(EYAXC230)



■ 联轴器盖

(EYSXA101)

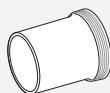

■ 2 m 螺丝刀电源线

(EYSXC120)

■ 3 m 螺丝刀电源线

(EYSXC130)



■ 握柄附件

(EYSXA102)

※ 套件内容为 **P.15**



使用前的准备

使用正/反转扳手

使用正/反转扳手可以更改电动螺丝刀的旋转方向,或锁定启动。

开关位置	旋转方向
R	反转(左转)
○	开关锁定状态
F	正转(右转)

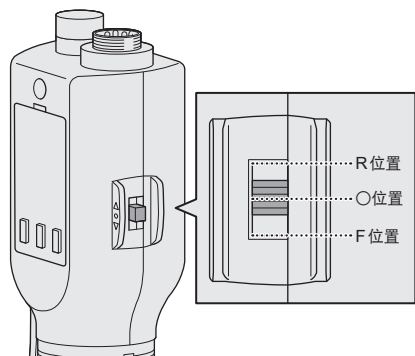

开关锁定

如将正/反转扳手切换至“○”的位置,会锁定电动螺丝刀的启动而不旋转。安装配件和钻头时,或不进行作业时,请将正/反转扳手切换至“○”的位置,置于开关锁定状态。

通知

- 如在旋转中操作正/反转扳手,会强制停止旋转。

安装螺丝刀挂具

- 1 将螺丝刀挂具向两侧轻拉**
如用力拉螺丝刀挂具,将无法复原。请用安装、拆卸所需的力度进行操作。

- 2 放入螺丝刀挂具安装孔**

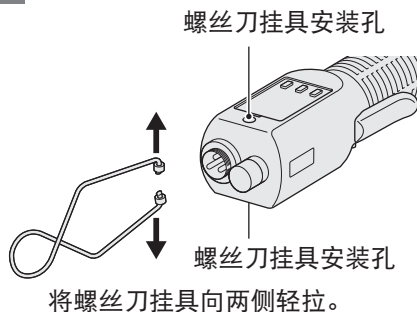

请按图中所示安装螺丝刀挂具和工具平衡器。

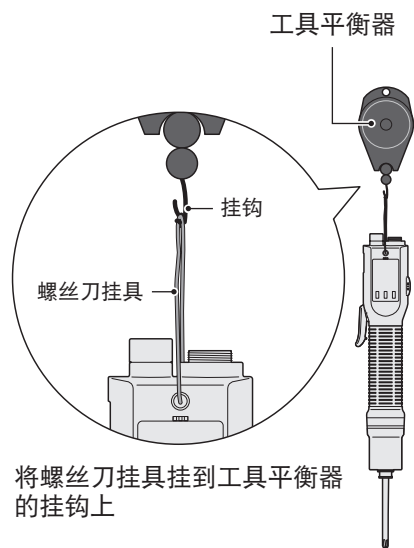

使用前的准备 (续)

安装钻头

要求

- 安装、拆卸钻头时,请将正/反转扳手置于“○(开关锁定状态)”的位置,然后关闭电源适配器的电源开关。

P. 13、16

1 拉伸钻套

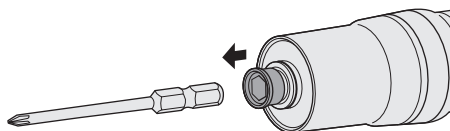

2 插入钻头

请在钻套拉伸的状态下插入。

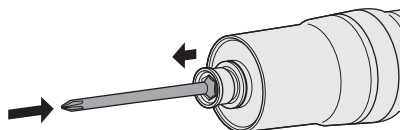

3 松开钻套

请轻拉钻头,确认不会脱落。

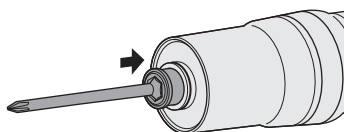

■ 本机可安装的钻头

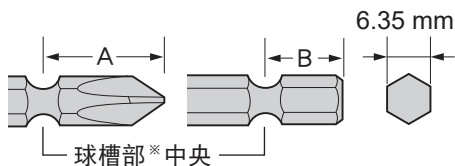

※ 不可使用不含球槽部的直钻头。

A的长度 (双头钻头)	12 mm~17.5 mm
B的长度 (单头钻头)	9 mm~13 mm

拆卸钻头

要求

- 作业刚结束时,请勿触摸钻头等尖头工具类及螺丝。否则会因高温而烫伤。

1 拉伸钻套

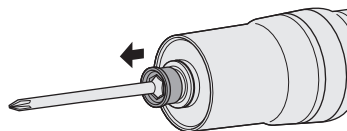

2 拆下钻头

请在钻套拉伸的状态下拔出。

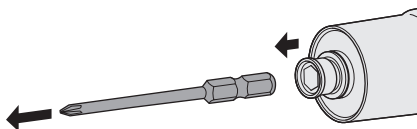

安装握柄附件

所有机型均可安装。
(仅EYADA407XC标配)

可阻断联轴器运转时的反作用力,减轻疲劳。

以拉杆启动方式使用时

将握柄附件的槽和握柄的加强筋对齐

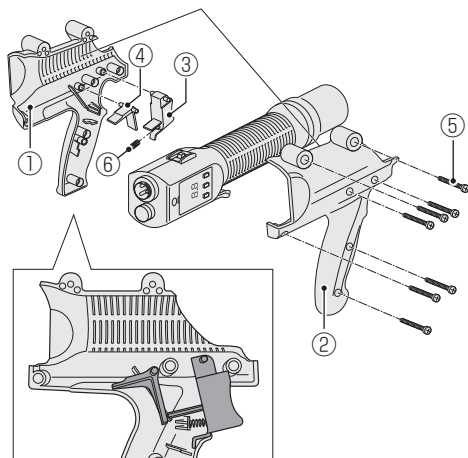

以按压启动方式使用时

将握柄附件的槽和握柄的加强筋对齐

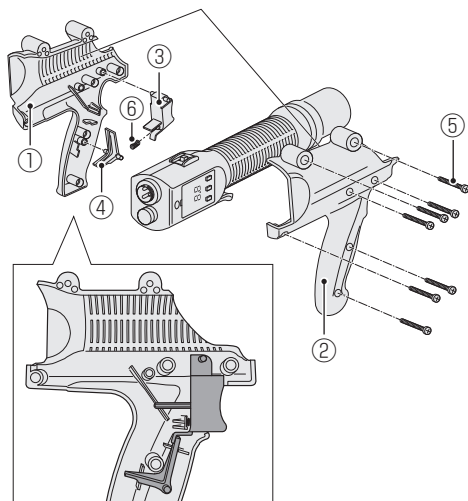

套件内容

①	握柄附件(A) ... 1个
②	握柄附件(B) ... 1个
③	触发器 ... 1个
④	接头 ... 1个
⑤	螺丝 ... 7个
⑥	弹簧 ... 1个

要求

- 安装、拆卸握柄附件时,请将正/反转扳手置于“○(开关锁定状态)”的位置,然后关闭电源适配器的电源开关。
P. 13、16
- 请先将钻头拆下后,再安装、拆卸握柄附件。
- 请用螺丝固定握柄附件后,再确认螺丝有无松动、摇晃、偏离。

1 将握柄附件(A)的槽和主体握柄的加强筋对齐

2 将触发器和接头安装到图中的位置

3 将握柄附件(B)的槽和主体握柄的加强筋对齐

4 紧固螺丝
请确认螺丝有无松动、摇晃、偏离。

螺丝刀挂具安装孔(2处)

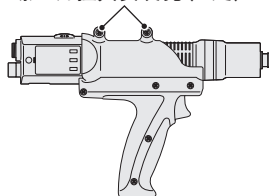

使用前的准备 (续)

连接电源

要求

- 请将正/反转扳手置于“○”的位置, 锁定开关后进行连接。 **P. 13**
- 请勿使用非本公司的电源(螺丝刀电源线、电源适配器、电源线)。此外, 请勿在其他设备上使用本公司专用电源和电源线。
- 长期不使用时, 建议从插座中拔出电源线。即使未打开本产品电源, 也会消耗电量。

1 将螺丝刀电源线连接到电源适配器和本产品

请确认连接器的方向, 正确安装。用接头环固定。

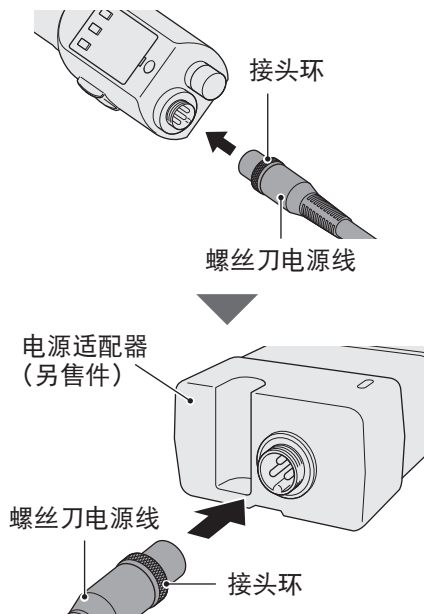

2 将电源线安装到电源适配器

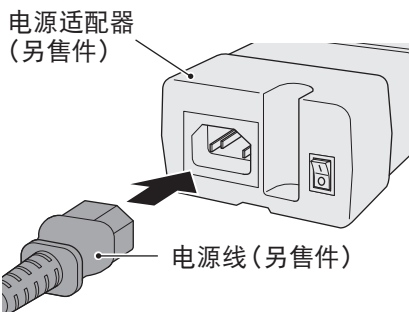

3 确认电源适配器的电源开关已关闭

电源 OFF 时, 电源指示灯熄灭。

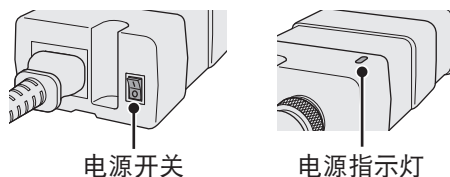

4 将电源插头插入插座

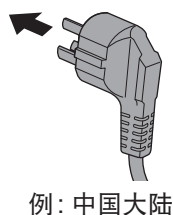

5 打开电源适配器的电源开关

电源指示灯亮绿灯。

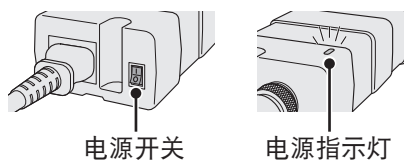

使用方法

切换启动方式

本产品具有2种旋转启动方式。
请根据作业,切换使用。
(出厂时为拉杆启动方式)

■ 切换为拉杆启动方式

1 将正/反转扳手设到“○”的位置

变为开关锁定状态。

P.13

2 长按拉杆(约5秒),直至判定指示灯亮黄灯(约1秒)

同时,蜂鸣器也会鸣响3声短音(哔哔哔)。

什么是拉杆启动方式

拉动拉杆,即开始旋转。松开拉杆,即停止旋转。

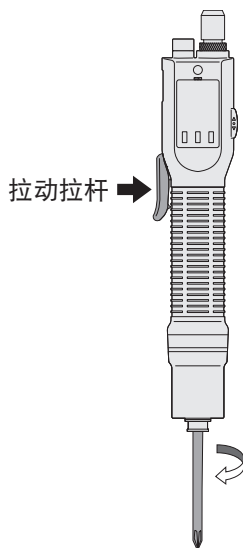

■ 切换为按压启动方式

1 将正/反转扳手设到“○”的位置

变为开关锁定状态。

P.13

2 将钻头前端按压到作业台等处(约5秒),直至判定指示灯亮黄灯(约1秒)

请在钻套部分微陷的状态下稍等片刻。

同时,蜂鸣器也会鸣响3声短音(哔哔哔)。

什么是按压启动方式

将电动螺丝刀朝钻头方向按压后,即开始旋转。停止按压,即停止旋转。

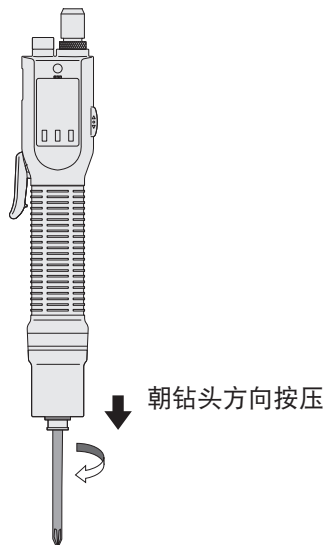

通知

- 仅可以选择的启动方式运行。不可以未选择的启动方式运行。

通知

- 如下图所示,可以拆除拉杆开关。

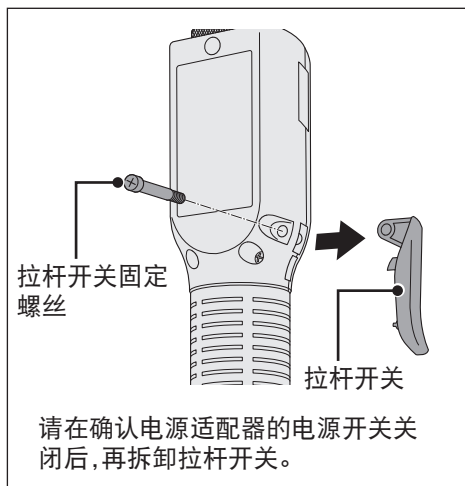

2 用联轴器手柄调节扭矩

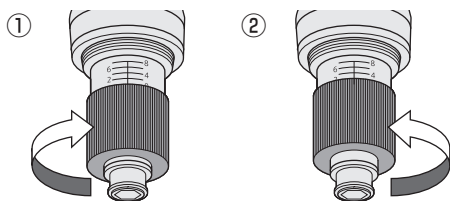

- ① 要提高输出扭矩时,将联轴器手柄向右(顺时针)转
- ② 要降低输出扭矩时,将联轴器手柄向左(逆时针)转

请遵守以下事项,以确保不发生故障,长期安全地使用。

- 请参考紧固扭矩标准表设置扭矩。
P. 19
- 请勿在电机锁定时强行使用。

设置紧固扭矩

可根据作业,按96档调节联轴器扭矩。

■ 设置步骤

1 拆下联轴器盖

逆时针旋转联轴器盖。

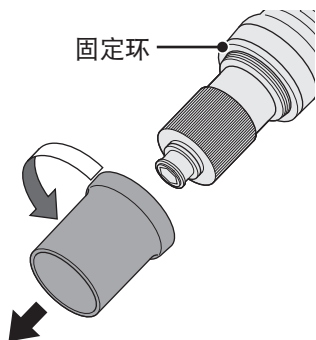

3 安装联轴器盖

请顺时针旋转联轴器盖。

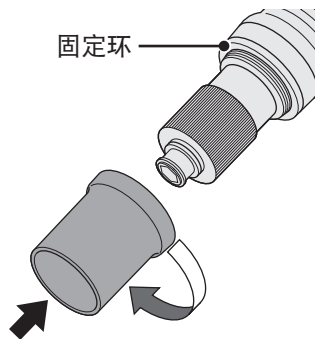

要求

- 请安装联轴器盖使用,以免意外更改联轴器设置。
- 如果固定环松动,请进行紧固。

紧固扭矩标准表 (参考值)

本数据是在以下测量条件下测得的参考值。
实际作业因周围条件(螺丝、零配件、固定方法等)而异。

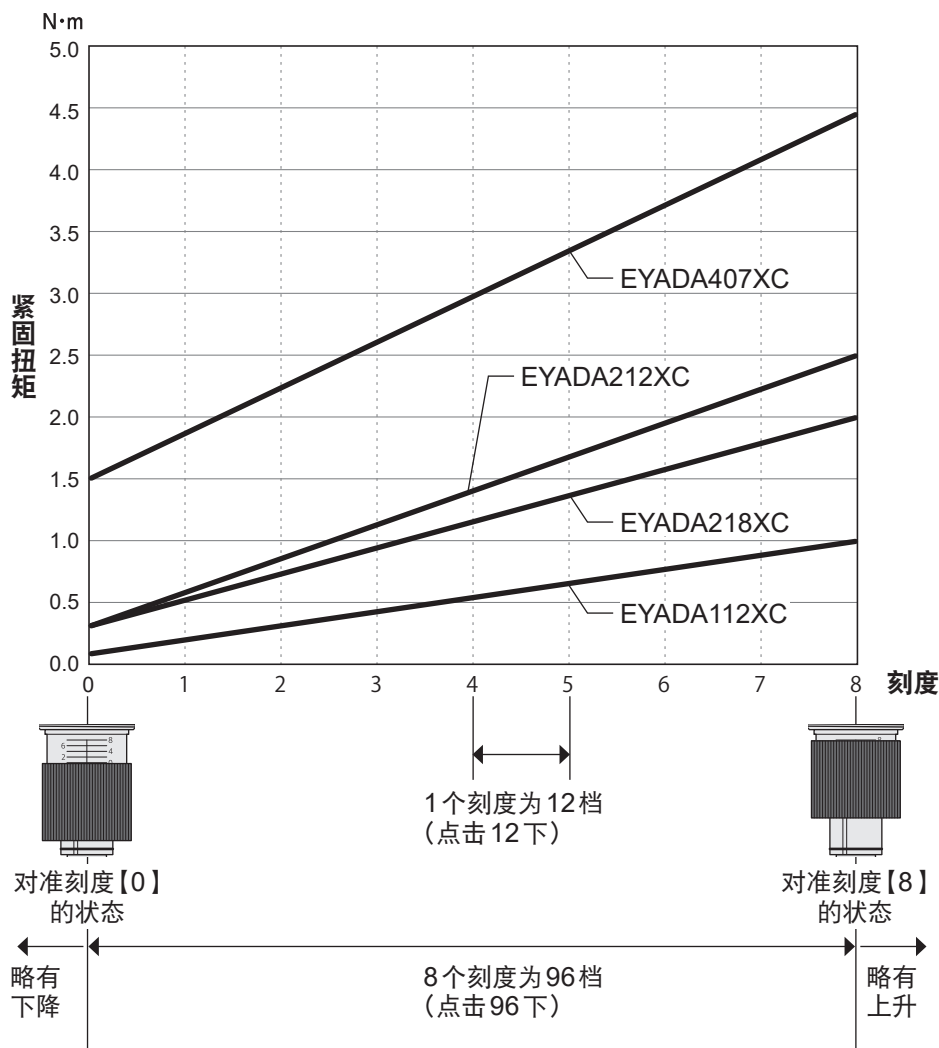

测量条件

按本公司规定的测量条件。

※ 实际作业因周围条件(螺丝、零配件、固定方法等)而异。建议在实际作业前进行确认。

开始作业

- 1** 用正/反转扳手设置旋转方向
设到“F”位置为正转(右转),设到
“R”位置为反转(左转)。

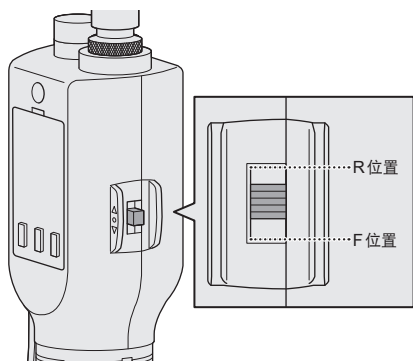

正转(右转)

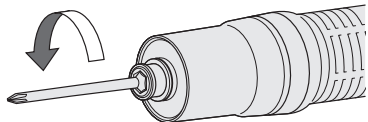

反转(左转)

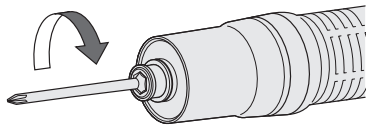

通知

- 如在旋转中操作正/反转扳手,会强制停止旋转。

2 开始旋转

如为“拉杆启动”,请拉动拉杆。
如为“按压启动”,请朝钻头方向按压。

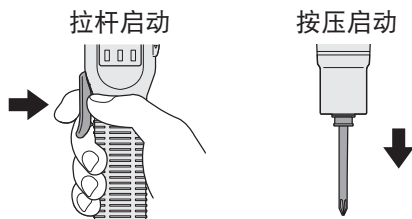

- 启动时,旋转初期可能会有一瞬间变慢,这并非故障。
- 快速ON/OFF时,旋转初期的随动性稍有变慢。
- 启动方式可选择“拉杆启动”或“按压启动”。

P. 17

确认紧固状况

本产品通过蜂鸣器和判定指示灯通知作业情况。

■ 紧固 OK

联轴器运转并正常完成紧固后,会通过蜂鸣器(哔)和判定指示灯点亮绿灯进行通知。也可以与通过旋转时间进行判定同时使用。

- 可在菜单中更改判定条件。
P. 35
- 可在菜单中更改指示灯的亮灯颜色。
P. 39



■ 计数完成 (计数完毕)

判定为紧固 OK 的螺丝紧固达到设定的计数数量的状态。

通过蜂鸣器 (哔-) 和判定指示灯亮蓝灯通知螺丝紧固已经正常执行完设置次数。

- 请设置计数数量。 **P. 25**
- 可在菜单中更改指示灯的亮灯颜色。 **P. 39**
- 可在菜单中更改蜂鸣器模式。 **P. 39**
- 可在菜单中更改蜂鸣器音量。 **P. 40**

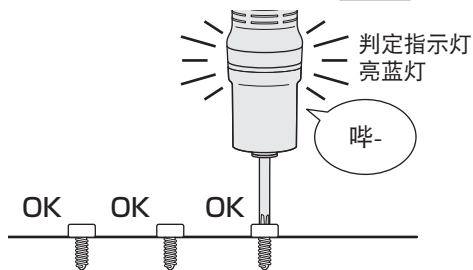

■ 紧固 NG (NOK)

联轴器不运转而停止, 未达到满足判定条件的状态。

蜂鸣器 (卜-) 和判定指示灯通过亮红灯通知螺丝紧固发生问题。

- 按下 OK 按钮, 错误显示消失。
- 可在菜单中更改指示灯的亮灯模式。 **P. 40**

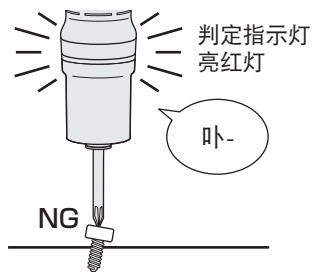

结束作业

- 1 将正/反转扳手设为开关锁定
请设到“○”位置。

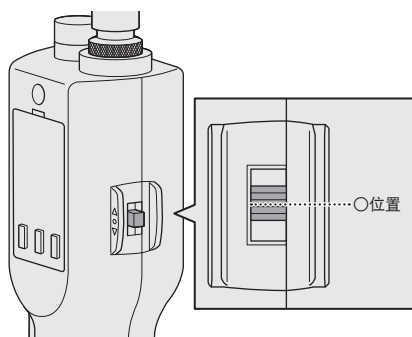

- 2 关闭电源适配器的电源开关
或
从插座中拔出电源插头

关闭电源开关

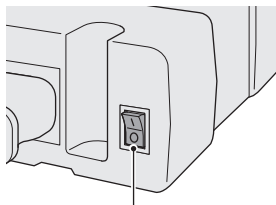

电源开关

从插座中拔出电源插头

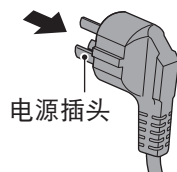

电源插头

例: 中国大陆

设置主体的功能 (设置模式)

1. 切换为设置模式

可根据作业更改本产品设置。
更改设置时,请切换为设置模式。

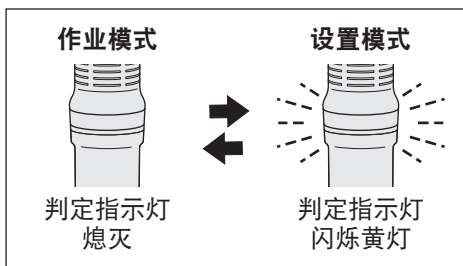

■ 切换为设置模式

1 将正/反转扳手设为开关锁定
请设到“O”位置。

2 长按OK按钮
蜂鸣器鸣响2声短音(哔哔),判定指示
灯闪烁黄灯。

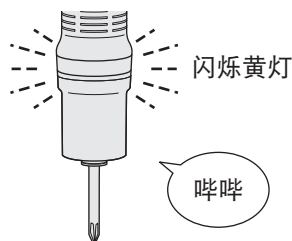

■ 返回作业模式

1 在设置模式中(判定指示灯闪烁
黄灯)长按OK按钮
蜂鸣器鸣响3声短音(哔哔哔),判定
指示灯熄灭。



2 从开关锁定切换正/反转扳手
设到F位置为正转(右转),设到R位
置为反转(左转)。

2. 选择菜单



在设置模式中按下▼▲按钮,可选择菜单。
在显示屏上显示选中的菜单。
请按下OK按钮确定选中的菜单。

至实用程序菜单 (u + 数字)



■ 计数菜单 (c + 数字)

显示	内容	参照页
	计数数量设置	25
	计数方式设置	26
	计数返回设置	27
	数量复位的许可设置	28
	判定无效设置	29
	计数无效设置	30
	计数完成判定待机时间设置	31



■ 基本设置菜单 (b + 数字)

显示	内容	参照页
	制动器设置	41
	外部输出时的信号设置	41
	外部输入时的驱动许可设置	42
	主体复位的许可设置	43



■ 通知菜单 (n + 数字)

显示	内容	参照页
	指示灯亮灯颜色设置	39
	蜂鸣器模式设置	39
	指示灯亮灯模式设置	40
	蜂鸣器音量设置	40



■ 实用程序菜单 (u + 数字)

显示	内容	参照页
	软启动、软着座时间设置	32
	软启动转速等级设置	33
	软着座转速等级设置	34
	按旋转时间的判定设置	35
	旋转自动停止设置	36
	作业禁止设置	37
	秒表模式	38



至计数菜单 (c + 数字)

设置主体的功能（设置模式）（续）

主体复位（初始化设置）

将主体的设置恢复为厂家出厂时的状态。

启用本功能时，请将“**[b4]**主体复位的许可设置”设为“**_1**”。 **P. 43**

■ 设置步骤

1 切换为设置模式

请将正/反转扳手设为开关锁定，长按OK按钮。

详情见 **P. 22**

2 同时长按OK按钮、▼按钮、▲按钮

蜂鸣器长鸣（哔-），显示屏显示“**—**”。

判定指示灯熄灭。

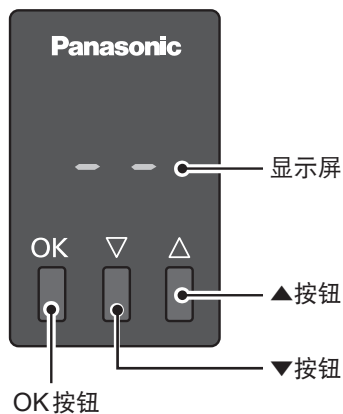

计数菜单(c + 数字)

c1 计数数量设置

设置要进行螺丝紧固的数量。

对紧固 OK 的螺丝紧固进行计数,达到设置的数量后,会通过蜂鸣器和点亮判定指示灯进行通知。

P. 20、21

- 作业模式时,在主体的显示屏上显示计数数量。
- 达到设置的数量后,会复位显示屏上的计数。

设为“3”时

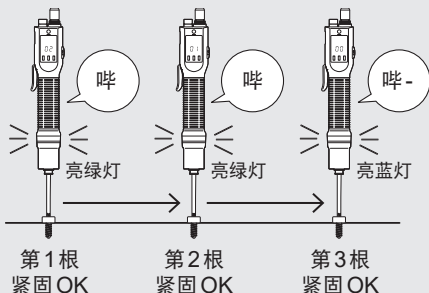

■ 设置步骤

1 切换为设置模式

请将正/反转扳手设为开关锁定,长按 OK 按钮。

P. 22

2 按▲▼按钮,选择“c1”,再按 OK 按钮

在显示屏上显示设定值。

3 按▲▼按钮进行设置

初始值为“--”。

显示	计数数量
--	OFF
01	1根
}	}
99	99根

4 按 OK 按钮确定

设置完成后,蜂鸣器长鸣(哔-),显示屏返回菜单显示。

5 返回作业模式

请长按 OK 按钮。

P. 22

计数菜单 (c + 数字) (续)

c2 计数方式设置

可切换螺丝紧固数量的计数方式。

倒数方式

正数方式

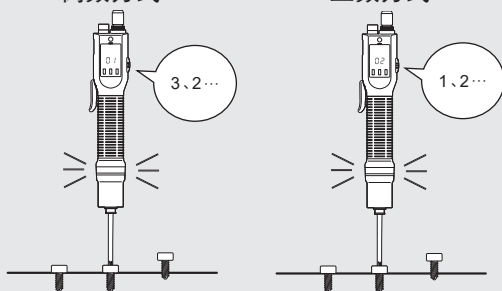

■ 设置步骤

1 切换为设置模式
请将正/反转扳手设为开关锁定, 长按 OK 按钮。

P. 22

2 按▲▼按钮, 选择“c2”, 再按 OK 按钮
在显示屏上显示设定值。

3 按▲▼按钮进行设置
初始值为“_1”。

显示	计数方式
	倒数方式 (将紧固数量从设定值减少到0进行计数)
	正数方式 (将紧固数量从0增加到设定值进行计数)

4 按 OK 按钮确定
设置完成后, 蜂鸣器长鸣(哔-), 显示屏返回菜单显示。

5 返回作业模式
请长按 OK 按钮。

P. 22

c3 计数返回设置

可设置对紧固OK的螺丝紧固进行重新操作、拧松等反转作业时的计数处理。

设为“_1”时

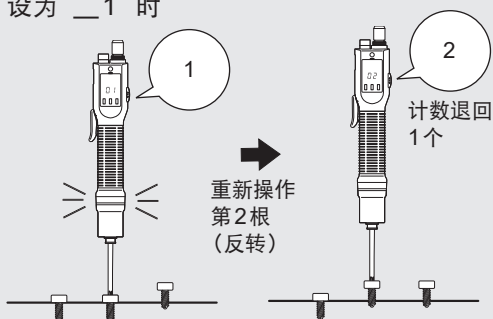

■ 设置步骤

1 切换为设置模式

请将正/反转扳手设为开关锁定,长按OK按钮。

P. 22

2 按▲▼按钮,选择“c3”,再按OK按钮

在显示屏上显示设定值。

3 按▲▼按钮进行设置

初始值为“_1”。

显示	计数返回
	OFF (反转作业不计数)
	退回1个* (反转作业计数退回)
	恢复为初始值 (在反转作业中复位计数)

※ 在未紧固任何1根螺丝的状态下,即使反转,计数也不会恢复为超过初始值。

※ 在设定的计数数量的最后数量执行反转作业时,请进行“c7”计数完成判定待机时间设置”。

P. 31

4 按OK按钮确定

设置完成后,蜂鸣器长鸣(哔-),显示屏返回菜单显示。

5 返回作业模式

请长按OK按钮。

P. 22

c4 数量复位的许可设置

许可手动复位计数数量。

如果设为“_1”,无需等待在计数数量设置中指定的数量,同时长按▼按钮和▲按钮即可复位计数。

设为“_1”时

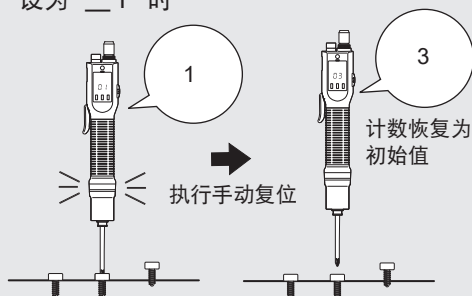

■ 设置步骤

1 切换为设置模式
请将正/反转扳手设为开关锁定,长按OK按钮。

P. 22

2 按▲▼按钮,选择“c4”,再按OK按钮
在显示屏上显示设定值。

3 按▲▼按钮进行设置
初始值为“_1”。

显示	数量复位的许可
	不许可 (手动复位无效)
	许可 (许可手动复位。 请同时长按▼按钮和▲按钮进行手动复位)

4 按OK按钮确定
设置完成后,蜂鸣器长鸣(哔-),显示屏返回菜单显示。

5 返回作业模式
请长按OK按钮。

P. 22

c5 判定无效设置

可将短时间空转及设置按压启动时对准螺丝孔等与作业无关的意外旋转排除在判定之外。

请设置排除在判定之外的旋转时间。

设为“0.3”时

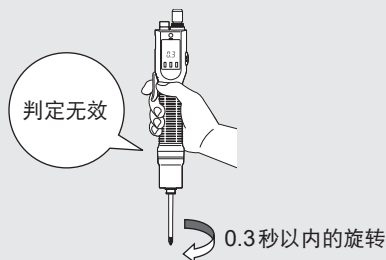

将0.3秒以内的旋转排除在紧固判定之外

■ 设置步骤

1 切换为设置模式

请将正/反转扳手设为开关锁定,长按OK按钮。

P. 22

2 按▲▼按钮,选择“c5”,再按OK按钮

在显示屏上显示设定值。

3 按▲▼按钮进行设置

初始值为“-.-”。

显示	判定无效时间
-.-	OFF
0.1	0.1 秒
}	}
9.9	9.9 秒

4 按OK按钮确定

设置完成后,蜂鸣器长鸣(哔-),显示屏返回菜单显示。

5 返回作业模式

请长按OK按钮。

P. 22

c6 计数无效设置

紧固 OK 后,可设置为即使进行二次紧固也不计数。

紧固 OK 后,请设置排除在计数之外的紧固时间。

- 重新操作或拧松等反转作业的计数有效。
- “c6 计数无效设置”和“u6 作业禁止设置”有效时,优先“u6 作业禁止设置”。

P. 37

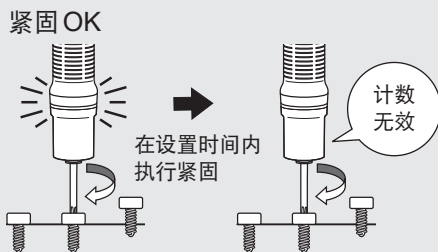

紧固 OK 后,设为计数无效的时间在二次紧固后仍计数无效

■ 设置步骤

1 切换为设置模式

请将正/反转扳手设为开关锁定,长按 OK 按钮。

P. 22

2 按▲▼按钮,选择“c6”,再按 OK 按钮

在显示屏上显示设定值。

3 按▲▼按钮进行设置

初始值为“-.-”。

显示	计数无效时间
-.-	OFF
0.1	0.1 秒
}	}
9.9	9.9 秒

4 按 OK 按钮确定

设置完成后,蜂鸣器长鸣(哔-),显示屏返回菜单显示。

5 返回作业模式

请长按 OK 按钮。

P. 22

c7 计数完成判定待机时间设置

可设置最终数量的螺丝紧固变为紧固OK后,到计数完成(计数完毕)判定的待机时间。

设置的待机时间可按照设置的计数数量的最终数量执行反转作业。

- 在待机时间内无法进行正转作业。

设为“3.0”时

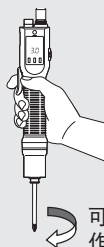

可进行3.0秒反转作业

按最终数量紧固OK后,可以3.0秒不进行计数,执行松开等重新操作的反转作业。

■ 设置步骤

1 切换为设置模式

请将正/反转扳手设为开关锁定,长按OK按钮。

P. 22

2 按▲▼按钮,选择“c7”,再按OK按钮

在显示屏上显示设定值。

3 按▲▼按钮进行设置

初始值为“-.-”。

显示	计数完成判定待机时间
-.-	OFF
0.1	0.1 秒
}	}
9.9	9.9 秒

4 按OK按钮确定

设置完成后,蜂鸣器长鸣(哔-),显示屏返回菜单显示。

5 返回作业模式

请长按OK按钮。

P. 22

实用程序菜单 (u + 数字)

01 软启动、软着座时间设置

可设置软启动的持续时间和软着座的开始时间。
请在“[u2]软启动转速等级设置”中设置软启动时的转速,在“[u3]软着座转速等级设置”中设置软着座时的转速。

P. 33、34

- 软着座开始时间不可设为小于软启动持续时间。

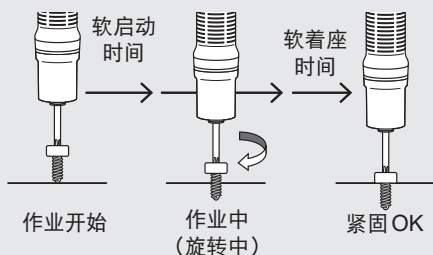

什么是软启动

开始紧固螺丝时缓慢旋转,以防出现倾斜,螺丝卡阻。

什么是软着座

钻头在着座前缓慢旋转,以减少偏离和对基材的影响。

■ 设置步骤

1 切换为设置模式

请将正/反转扳手设为开关锁定,长按OK按钮。

P. 22

2 按▲▼按钮,选择“u1”,再按OK按钮

在显示屏上显示设定值。

3 按▲▼按钮进行设置

可设置软启动的持续时间。初始值为“-.-”。

不需要软启动时,请设为“-.-”。

显示	软启动持续时间
-.-	OFF
0.1	0.1秒
}	}
9.9	9.9秒

4 按OK按钮确定

设置完成后,蜂鸣器长鸣(哔-)。

5 按▲▼按钮进行设置

可设置软着座的开始时间。初始值为“-.-”。

不需要软着座时,请设为“-.-”。

显示	软着座开始时间
-.-	OFF
0.1	0.1秒
}	}
9.9	9.9秒

6 按OK按钮确定

设置完成后,蜂鸣器长鸣(哔-),显示屏返回菜单显示。

请将软启动的转速等级设为“u2”,将软着座的转速等级设为“u3”。

7 返回作业模式

请长按OK按钮。

P. 22

u2 软启动转速等级设置

可设置软启动的转速。

请在“**u1** 软启动、软着座时间设置”中设置软启动的持续时间。

P. 32

- 由于电机结构的原因,从软启动转速提升到通常转速时,会发生时间滞后。

设为“04”时

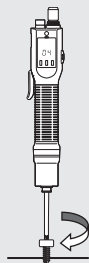

软启动中设置的时间以最大转速约50%的转速缓慢紧固

■ 设置步骤

1 切换为设置模式

请将正/反转扳手设为开关锁定,长按OK按钮。

P. 22

2 按▲▼按钮,选择“u2”,再按OK按钮

在显示屏上显示设定值。

3 按▲▼按钮进行设置

初始值为“10”。

4 按OK按钮确定

设置完成后,蜂鸣器长鸣(哔-),显示屏返回菜单显示。

5 返回作业模式

请长按OK按钮。

P. 22

软启动转速等级(转/分钟)

	Level1	Level2	Level3	Level4	Level5
显示	01	02	03	04	05
EYADA112XC	300	400	500	600	700
EYADA212XC	300	400	500	600	700
EYADA218XC	450	600	750	900	1050
EYADA407XC	160	220	270	330	380
※相对于最大转速	约25%			约50%	

	Level6	Level7	Level8	Level9	Level10
显示	06	07	08	09	10
EYADA112XC	800	900	1000	1100	1200
EYADA212XC	800	900	1000	1100	1200
EYADA218XC	1200	1350	1500	1650	1800
EYADA407XC	430	490	540	600	650
※相对于最大转速		约75%			约100%

- 数值(转速)仅供参考。

U3 软着座转速等级设置

可设置软着座的转速。

请在“[u1] 软启动、软着座时间设置”中设置软着座的开始时间。

P. 32

- 由于电机结构的原因,从通常转速下降到软着座转速时会发生时间滞后。

设为“04”时

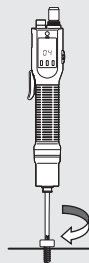

软着座中设置的时间以最大转速约50%的转速缓慢紧固

■ 设置步骤

1 切换为设置模式

请将正/反转扳手设为开关锁定,长按OK按钮。

P. 22

2 按▲▼按钮,选择“u3”,再按OK按钮

在显示屏上显示设定值。

3 按▲▼按钮进行设置

初始值为“10”。

4 按OK按钮确定

设置完成后,蜂鸣器长鸣(哔-),显示屏返回菜单显示。

5 返回作业模式

请长按OK按钮。

P. 22

软着座转速等级 (转/分钟)

	Level1	Level2	Level3	Level4	Level5
显示	01	02	03	04	05
EYADA112XC	300	400	500	600	700
EYADA212XC	300	400	500	600	700
EYADA218XC	450	600	750	900	1050
EYADA407XC	160	220	270	330	380
※相对于最大转速	约25%			约50%	

	Level6	Level7	Level8	Level9	Level10
显示	06	07	08	09	10
EYADA112XC	800	900	1000	1100	1200
EYADA212XC	800	900	1000	1100	1200
EYADA218XC	1200	1350	1500	1650	1800
EYADA407XC	430	490	540	600	650
※相对于最大转速		约75%			约100%

- 数值(转速)仅供参考。

U4 按旋转时间的判定设置

可通过螺丝紧固的旋转时间判定紧固情况。

请设置达到紧固 OK 的紧固时间的上下限值。

可在“**u7** 秒表模式”下测量最佳旋转时间。

P. 38

- 下限值的设置不可超过上限值。

设置为下限值 0.3、上限值 0.6 时

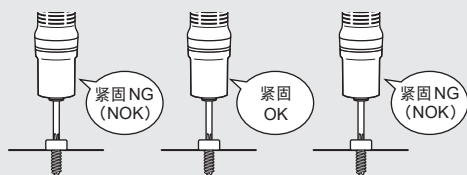

以 0.1 秒着座

以 0.5 秒着座

以 0.8 秒着座

着座所用的旋转时间为 0.3 秒~0.6 秒时，紧固 OK。

■ 设置步骤

1 切换为设置模式

请将正/反转扳手设为开关锁定，长按 OK 按钮。

P. 22

2 按▲▼按钮，选择“u4”，再按 OK 按钮

在显示屏上显示设定值。

3 按▲▼按钮进行设置

可设置旋转时间的下限值。

初始值为“-.-”。

不需要以下限值进行判定时，请设为“-.-”。

显示	旋转判定时间 (Min)
-.-	OFF
0.1	0.1 秒
}	}
9.9	9.9 秒

4 按 OK 按钮确定

设置完成后，蜂鸣器长鸣(哔-)。

5 按▲▼按钮进行设置

可设置旋转时间的上限值。

初始值为“-.-”。

不需要以上限值进行判定时，请设为“-.-”。

显示	旋转判定时间 (Max)
-.-	OFF
0.1	0.1 秒
}	}
9.9	9.9 秒

6 按 OK 按钮确定

设置完成后，蜂鸣器长鸣(哔-)，显示屏返回菜单显示。

7 返回作业模式

请长按 OK 按钮。

P. 22

U5 旋转自动停止设置

可按设置的时间自动停止旋转。
在不着座而停止的攻丝工序中,和因取错螺丝而导致长螺丝贯穿零部件的工序中有效。

- 请在“[u4]按旋转时间的判定设置”中设置旋转时间的上限值。

P. 35

- 当到达旋转时间的上限值时,将不进行联轴器运转而停止旋转动作。不进行螺丝紧固判定,判定指示灯也不点亮。此外,不保留作业数据履历。

设为“_ 1”时

※在“[u4]按旋转时间的判定设置”中,上限值设为0.6

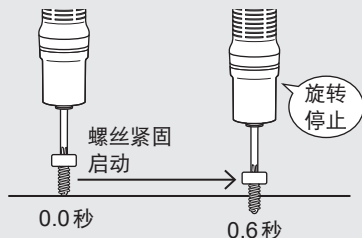

着座所用的旋转时间到达0.6秒时,旋转停止。

■ 设置步骤

1 切换为设置模式

请将正/反转扳手设为开关锁定,长按OK按钮。

P. 22

2 按▲▼按钮,选择“u5”,再按OK按钮

在显示屏上显示设定值。

3 按▲▼按钮进行设置

初始值为“_ _”。

显示	旋转自动停止
	OFF
	ON

4 按OK按钮确定

设置完成后,蜂鸣器长鸣(哔-),显示屏返回菜单显示。

请在“[u4]按旋转时间的判定设置”中设置旋转时间的上限值。

5 返回作业模式

请长按OK按钮。

P. 22

u6 作业禁止设置

可设置为紧固OK后,在设置时间内不启动。

- “c6 计数无效设置”和“u6 作业禁止设置”有效时,“u6 作业禁止设置”优先。

P. 30

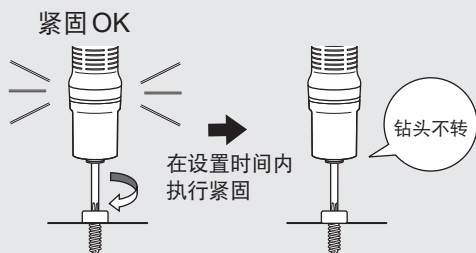

紧固OK后,电动螺丝刀在作业禁止设置中设置的时间内不启动。

■ 设置步骤

1 切换为设置模式

请将正/反转扳手设为开关锁定,长按OK按钮。

P. 22

2 按▲▼按钮,选择“u6”,再按OK按钮

在显示屏上显示设定值。

3 按▲▼按钮进行设置

初始值为“0.5”。

显示	作业禁止时间
0.5	0.5 秒
}	}
9.9	9.9 秒

4 按OK按钮确定

设置完成后,蜂鸣器长鸣(哔-),显示屏返回菜单显示。

5 返回作业模式

请长按OK按钮。

P. 22

07 秒表模式

可测量螺丝紧固的旋转时间的最大值、最小值。由于螺丝的长度及旋转速度不同,测量值会存在偏差,因此请进行多次测量。

- 在秒表模式下,不进行紧固判定。
- 即使在秒表模式中,也可设置实用程序菜单。
- 退出秒表模式时,请重新设置为“__”。

在秒表模式下,显示屏显示螺丝紧固时间(秒)。

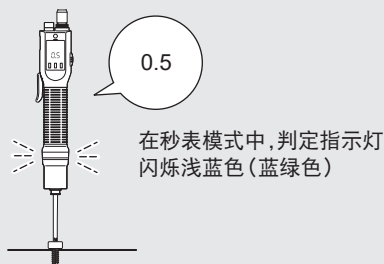

秒表模式中的操作

- ▲按钮:显示旋转时间的最大值
- ▼按钮:显示旋转时间的最小值
- OK按钮:重新显示测得的最新数据

- 长按▲按钮:复位最大值、最小值
- 长按▼按钮:删除上一条数据

■ 设置步骤

- 1 切换为设置模式**
请将正/反转扳手设为开关锁定,长按OK按钮。

P. 22

- 2 按▲▼按钮,选择“u7”,再按OK按钮**
在显示屏上显示设定值。

- 3 按▲▼按钮进行设置**
初始值为“__”。

显示	秒表模式
	OFF
	ON

- 4 按OK按钮确定**
设置完成后,蜂鸣器长鸣(哔-),显示屏返回菜单显示。

- 5 返回作业模式**
请长按OK按钮。

P. 22

通知菜单(n + 数字)

n1 指示灯亮灯颜色设置

可设置判定指示灯的亮灯颜色。

■ 设置步骤

1 切换为设置模式

请将正/反转扳手设为开关锁定, 长按 OK 按钮。

P. 22

2 按▲▼按钮, 选择“n1”, 再按 OK 按钮

在显示屏上显示设定值。

3 按▲▼按钮进行设置

初始值为“_1”。

显示	指示灯亮灯颜色
	OFF (熄灭)
	紧固 OK: 绿色 计数完成 (计数完毕): 蓝色
	紧固 OK: 蓝色 计数完成 (计数完毕): 绿色

4 按 OK 按钮确定

设置完成后, 蜂鸣器长鸣(哔-), 显示屏返回菜单显示。

5 返回作业模式

请长按 OK 按钮。

P. 22

n2 蜂鸣器模式设置

可设置计数完成(计数完毕)时的蜂鸣器模式。

■ 设置步骤

1 切换为设置模式

请将正/反转扳手设为开关锁定, 长按 OK 按钮。

P. 22

2 按▲▼按钮, 选择“n2”, 再按 OK 按钮

在显示屏上显示设定值。

3 按▲▼按钮进行设置

初始值为“_1”。

显示	蜂鸣器模式
	哔-(长鸣1次)
	哔哔哔(短鸣3次)

4 按 OK 按钮确定

设置完成后, 蜂鸣器长鸣(哔-), 显示屏返回菜单显示。

5 返回作业模式

请长按 OK 按钮。

P. 22

通知菜单 (n + 数字) (续)

n3 指示灯亮灯模式设置

可设置紧固 NG (NOK) 时及发生错误时, 判定指示灯的亮灯模式。

■ 设置步骤

1 切换为设置模式

请将正 / 反转扳手设为开关锁定, 长按 OK 按钮。

P. 22

2 按▲▼按钮, 选择“n3”, 再按 OK 按钮

在显示屏上显示设定值。

3 按▲▼按钮进行设置 初始值为“_1”。

显示	指示灯亮灯模式
	OFF (熄灭)
	紧固 NG (NOK): 亮红灯 其他错误: 闪烁红灯
	紧固 NG (NOK): 闪烁红灯 其他错误: 亮红灯

4 按 OK 按钮确定

设置完成后, 蜂鸣器长鸣 (哔-), 显示屏返回菜单显示。

5 返回作业模式

请长按 OK 按钮。

P. 22

n4 蜂鸣器音量设置

可设置蜂鸣器音量。

※ 紧固 OK 时的确认音和操作音的通用设置。

■ 设置步骤

1 切换为设置模式

请将正 / 反转扳手设为开关锁定, 长按 OK 按钮。

P. 22

2 按▲▼按钮, 选择“n4”, 再按 OK 按钮

在显示屏上显示设定值。

3 按▲▼按钮进行设置 初始值为“_2”。

显示	蜂鸣器音量
	OFF (消音)
	音量小
	音量中
	音量大

4 按 OK 按钮确定

设置完成后, 蜂鸣器长鸣 (哔-), 显示屏返回菜单显示。

5 返回作业模式

请长按 OK 按钮。

P. 22

基本设置菜单 (b + 数字)

b1 制动器设置

可设置联轴器运转前的旋转停止时有无制动器。

■ 设置步骤

1 切换为设置模式

请将正/反转扳手设为开关锁定, 长按 OK 按钮。

P. 22

2 按▲▼按钮, 选择“b1”, 再按 OK 按钮

在显示屏上显示设定值。

3 按▲▼按钮进行设置

初始值为“_1”。

显示	制动器
	OFF: 无制动器 (松开开关, 缓慢停止旋转)
	ON: 有制动器 (松开开关, 立即停止旋转)

4 按 OK 按钮确定

设置完成后, 蜂鸣器长鸣 (哔-), 显示屏返回菜单显示。

5 返回作业模式

请长按 OK 按钮。

P. 22

b2 外部输出时的信号设置

可从“计数完成信号”和“紧固 NG (NOK) 信号”中选择外部输出信号。

P. 45

■ 设置步骤

1 切换为设置模式

请将正/反转扳手设为开关锁定, 长按 OK 按钮。

P. 22

2 按▲▼按钮, 选择“b2”, 再按 OK 按钮

在显示屏上显示设定值。

3 按▲▼按钮进行设置

初始值为“_1”。

显示	外部输出时的信号
	计数完成信号
	紧固 NG (NOK) 信号

4 按 OK 按钮确定

设置完成后, 蜂鸣器长鸣 (哔-), 显示屏返回菜单显示。

5 返回作业模式

请长按 OK 按钮。

P. 22

b3 外部输入时的驱动许可设置

使用通信电缆连接外部设备时,可从外部设备控制本产品。P. 44

在使用多个工具的作业中,通过仅许可作业工具启动,或确保不许可的工具不启动,防止取错工具。

此外,还可切换控制中的电动螺丝刀的判定指示灯的闪烁/熄灭。

有驱动许可时

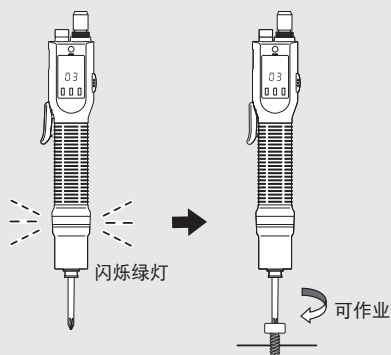

使作业电动螺丝刀的判定指示灯闪烁绿灯,进行通知

※也可以通过设置使判定指示灯不闪烁。

无驱动许可时

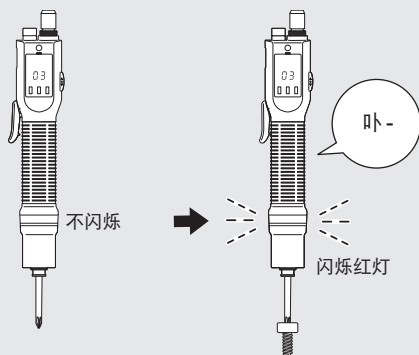

如果使用非作业电动螺丝刀,将不会启动,判定指示灯闪烁红灯,蜂鸣器鸣响。

设置步骤

1 切换为设置模式

请将正/反转扳手设为开关锁定,长按OK按钮。

P. 22

2 按▲▼按钮,选择“b3”,再按OK按钮

在显示屏上显示设定值。

3 按▲▼按钮进行设置

初始值为“__”。

显示	外部输入时的驱动许可
	OFF (不许可)
	ON (许可、指示灯闪烁)
	ON (许可、指示灯熄灭)

4 按OK按钮确定

设置完成后,蜂鸣器长鸣(哔-),显示屏返回菜单显示。

5 返回作业模式

请长按OK按钮。

P. 22

b4 主体复位的许可设置

许可主体复位。

设置为“_1”后,在设置模式下同时长按OK按钮、▼按钮和▲按钮,可将工具初始化。

P. 24

设为“_1”时

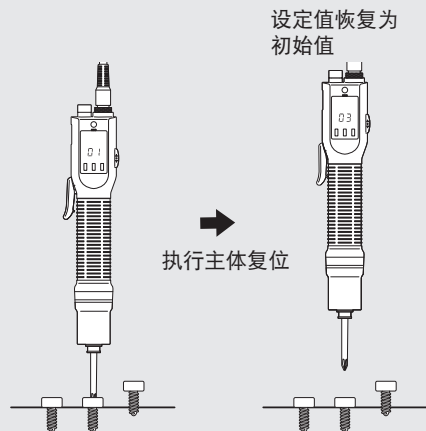

设置步骤

1 切换为设置模式

请将正/反转扳手设为开关锁定,长按OK按钮。

P. 22

2 按▲▼按钮,选择“b4”,再按OK按钮

在显示屏上显示设定值。

3 按▲▼按钮进行设置

初始值为“_1”。

显示	主体复位的许可
	不许可 (主体复位无效)
	许可 (许可主体复位。请在设置模式下同时长按OK按钮、▼按钮和▲按钮进行主体复位)

4 按OK按钮确定

设置完成后,蜂鸣器长鸣(哔-),显示屏返回菜单显示。

5 返回作业模式

请长按OK按钮。

P. 22

通信电缆的使用方法

连接另售的通信电缆,可与PLC等外部设备进行数据收发。

插拔电缆时,请将电源适配器的电源开关置于OFF后再进行。

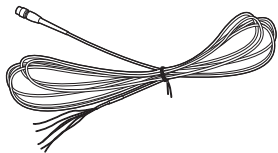

安装通信电缆

1 拆下连接器盖

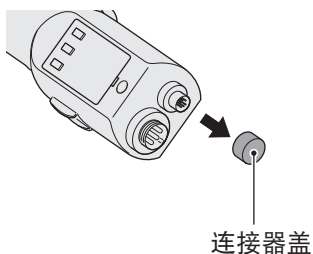

2 确认连接器的方向,切实安装到底

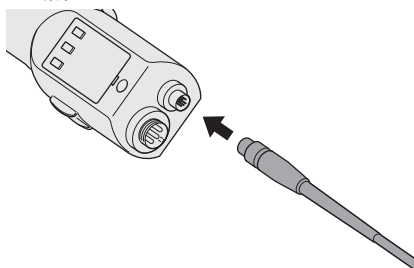

3 将电缆捆扎好,以防通信电缆断线

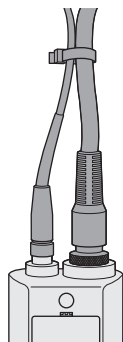

连接外部设备和通信电缆时,请仔细阅读外部设备的使用说明书。

输入输出信号

线色	输入输出	信号名	备注
红	输出	紧固OK信号	紧固OK时输出。 (固定为0.5秒)
蓝	输出	紧固NG(NOK)信号	紧固NG(NOK)时输出。 (固定为0.5秒)
		计数完成信号	设置的计数数量完成时输出。 (固定为0.5秒)
黄	输出	电机正转信号	电机处于正转状态时继续输出。
紫	输出	电机反转信号	电机处于反转状态时继续输出。
绿	输入	驱动许可信号	“ [b3] 外部输入时的驱动许可设置”设为“ __1 ”或“ __2 ”时,仅在输入ON信号期间驱动电机。 P. 42
浅蓝	—	COM	本端子为负极。 加载电压时,请连接负极侧。

- 对于“紧固NG(NOK)信号”和“计数完成信号”,仅可使用其一。请在“**[b2]**外部输出时的信号设置”中选择。

P. 41

通信电缆的使用方法 (续)

信号时间

作业实例

- 以2根完成作业
- 在松开作业中插入1次

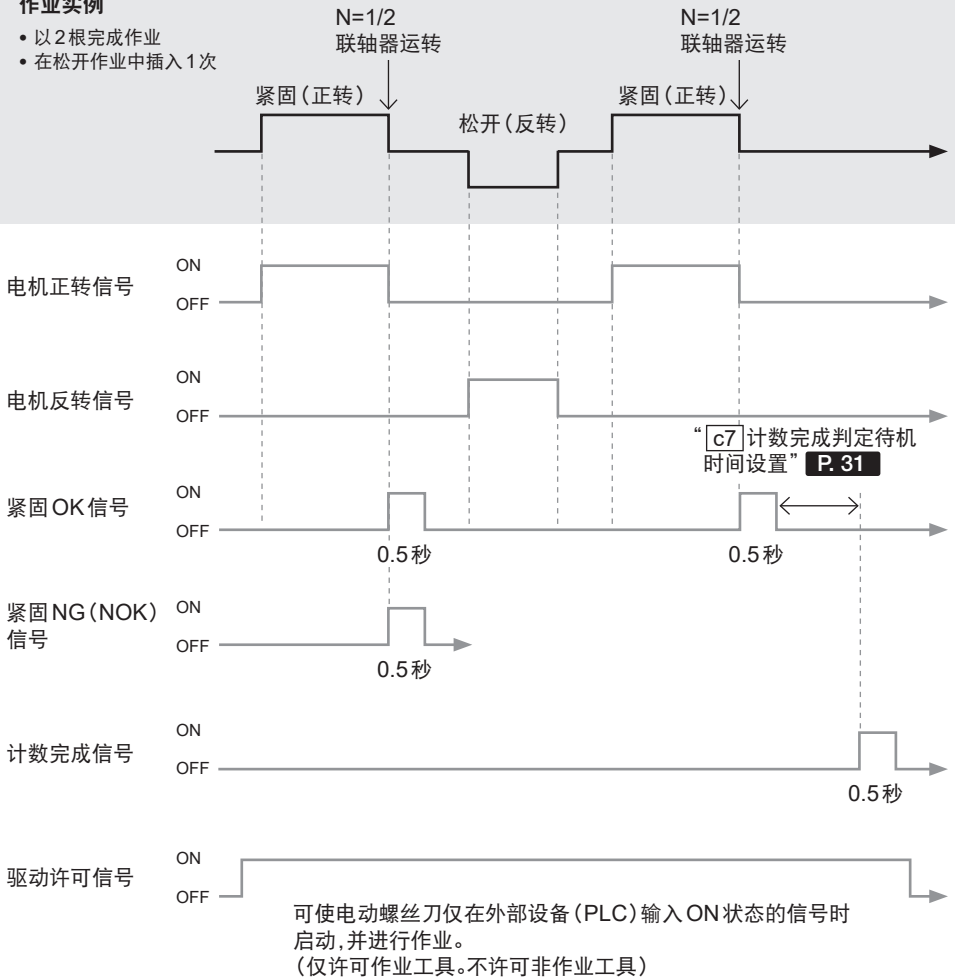

- 对于“紧固 NG (NOK) 信号”和“计数完成信号”, 仅可使用其一。请在“[b2] 外部输出时的信号设置”中选择。

P. 41

内部电路图

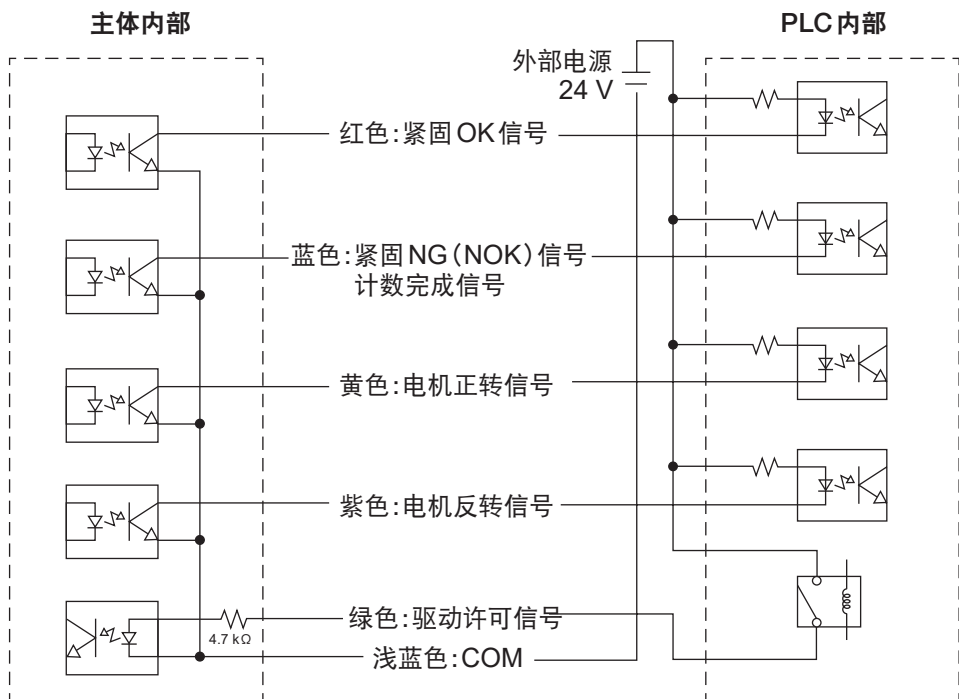

通知

■ 输入电路

- 光耦合器输入电路。
- 请在DC24 V \pm 10%下使用。
- 消耗电流为一次输入约5 mA。

■ 输出电路

- 集电极开路电路。
- 请在DC24 V \pm 10%下使用。
- 最大输出电流为一次输出20 mA。

■ 输入输出电路

- 绝对最大额定值为电压30 V、电流20 mA。

- 请勿使用PLC(光耦合器输入)以外的设备连接输出信号线。
- 请勿将电源以无限流电阻方式直接连接到信号输出线。否则会造成光耦合器破损。
- 请勿将继电器、电机、指示灯等直接连接到信号输出线。
- 否则会因感应负载产生的浪涌电压等造成工具破损。
- 向信号输入输出线加载外部电源的电压时,请将+连接到输入输出线侧,将-连接到COM侧。
- 如未连接通信电缆,驱动许可信号将识别为OFF。
- 接通或切断本产品的电源时,可能会输出信号,敬请注意。

性能、规格

主体性能

型号	EYADA112XC	EYADA212XC	EYADA218XC	EYADA407XC
建议作业	小螺丝： M2~M3.5	小螺丝： M2.5~M4.5	小螺丝： M2.5~M4	小螺丝： M3.5~M5
扭矩设置范围	0.1 N·m~1.0 N·m	0.3 N·m~2.5 N·m	0.3 N·m~2.0 N·m	1.5 N·m~4.4 N·m
扭矩设置档位	96档			
紧固扭矩精度 [※]	±10%			
转速	1200转/分钟 (10档调节)	1200转/分钟 (10档调节)	1800转/分钟 (10档调节)	650转/分钟 (10档调节)

<测量条件>按本公司规定的测量条件。

※因作业情况不同,紧固扭矩、紧固扭矩精度会发生变动。使用前,请务必通过实际作业进行确认。

主体规格

电源	由电源适配器(另售件)供电 AC100-240 V 50/60 Hz
电机	无刷电机(DC30 V)
钻套	单触式钻头锁紧方式 适用钻头(对边6.35 mm六角柄、 单头9 mm~13 mm、双头12 mm~17.5 mm)
大小(大概尺寸)	全长:271mm/握柄直径:φ 38 mm
质量(重量)	约630 g
开关方式	拉杆启动方式/按压启动方式 兼用(1台即可切换)
通信功能	有线(需要另售的通信电缆)
输出信号	紧固OK信号 紧固NG(NOK)信号 计数完成信号 电机正转信号 电机反转信号
输入信号	驱动许可信号
操作面板(显示屏)	7段显示
操作按钮	OK按钮/▼按钮/▲按钮
通知(指示灯)	5色显示(判定指示灯)
通知(蜂鸣器)	音量3档

性能、规格 (续)

数量计数时的设置	<ul style="list-style-type: none"> • 计数方式 • 计数返回 • 计数复位 • 判定无效 • 计数无效 • 计数完成判定待机
螺丝紧固合格与否判定	可以(旋转时间的上限/下限设置)
螺丝紧固支持	<ul style="list-style-type: none"> • 软启动 • 软着座 • 作业禁止设置 • 旋转自动停止
时序控制	可以(需要在PLC侧设置)
其他	秒表模式
通用规格	<ul style="list-style-type: none"> • 旋转方向切换(正转/反转) • 制动器ON/OFF设置
配件	<ul style="list-style-type: none"> • 螺丝刀电源线(2 m) • 螺丝刀挂具 • 联轴器盖 • 握柄附件(仅EYADA407XC标配)
另售件	<ul style="list-style-type: none"> • 螺丝刀电源线(2 m/3 m) • 螺丝刀挂具 • 联轴器盖 • 握柄附件 • 通信电缆(3 m) • 电源适配器(带电源线)

此处的规格可能会因性能提高而发生变化。

电源适配器规格

型号	EYSZP001
输入电压	AC100-240 V 50/60 Hz 2.6 A
输出电压	DC30 V 3 A
待机功率	0.16 W(100 V) 0.21 W(240 V) ※ 未连接螺丝刀主体的状态
质量(重量)	约 590 g
大小(大概尺寸)	全长(长边) 177 mm × 全高(厚度) 44 mm × 全宽(短边) 76 mm
配件	电源线 1 m(带接地插头。可从电源适配器主体拆装)

维护、保管

维护

■ 用软布擦拭

从插座中拔出电源插头,然后从主体拆下螺丝刀电源线,用干燥的软布擦拭。

请勿使用湿布、稀释液、苯、酒精等挥发性物品。

(否则会造成变色、变形、开裂)



■ 实施定期检查

- 请定期检查螺丝是否存在松动、破损、动作异常等情况。
- 请定期检查电源适配器是否破损。

保管

■ 请避免以下条件进行保管

- 车内等高温场所
- 阳光直射的场所
- 有水和潮湿等的场所
- 垃圾和粉尘多的场所
- 儿童可以触及的场所
- 有汽油等易燃物的场所
- 有掉落危险的场所

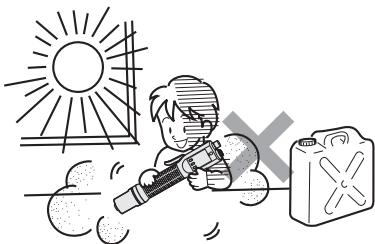

错误显示

如有异常,主体的显示屏会闪烁错误标记。
请进行以下检查及处理。

- “E0”~“E7”:
按下OK按钮,错误显示消失。
- “EE”及“F2”~“Fb”:
按下OK按钮,或者通过操作开关,错误显示即会消失。

如果处理后仍有异常,请立即停止使用。
请将产品携至您所购买的销售店。

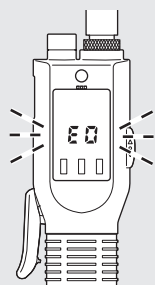

显示	可能的原因	处理
E0	设置模式下输入の設定值不当。	请修改设定值后重新输入。 P. 54
E3	主体发烫。	请中断作业,待温度下降后再使用。
E4	内部的保护传感器故障。	请前往修理。
E5	过载、电机故障等。	请消除发生过载的条件,重新进行确认。 如果仍未恢复,请前往修理。
E6	电源线类连接不正确。	请确认电源线类的连接情况以及是否存在断线。 如果电源线类未发现异常,则可能是电源适配器存在异常,请前往修理。
E7	主体电路发生异常、故障等。	请前往修理。
EE	通信电缆存在断线、接触不良等。	请确认通信电缆。

■ 作业中发生时的错误显示

显示	可能的原因	处理
F 2	在紧固作业中,联轴器运转之前主体停止。	这并非产品异常。 请让主体动作,直至联轴器运转。
F 3	在紧固作业中,超过了旋转时间的上限、下限值范围。	这并非产品异常。 请确认工件及旋转时间的设定值。 P. 35
F 6	在紧固作业中更改正/反转扳手。	请勿在紧固作业中操作正/反转扳手。
F 8	在紧固作业中,发生过载、电机故障。	请消除发生过载的条件,重新进行确认。 如果仍未恢复,请前往修理。
F 9	在紧固作业中,电源线类发生连接不良。	请确认电源线类的连接情况以及是否存在断线。 如果电源线类未发现异常,则可能是电源适配器存在异常,请前往修理。
F A	在紧固作业中,内部保护传感器发生故障。	请前往修理。
F b	在紧固作业中,主体发烫。	请中断作业,待温度下降后再使用。

设置模式一览表

c系		count (与数量计数相关的设置)			
c1	计数数量设置 P. 25	--	OFF	01	1根
c2	计数方式设置 P. 26			__1	倒数方式
c3	计数返回设置 P. 27			__	OFF
c4	数量复位的许可设置 P. 28	__	不许可	__1	许可
c5	判定无效设置 P. 29	--	OFF	0.1	0.1秒
c6	计数无效设置 P. 30	--	OFF	0.1	0.1秒
c7	计数完成判定待机时间设置 P. 31	--	OFF	0.1	0.1秒
u系		utility (支持作业的实用程序设置)			
u1	软启动、软着座时间设置 ^{※1} P. 32	--	OFF	0.1	0.1秒
u2	软启动转速等级设置 P. 33			01	Level 1 (约为最大时的25%)
u3	软着座转速等级设置 P. 34			01	Level 1 (约为最大时的25%)
u4	按旋转时间的判定设置 ^{※2} P. 35	--	OFF	0.1	0.1秒
u5	旋转自动停止设置 P. 36	--	OFF	__1	ON
u6	作业禁止设置 P. 37	0.5	0.5秒	0.6	0.6秒
u7	秒表模式 P. 38	--	OFF	__1	ON
n系		notification (与通知、指示灯和蜂鸣器相关的设置)			
n1	指示灯亮灯颜色设置 P. 39	__	OFF(熄灭)	__1	紧固OK:绿色 计数完成(计数完毕):蓝色
n2	蜂鸣器模式设置 P. 39			__1	哔-(长鸣1次)
n3	指示灯亮灯模式设置 P. 40			__	OFF(熄灭)
n4	蜂鸣器音量设置 P. 40	__	OFF(静音)	__1	音量小
b系		basic (基本设置、整体相关设置)			
b1	制动器设置 P. 41	__	OFF	__1	ON
b2	外部输出时的信号设置 P. 41			__1	计数完成信号
b3	外部输入时的驱动许可设置 P. 42			__	OFF (不许可)
b4	主体复位的许可 P. 43	__	不许可	__1	许可

※1 按顺序设置软启动时间和软着座时间这2个值。

※2 按顺序设置下限时间和上限时间这2个值。

	02	2根	～	99	99根
	_2	正数方式			
	_2	恢复为初始值			
	0.2	0.2秒	～	9.9	9.9秒
	0.2	0.2秒	～	9.9	9.9秒
	0.2	0.2秒	～	9.9	9.9秒
	0.2	0.2秒	～	9.9	9.9秒
	02	Level 2 (约为最大时的33%)	～	10	Level 10 (最高转速)
	02	Level 2 (约为最大时的33%)	～	10	Level 10 (最高转速)
	0.2	0.2秒	～	9.9	9.9秒
	0.7	0.7秒	～	9.9	9.9秒
	_2	紧固OK:蓝色 计数完成(计数完毕):绿色			
	_2	哔哔哔(短鸣3次)			
	_2	紧固NG(NOK):闪烁红灯 其他错误:亮红灯			
	_2	音量中	_3	音量大	
	_2	紧固NG(NOK)信号			
	_2	ON (许可、指示灯熄灭)			

索引

A

- 安装螺丝刀挂具····· 13
- 安装通信电缆····· 44
- 安装握柄附件····· 15
- 安装钻头····· 14
- 按设置时间自动停止旋转····· 36
- 按压启动方式····· 17

C

- 测量螺丝紧固的旋转时间····· 38
- 拆卸钻头····· 14
- 初始化设置····· 24

D

- 倒数方式····· 26
- 电源适配器····· 12, 16

F

- 反转····· 13, 20

G

- 更改计数方式····· 26

H

- 和PLC连接时····· 44

J

- 计数完成(计数完毕)····· 21
- 计数完成(计数完毕)后重新执行作业时····· 31
- 紧固NG(NOK)····· 21
- 紧固OK····· 20
- 紧固OK后,避免在二次紧固时计数····· 30
- 紧固OK后,设置为在设置时间内不启动····· 37
- 紧固OK后重新执行作业时····· 27
- 紧固启动时缓慢旋转····· 32-33

K

- 开关锁定····· 13

L

- 拉杆启动方式····· 17
- 连接电源····· 16
- 螺丝刀电源线····· 12, 16

M

- 秒表模式····· 38

Q

- 切换电动螺丝刀的旋转方向····· 20
- 切换启动方式····· 17
- 切换为设置模式····· 22

R		X	
软启动·····	32	许可主体复位·····	43
软着座·····	32	选择外部输出的信号·····	41
S		Y	
设置发生异常时的判定指示灯亮灯 模式·····	40	因意外旋转而无法计数·····	29
设置计数完成(计数完毕)时的蜂鸣器 模式·····	39	Z	
设置计数完成(计数完毕)时的蜂鸣器 音量·····	40	着座前缓慢旋转·····	32-34
设置紧固扭矩·····	18	正数方式·····	26
设置进行螺丝紧固的数量·····	25	正转·····	13, 20
设置判定指示灯的亮灯颜色·····	39		
设置软启动时的转速·····	33		
设置软着座时的转速·····	34		
设置外部输入时的驱动许可·····	42		
设置旋转的制动器·····	41		
使用正/反转扳手·····	13		
手动复位计数·····	28		
T			
通过旋转时间判定紧固情况·····	35		
通信电缆·····	12		

产品中有害物质的名称及含量

部件名称	有毒有害物质或元素					
	铅(Pb)	汞(Hg)	镉(Cd)	6价铬 (Cr(VI))	多溴联苯 (PBB)	多溴二苯醚 (PBDE)
外壳	○	○	○	○	○	○
回路基板	×	○	○	○	○	○
马达	○	○	○	○	○	○
其他付属品	○	○	○	○	○	○
机构部	○	○	○	○	○	○

本表格依据 SJ/T11364 的规定编制。

○:表示该有害物质在该部件所有均质材料中的含量均在GB/T 26572规定的限量要求以下。

×:表示该有害物质至少在该部件的某一均质材料中的含量超出GB/T 26572规定的限量要求。

执行标准	电动工具: GB/T 3883.1-2014, GB/T 3883.202-2019 GB 4343.1-2018, GB 17625.1-2012
	电源适配器: GB 4943.1-2022, GB/T 9254.1-2021, GB 17625.1-2012

Operating Instructions

Electric Screwdriver

Model No.: EYADA Series
Model No. XC

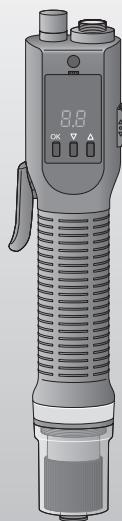

IMPORTANT

Read and follow the safety and operating instructions before using this product. In your area, including models that are not on sale. Please refer to the latest general catalogue.

Original instructions: English
Translation of the original instructions:
Other languages

Table of Contents

FEATURES OF PRODUCT.....	2	BEFORE USE
SAFETY PRECAUTIONS	4	
NAMES OF PARTS.....	10	
PREPARATION BEFORE USE ..	13	PREPARATION
HOW TO USE	17	OPERATION
SETTING FUNCTIONS OF TOOL (SETTING MODE).....	22	
COUNT MENU (c + NUMBER)	25	
UTILITY MENU (u + NUMBER)	32	
NOTIFICATION MENU (n + NUMBER)	39	
BASIC SETTING MENU (b + NUMBER)	41	
HOW TO USE COMMUNICATION CABLE.....	44	
CAPACITY AND SPECIFICATIONS	49	
CLEANING AND STORAGE	51	
ERROR CODES.....	52	
SETTING MODE LIST	54	
INDEX.....	56	

FEATURES OF PRODUCT

This unit is a compact and easy-to-grip Electric Screwdriver equipped with a brushless motor.

It handles well and is very easy to maintain because there is no need to replace a brush, thereby providing a comfortable working experience.

* You can make function settings on this unit without a controller.

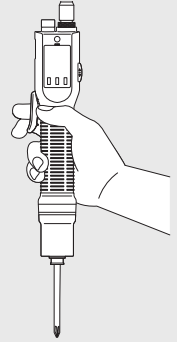

■ To prevent leaving screws unfastened **P. 25**

Set the number of screws to fasten.

■ To check the fastening status **P. 20, 21**

Set the detection lamp.

■ To perform fastening quality judgement **P. 35**

Set the upper and lower limits of the rotation time.

■ To select lever start or push start **P. 17**

Set the start mode.

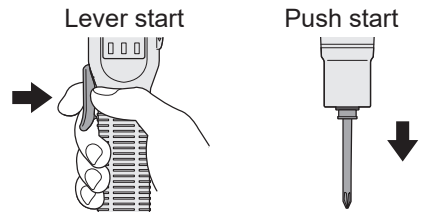

■ To prevent tool mix-ups **P. 42**

Link with an external device (e.g., a PLC) and set the order of using tools.

■ To measure the screw fastening time **P. 38**

Use the stopwatch mode.

■ To export the work result **P. 44**

Output data using a separately sold communication cable.

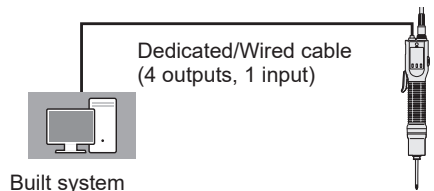

■ Support functions helpful for screw fastening

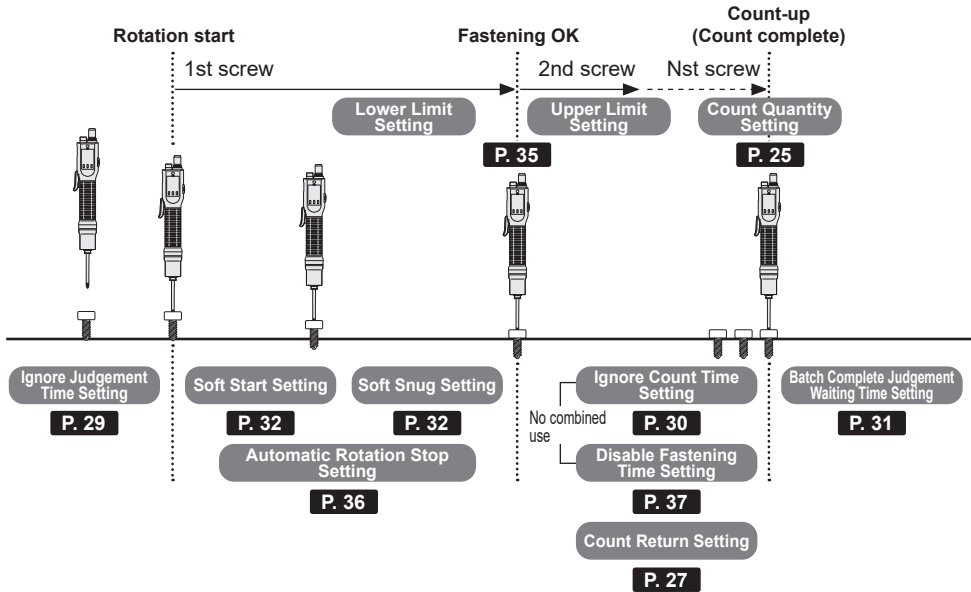

BEFORE USE



Task	Support function	Reference page
Ignore unexpected momentary rotations when performing judgement.	Ignore Judgement Time Setting	29
Slow the rotation rate at the start (to prevent galling, etc.).	Soft Start Setting	32
Slow the rotation rate before snugging (to minimise an impact, etc.).	Soft Snug Setting	32
Stop rotation after a set time (for tapping, etc.).	Automatic Rotation Stop Setting	36
Prevent counting refastenings (during a specific period).	Ignore Count Time Setting	30
Prevent refastenings (during a specific period).	Disable Fastening Time Setting	37
Set how to count reverse rotations.	Count Return Setting	27
Set how reverse rotations should be treated after the last screw is fastened.	Batch Complete Judgement Waiting Time Setting	31

SAFETY PRECAUTIONS



Always adhere to the instructions



Below are the instructions you should always adhere to, to prevent human harm and property damage.

■ The severity of harm and damage caused by incorrect use is presented with the following.

 WARNING	May cause death or serious injury.
 CAUTION	May cause minor injury or property damage.

■ The content that should be observed is presented with the following symbols. (The following are examples)

 You MUST NOT do the action.
 You MUST do the action.

 WARNING	
 Mandatory	<ul style="list-style-type: none">● Perform daily management of torque. Failure to observe this may cause loose screws due to torque fluctuations, resulting in an accident.
	<ul style="list-style-type: none">● When interrupting work or when not using the tool, ensure that it is not operating.● When replacing a bit or accessories, or when storing the tool, always set the forward/reverse lever to the trigger switch lock position, and disconnect the power cord. Failure to observe this may cause unexpected operation, resulting in an accident.
	<ul style="list-style-type: none">● Hold the tool securely to avoid being swung around during use. Failure to observe this may cause injury.
	<ul style="list-style-type: none">● Wear ear protectors such as earplugs or earmuffs in noisy work environments. Failure to observe this may adversely affect hearing.
	<ul style="list-style-type: none">● Use protective glasses during work. Failure to observe this may cause injury to the eyes or throat.
	<ul style="list-style-type: none">● Insert the power plug all the way seated. Incomplete insertion may cause electric shock or heat generation resulting in fire. Do not use a damaged plug or loose socket.

WARNING

- **Clean dust off the power plug routinely.**

Accumulated dust on the plug may absorb moisture and cause poor insulation resulting in fire.

Disconnect the power plug and wipe it with dry cloth.

- **Use the specified accessories and attachments.**

Failure to observe this may cause injury.

- **Keep the workplace sufficiently bright.**

Poor visibility in a dark workplace may lead to an accident or injury.

- **Fix the workpiece firmly.**

Failure to observe this may cause unexpected movement, resulting in injury. For safety, use clamps or vices for fixing it.

- **If the tool malfunctions or makes abnormal noises during use, immediately turn off the trigger switch and stop using it.**

Consult your dealer or Panasonic Customer Support Centre. Using it as is may result in injury.

- **Following the Operating Instructions, attach a bit or other pointed tools, and accessories securely.**

Failure to securely attach them may cause detachment, resulting in injury.

- **Before use, remove a key, wrench, and other tools used for adjustment.**

Failure to observe this may cause unexpected detachment, resulting in injury.

- **Work in proper attire.**

- Do not wear baggy clothing or accessories such as a necklace, because they may get caught in rotating parts.
- When working outdoors, you are recommended to use footwear with non-slip soles.
- Cover long hair with a cap or a hair cover.

- **When working at heights, thoroughly check that there are no people below and use wires or others to prevent the tool from falling.**

Otherwise someone may be injured if the tool falls.

- **Use only the screwdriver cord, power adapter, and power cord designed specifically for our screwdrivers.**

Failure to observe this may cause an accident or injury.



Mandatory

WARNING

- **Do not use a socket or wiring device in the manner of exceeding the rated value. Use only within electrical rated range.**

Exceeding the rated value due to an overloaded socket may cause heat generation resulting in fire.

- **Do not damage the screwdriver cord, power cord, or power plug. (Avoid damaging, breaking, modifying, putting close to a heat source, bending with force, twisting, pulling, putting a heavy load on it, pinching, or binding.)**

Using the damaged cord or plug may result in electric shock, short circuit, or fire.

Check the cord and plug periodically and if any damage, consult your dealer.

- **When smoke is emitted from the tool, do not inhale the smoke.**

It may be harmful to your body.

- **Immediately after work, do not touch a bit or other pointed tools, screws, or chips.**

They are hot and may cause burns.

- **Do not use the tool for any other purpose than intended.**

Failure to observe this may cause injury.

- **Do not use the tool with oil or other foreign material attached to it.**

Otherwise an accident may occur if the tool falls.

Also, such oil or other foreign material may enter the inside, resulting in generation of heat, fire, or burst.

- **While using a bit or other rotating parts, keep your body or a part of your body away from the rotating parts or chips.**

You may be injured when an unexpectedly detached or damaged bit or chips hit you. Replace a bit or other pointed tools periodically.

- **Do not use the screwdriver cord, power adapter, or power cord designed specifically for our screwdrivers to operate other devices.**

Failure to observe this may cause an accident or injury.

- **Do not use the tool in an environment where asbestos exists nearby (including an environment where asbestos is being removed).**





Doing so may adversely affect health.

Great care should be given to asbestos, because this substance causes lung cancer or other serious health damage.



Prohibited

WARNING

 Prohibited	<ul style="list-style-type: none">● Disconnect the power plug between uses. Failure to observe this may cause poor insulation resulting in electric shock or fire from electric leakage.
 No touching	<ul style="list-style-type: none">● If it is thundering, do not touch this unit or the power plug. Failure to observe this may result in electric shock.
 No disassembly	<ul style="list-style-type: none">● Do not modify the tool. Do not disassemble or repair the tool. Doing so may cause fire, electric shock, or injury. For repair, consult your dealer or our customer support team.
 Keep dry	<p>Avoid the following use of tools.</p> <ul style="list-style-type: none">● Do not use or leave them exposed to rain or moisture.● Do not use them immersed under water. Failure to observe this may cause smoke, fire, or burst.
 No wet hand	<ul style="list-style-type: none">● Do not use a wet hand to connect or disconnect the power plug to or from the outlet. Failure to observe this may cause electric shock.

CAUTION



Mandatory

- **If the tool becomes hot, interrupt the work and wait for it to cool down before use.**

Failure to observe this may cause burns.

- **To disconnect the power plug, always hold the power plug without pulling the cord.**

Pulling the cord may cause electric shock or short circuit.

- **Before use, check the tool, pointed tool, and other parts for any damage and confirm their normal operation.**

Failure to observe this may cause damage, resulting in injury.

- **Keep the workplace clean.**

A disordered workplace or work table may lead to an accident.

- **Consider well how to handle and work, pay attention to the surrounding environment, and use common sense during work.**

Failure to observe this may cause an accident or injury.

- **When installing the power adapter on a wall, securely screw it to prevent it from falling.**

Otherwise, the power adapter may fall, injuring someone.



Prohibited

- **Do not put the tool in a place accessible by a child.**

Failure to observe this may cause an accident or trouble.

- **Do not store the main body in a place where the temperature may rise to 50 °C or higher.**

Failure to observe this may lead to abnormal operation.

- **Do not use the tool in such a forceful manner that causes the motor to lock.**

Failure to observe this may cause smoke or fire.

In order to work safely and efficiently, work at a speed that matches the ability.

CAUTION



Prohibited

- **Do not work in an unusual position.**
Otherwise you may fall over and be injured.
Always stand on a stable footing and keep a good balance.
- **Do not use the tool when you are tired.**
Failure to observe this may cause an accident or injury.
- **Do not allow a child or any other person who is not an operator to come near the workplace or touch the tool.**
Doing so may cause injury.
- **Do not hold only the cord to carry the tool.**
Doing so may cause the tool to fall, resulting in injury.

NAMES OF PARTS

Tool

■ Front View

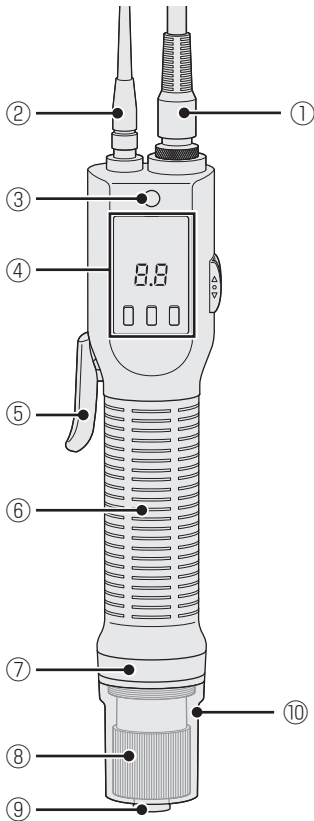

■ Side View

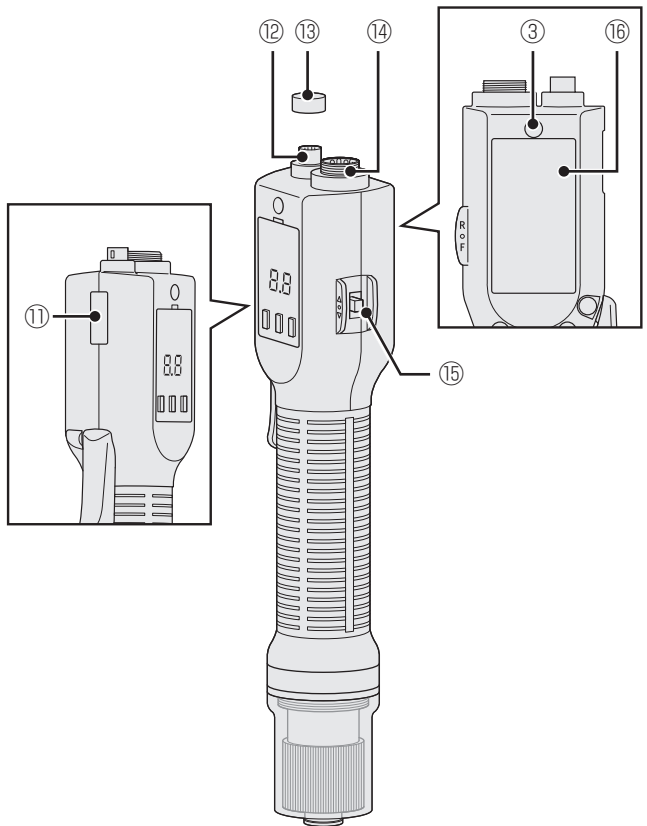

①	Screwdriver cord
②	Communication cable
③	Screwdriver hanger mounting hole
④	Operation panel
⑤	Lever trigger switch
⑥	Grip
⑦	Detection lamp
⑧	Clutch handle

⑨	Bit holder (for hex shaft, 6.35 mm)
⑩	Clutch cover
⑪	Serial plate
⑫	Communication cable connector*
⑬	Cap
⑭	Screwdriver cord connector
⑮	Forward/Reverse lever
⑯	Rating, warning, and caution indications

* Attach the cap when the communication cable is not connected.

■ Operation panel

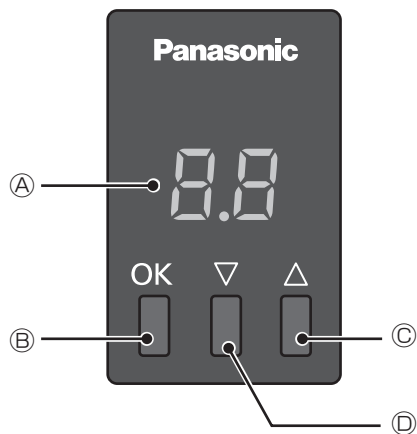

BEFORE USE

Ⓐ	Display
Ⓑ	OK button

Ⓒ	▲ button
Ⓓ	▼ button

NAMES OF PARTS (cont.)

Accessories

(No bit is supplied.)

■ 2 m Screwdriver Cord



■ Screwdriver Hanger



■ Clutch Cover

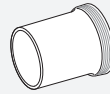

■ Grip Attachment

* Supplied for EYADA407XC only

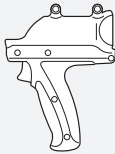

Separately sold items

■ Power Adapter

(EYSZP001)

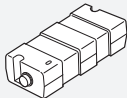

[For China only]
Power Cord 1 m



[For Malaysia only]
Power Cord 1 m



[For Thailand only]
Power Cord 1 m



[For Indonesia only]
Power Cord 1 m



[For India only]
Power Cord 1 m



■ Screwdriver Hanger

(EYSXA100)



■ 3 m Communication

Cable

(EYAXC230)



■ Clutch Cover

(EYSXA101)

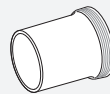

■ 2 m Screwdriver Cord

(EYSXC120)



■ Grip Attachment

(EYSXA102)

* For information about the components, see **P. 15**



■ 3 m Screwdriver Cord

(EYSXC130)

PREPARATION BEFORE USE

Using Forward/Reverse Lever

With the forward/reverse lever, you can change the rotation direction of the Electric Screwdriver or lock the start.

Trigger switch position	Rotation direction
R	Reverse (Anticlockwise)
○	Trigger switch locked
F	Forward (Clockwise)

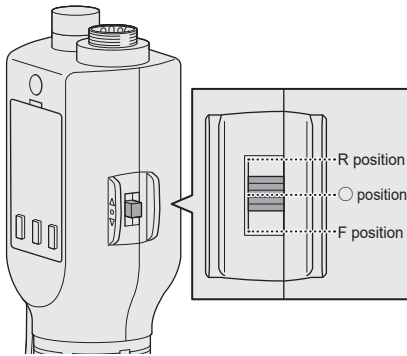

Trigger switch lock

When you switch the forward/reverse lever to the “○” position, the start of the Electric Screwdriver is locked and it does not rotate.

When attaching accessories or a bit, or when not working, switch the forward/reverse lever to the “○” position to lock the trigger switch.

NOTE

- If the forward/reverse lever is switched while the motor is in action, the motor is forcibly stopped to rotate.

Attaching Screwdriver Hanger

- 1 Pull the screwdriver hanger lightly on both sides.**
Pulling the screwdriver hanger hard may prevent it from returning to its original position. Perform attachment and removal with necessary force.

- 2 Put it into the screwdriver hanger mounting hole.**

Screwdriver hanger mounting hole

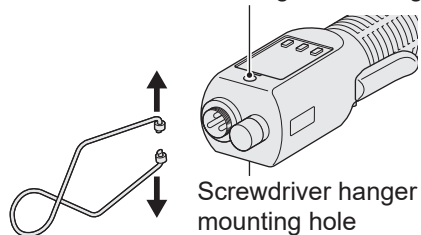

Pull the screwdriver hanger lightly on both sides.

Attach the screwdriver hanger and the tool balancer as shown in the figure.

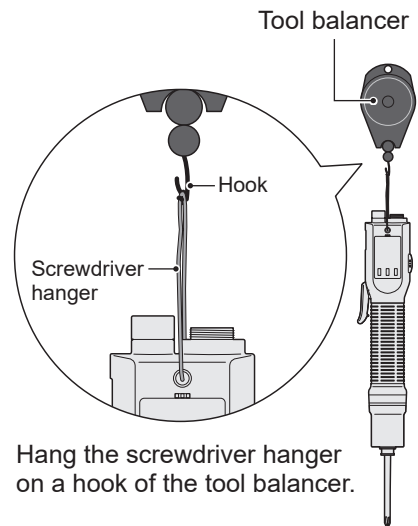

Hang the screwdriver hanger on a hook of the tool balancer.

PREPARATION BEFORE USE (cont.)

Attaching Bit

ATTENTION

- When attaching or removing a bit, set the forward/reverse lever to the "○ (Trigger switch locked)" position, and turn OFF the power switch of the power adapter.

P. 13, 16

1 Pull the bit holder.

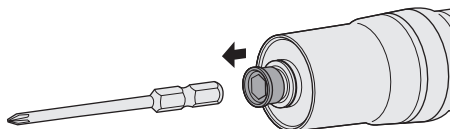

2 Insert a bit.

Insert it with the bit holder pulled.

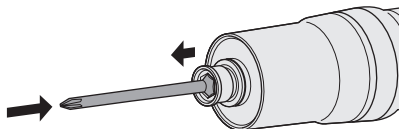

3 Release the bit holder.

Check that the bit does not come off, by pulling it lightly.

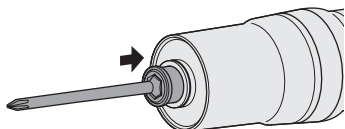

Bits That Can Be Attached to This Unit

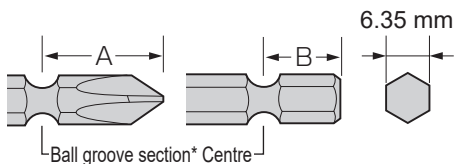

* Straight bits without a ball groove section cannot be used.

Length of A (Double-ended bit)	12 mm to 17.5 mm
Length of B (Single-ended bit)	9 mm to 13 mm

Removing Bit

ATTENTION

- Immediately after work, do not touch a bit or other pointed tools, or screws. They are hot and may cause burns.

1 Pull the bit holder.

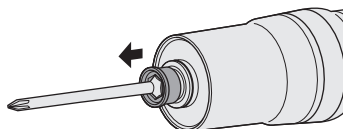

2 Remove the bit.

Pull it out with the bit holder pulled.

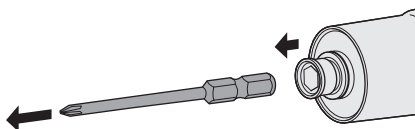

Attaching Grip Attachment

The grip attachment can be attached to all models.

(Supplied for EYADA407XC only)

It can absorb the reactive force during clutch activation, which helps reduce fatigue.

Use in lever start mode

Align grooves in the grip attachment with ribs on the grip.

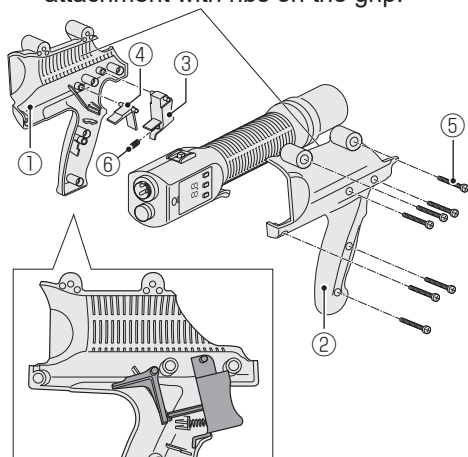

Use in push start mode

Align grooves in the grip attachment with ribs on the grip.

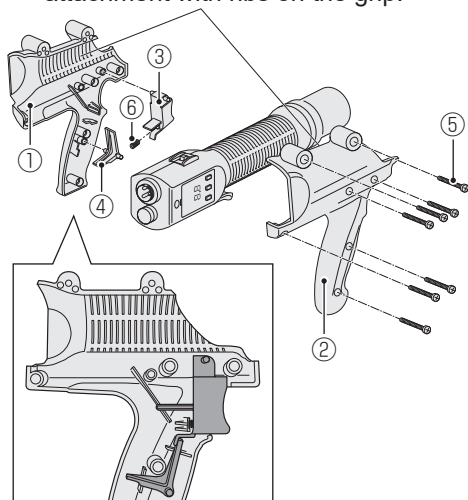

Components of the attachment

①	Grip attachment (A) x 1
②	Grip attachment (B) x 1
③	Trigger x 1
④	Joint x 1
⑤	Screw x 7
⑥	Spring x 1

ATTENTION

- When attaching or removing the grip attachment, set the forward/reverse lever to the “○ (Trigger switch locked)” position, and turn OFF the power switch of the power adapter. **P. 13, 16**
- Remove the bit before attaching or removing the grip attachment.
- After fixing the grip attachment with screws, check for any loose screws, backlash, or misalignment.

- 1** Align grooves in the grip attachment (A) with ribs on the tool grip.
- 2** Attach the trigger and the joint to the positions shown in the figure.
- 3** Align grooves in the grip attachment (B) with ribs on the tool grip.
- 4** Fasten the screws. Check for any loose screws, backlash, or misalignment.

Screwdriver hanger mounting hole (x 2)

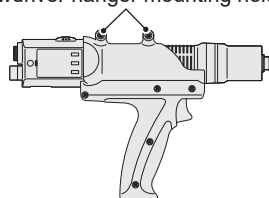

PREPARATION BEFORE USE (cont.)

Connecting to Power Supply

ATTENTION

- Before connection, set the forward/reverse lever to the “○” position to lock the trigger switch. **P. 13**
- Use only our power supply (screwdriver cord, power adapter, and power cord). Also, do not use the power supply or cord designed specifically to this unit to operate other devices.
- When not using the tool for a long time, you are recommended to disconnect the power cord from the outlet. This unit consumes power even while it is turned off.

1 Connect the screwdriver cord to the power adapter and this unit.

Check the orientation of the connector and attach it correctly. Fix it with a joint ring.

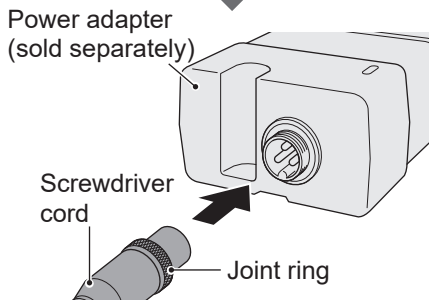
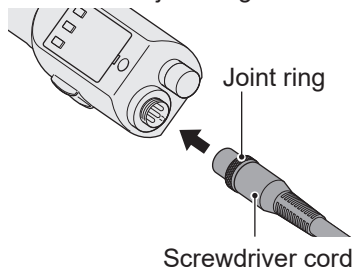

2 Attach the power cord to the power adapter.

Power adapter (sold separately)

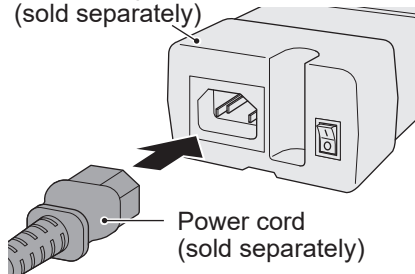

3 Check that the power switch of the power adapter is OFF.

When the power supply is OFF, the power lamp is off.

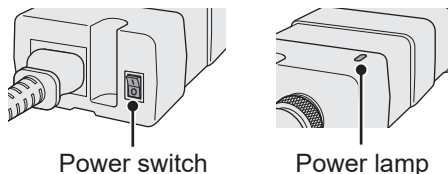

4 Connect the power plug to the outlet.

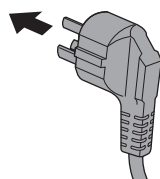

Example: For China

5 Turn ON the power switch of the power adapter.

The power lamp lights up green.

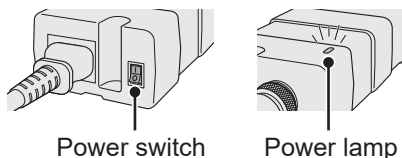

Switching Start Modes

This unit has two modes for rotation start.

Switch them according to the work before use.

(The factory default is lever start mode.)

Switching to Lever Start Mode

- 1 Set the forward/reverse lever to the “○” position.**

The trigger switch gets locked.

P. 13

- 2 Keep the lever depressed (for approximately 5 seconds) until the detection lamp lights up in yellow (for approximately 1 second).**

Then, the buzzer emits three short beep sounds.

What is lever start mode?

Rotation starts when you pull the lever. Rotation stops when you release the lever.

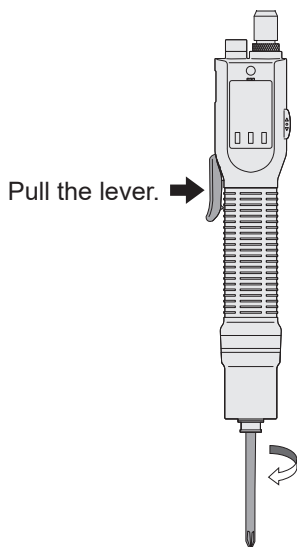

Switching to Push Start Mode

- 1 Set the forward/reverse lever to the “○” position.**

The trigger switch gets locked.

P. 13

- 2 Press the bit end against a work table or the like (for approximately 5 seconds) until the detection lamp lights up in yellow (for approximately 1 second).**

Wait for a moment with the bit holder slightly sunk.

Then, the buzzer emits three short beep sounds.

What is push start mode?

Rotation starts when you push the Electric Screwdriver toward the bit.

Rotation stops when you stop pushing.

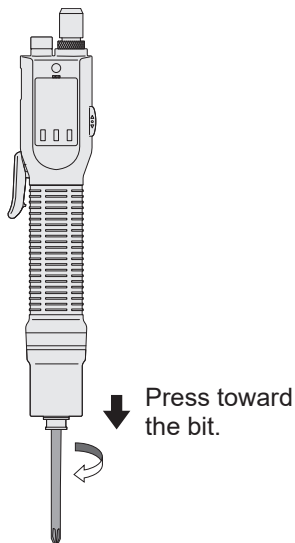

NOTE

- Only the selected start mode is enabled. The unselected start mode is disabled.

HOW TO USE (cont.)

NOTE

- The lever trigger switch can be removed as shown in the following figure.

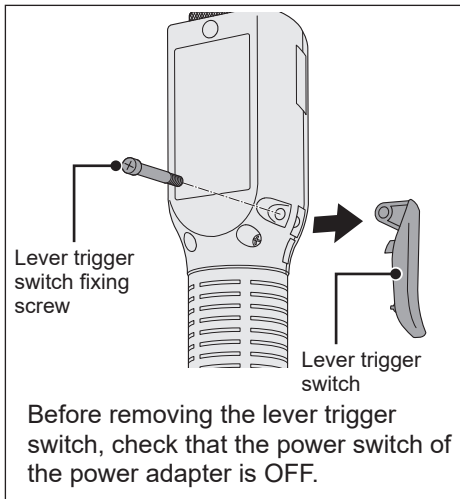

Setting Fastening Torque

According to the work, the clutch torque can be adjusted in 96 steps.

■ Setting Procedure

- 1 Remove the clutch cover.**
Turn the clutch cover anticlockwise.

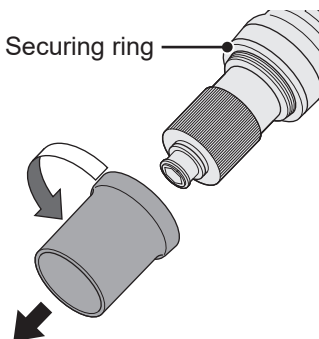

- 2 Adjust the torque with the clutch handle.**

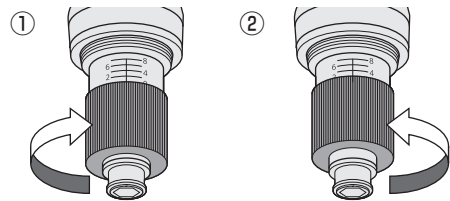

- ① To increase the output torque, turn the clutch handle clockwise.
- ② To decrease the output torque, turn the clutch handle anticlockwise.

To ensure long and safe use without causing any failure, observe the following:

- Set the torque according to the recommended fastening torque chart. **P. 19**
- Do not use the tool in such a manner that causes the motor to lock.

- 3 Attach the clutch cover.**
Turn the clutch cover clockwise.

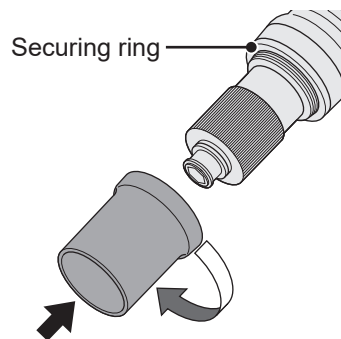

ATTENTION

- Attach the clutch cover during use so as to prevent the clutch setting from being changed unintentionally.
- Fasten the securing ring if it is loose.

Recommended Fastening Torque Chart (Reference Values)

These data are reference values measured under the following measurement conditions.

In actual work, they vary depending on the surrounding conditions (such as screws, materials, and fixing methods).

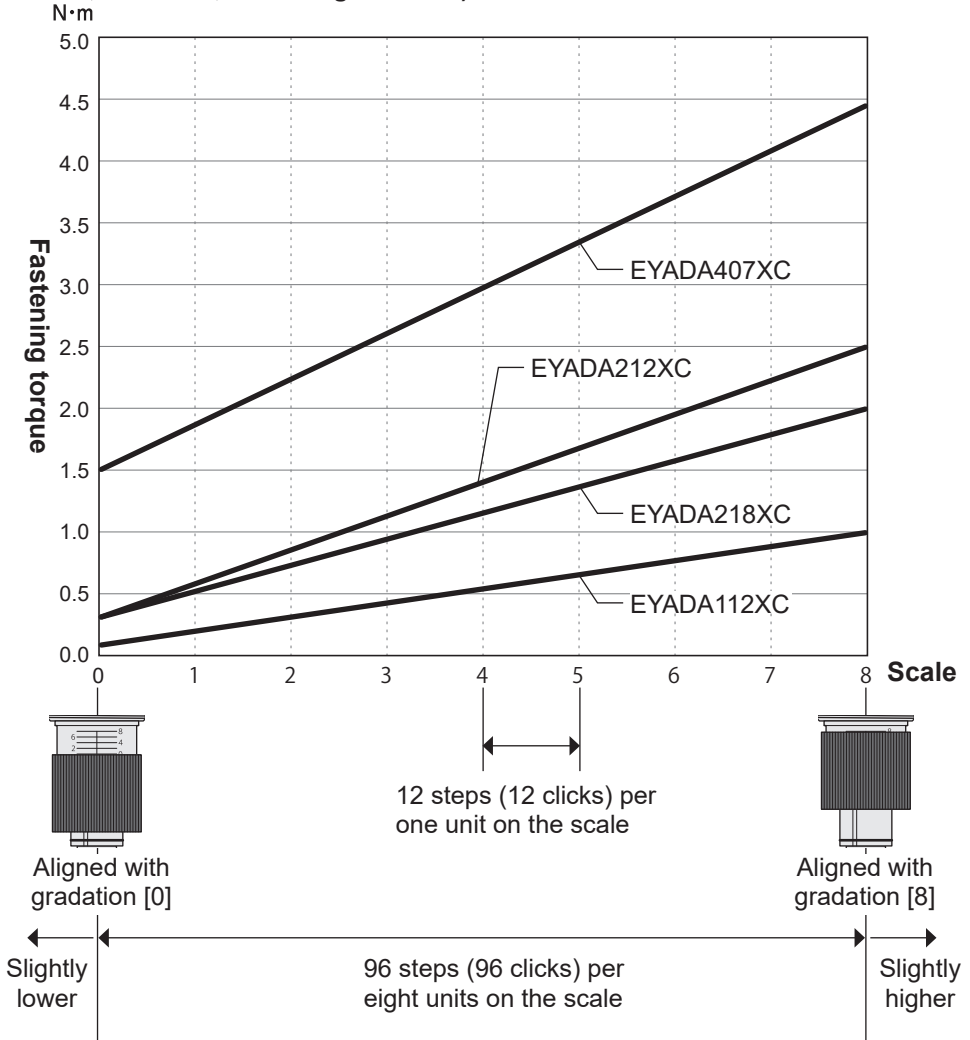

Measurement conditions	Based on our specified measurement conditions.
-------------------------------	--

* In actual work, they vary depending on the surrounding conditions (such as screws, materials, and fixing methods). You are recommended to make a prior confirmation in actual work.

HOW TO USE (cont.)

Starting Work

1 Set the rotation direction with the forward/reverse lever.

When you set it to the “F” position and the “R” position, the motor rotates forward (clockwise) and reverses (anticlockwise) respectively.

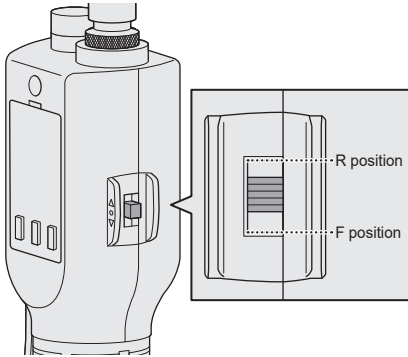

Forward (Clockwise)

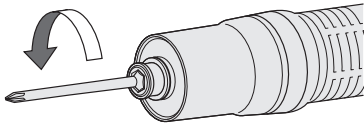

Reverse (Anticlockwise)

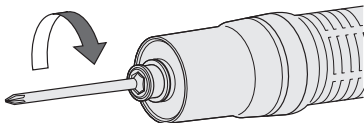

NOTE

- If the forward/reverse lever is switched while the motor is in action, the motor is forcibly stopped to rotate.

2 Start rotation.

In “lever start” mode, pull the lever.
In “push start” mode, push toward the bit.

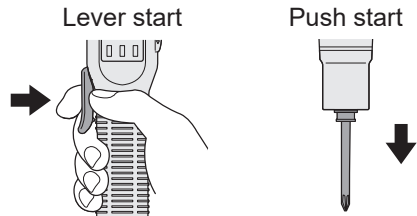

- There may be a slight delay in the rotation startup at the start, but it is not a failure.
- In case of quick ON/OFF, the rotation startup will be late a little for that.
- You can select “lever start” or “push start” for start mode. **P. 17**

Checking Fastening Status

This unit notifies you of the work status with a buzzer and the detection lamp.

Fastening OK

When the clutch activates and the screw is normally fastened, the buzzer emits a short beep and the detection lamp lights up in green to tell you that the screw has been normally fastened.

You can also use the rotation time in combination as determination criteria.

- The detection conditions can be changed in the menu. **P. 35**
- The lighting colour of the lamp can be changed in the menu. **P. 39**

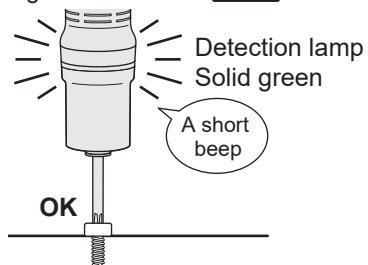

■ Count-up (Count finished)

The number of fastened screws determined as OK has reached the set count quantity.

With a buzzer (a long beep) and the blue detection lamp, you are notified that the set number of screws has been fastened successfully.

- Set the count quantity. **P. 25**
- The lighting colour of the lamp can be changed in the menu. **P. 39**
- The buzzer pattern can be changed in the menu. **P. 39**
- The buzzer (volume) can be changed in the menu. **P. 40**

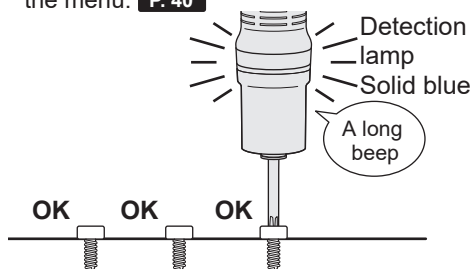

■ Fastening NG (NOK)

The tool has stopped without the clutch activated not satisfying the determination criteria.

The buzzer emits a buzz and the detection lamp lights up in red to tell you that the screw has not been properly fastened.

- Pressing the OK button will clear the error display.
- The lighting pattern of the lamp can be changed in the menu. **P. 40**

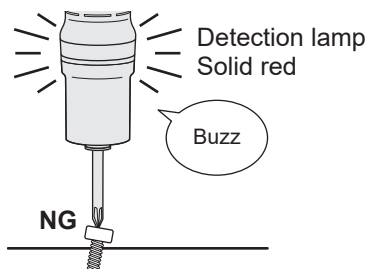

Finishing Work

1 Set the forward/reverse lever to the trigger switch lock position.

Set it to the "○" position.

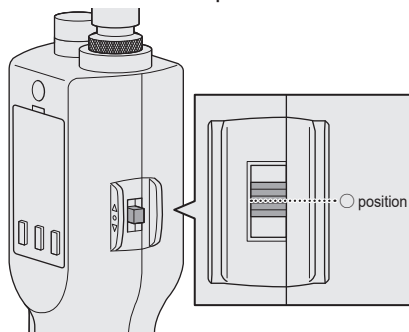

2 Turn OFF the power switch of the power adapter, or disconnect the power plug from the outlet.

Turn OFF the power switch.

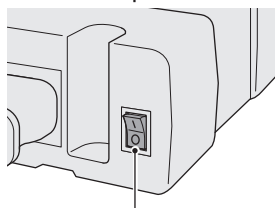

Power switch

Disconnect the power plug from the outlet.

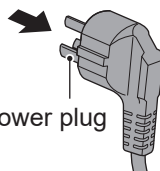

Power plug

Example: For China

SETTING FUNCTIONS OF TOOL (SETTING MODE)

1. Switching to Setting Mode

This unit can change settings according to the work.
To change settings, switch to setting mode.

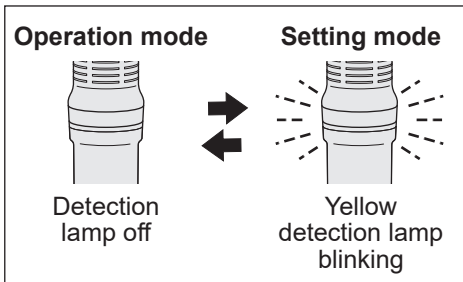

Switching to Setting Mode

1 Set the forward/reverse lever to the trigger switch lock position.

Set it to the "○" position.

2 Hold down the OK button.

A buzzer sounds short twice (two short beeps), and the detection lamp blinks yellow.

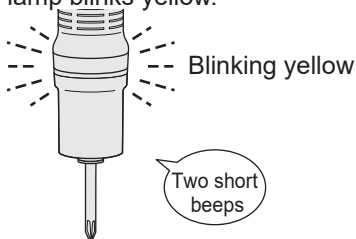

Back to Operation Mode

1 Hold down the OK button while you are in setting mode (the detection lamp is blinking yellow).

A buzzer sounds short three times (three short beeps), and the detection lamp turns off.

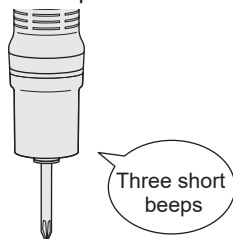

2 Release the forward/reverse lever from the trigger switch lock position.

When you set it to the F position and the R position, the motor rotates forward (clockwise) and reverses (anticlockwise) respectively.

2. Selecting Menu

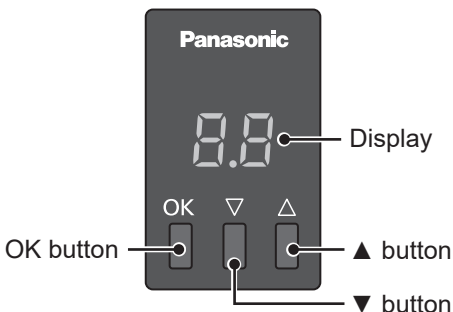

You can select a menu by pressing the ▼ and ▲ buttons while you are in setting mode.

A menu to be selected appears on the display.

Press the OK button to confirm the selected menu.

To Utility Menu (u + Number)



■ Count Menu (c + Number)

Display	Description	Reference page
c 1	Count Quantity Setting	25
c 2	Count Method Setting	26
c 3	Count Return Setting	27
c 4	Quantity Reset Permission Setting	28
c 5	Ignore Judgement Time Setting	29
c 6	Ignore Count Time Setting	30
c 7	Batch Complete Judgement Waiting Time Setting	31



■ Basic Setting Menu (b + Number)

Display	Description	Reference page
b 1	Brake Setting	41
b 2	External-Output Signal Setting	41
b 3	External-Input Drive Permission Setting	42
b 4	Tool Reset Permission Setting	43



■ Notification Menu (n + Number)

Display	Description	Reference page
n 1	Lamp Lighting Colour Setting	39
n 2	Buzzer Pattern Setting	39
n 3	Lamp Lighting Pattern Setting	40
n 4	Buzzer (Volume) Setting	40



■ Utility Menu (u + Number)

Display	Description	Reference page
u 1	Soft Start & Soft Snug Time Setting	32
u 2	Soft Start Speed Level Setting	33
u 3	Soft Snug Speed Level Setting	34
u 4	Rotation Time-based Detection Setting	35
u 5	Automatic Rotation Stop Setting	36
u 6	Disable Fastening Time Setting	37
u 7	Stopwatch Mode	38



To Count Menu (c + Number)

Tool Reset (Initialisation Setting)

Put the tool settings back to the manufacturer default settings.

To enable this function, set “**b4** Tool Reset Permission Setting” to “_1”. **P. 43**

■ Setting Procedure

- 1 Switch to setting mode.**
Set the forward/reverse lever to the trigger switch lock position, and hold down the OK button.
For details, see **P. 22**.

- 2 Hold down the OK button, ▼ button, and ▲ button at the same time.**
A buzzer sounds long (a long beep), and “--” appears on the display.
The detection lamp turns off.

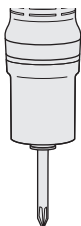
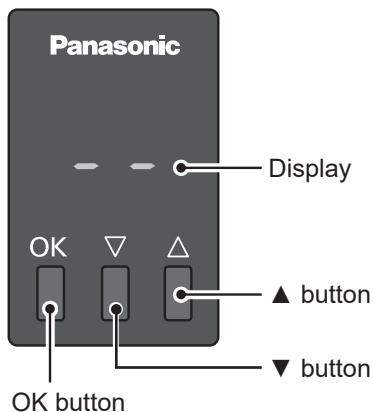

A long beep

COUNT MENU (c + NUMBER)

c1 Count Quantity Setting

The number of screws to fasten is set.

The number of fastened screws determined as OK is counted, and when it reaches the set quantity, you are notified of that with a buzzer and the lighting detection lamp. **P. 20, 21**

- The count quantity appears on the tool display in operation mode.
- When it reaches the set quantity, the count on the display will be reset.

When it is set to "3"

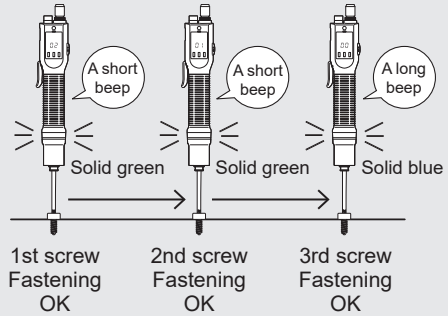

Setting Procedure

- 1 Switch to setting mode.**
Set the forward/reverse lever to the trigger switch lock position, and hold down the OK button. **P. 22**
- 2 Choose "c1" by pressing the ▲ and ▼ buttons, and press the OK button.**
A set value appears on the display.
- 3 Select a desired one by pressing the ▲ and ▼ buttons.**
The default is "- -".

Display	Count quantity
- -	OFF
0 1	1 screw
}	}
9 9	99 screws

- 4 Press the OK button to confirm it.**
When the setting is completed, a buzzer sounds long (a long beep), and the display returns to the menu screen.
- 5 Back to Operation Mode.**
Hold down the OK button. **P. 22**

COUNT MENU (c + NUMBER) (cont.)

c2 Count Method Setting

You can switch count methods for screw fastening.

Count-down mode

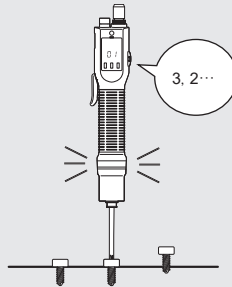

Count-up mode

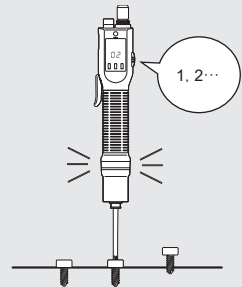

Setting Procedure

- 1 Switch to setting mode.**
Set the forward/reverse lever to the trigger switch lock position, and hold down the OK button. **P. 22**
- 2 Choose "c2" by pressing the ▲ and ▼ buttons, and press the OK button.**
A set value appears on the display.
- 3 Select a desired one by pressing the ▲ and ▼ buttons.**
The default is "_1".

Display	Count method
	Count down (The number of fastened screws is counted from the set value down to 0.)
	Count up (The number of fastened screws is counted from 0 up to the set value.)

- 4 Press the OK button to confirm it.**
When the setting is completed, a buzzer sounds long (a long beep), and the display returns to the menu screen.
- 5 Back to Operation Mode.**
Hold down the OK button. **P. 22**

c3 Count Return Setting

You can set how fastened screws determined as OK are counted when reversing rotations to redo or loosen them.

When it is set to “_1”

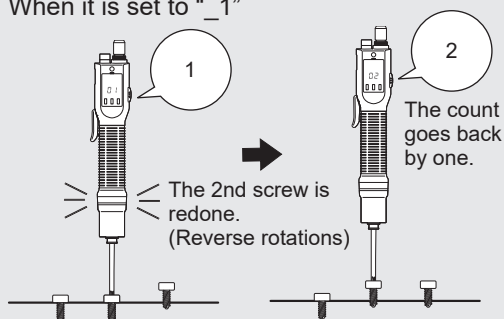

Setting Procedure

1 Switch to setting mode.
Set the forward/reverse lever to the trigger switch lock position, and hold down the OK button. **P. 22**

2 Choose “c3” by pressing the ▲ and ▼ buttons, and press the OK button.
A set value appears on the display.

3 Select a desired one by pressing the ▲ and ▼ buttons.
The default is “_1”.

Display	Count return
	OFF (Reverse rotations are not counted.)
	Return 1 count* (The count is put back by reverse rotations.)
	Return to start (The count is reset by reverse rotations.)

* In a state where no screws are fastened, reverse rotations will not cause the count to go back beyond the default.

* To reverse the rotation when the number of screws set through the count quantity is reached, set a waiting time through “**c7** Batch Complete Judgement Waiting Time Setting”.

P. 31

4 Press the OK button to confirm it.

When the setting is completed, a buzzer sounds long (a long beep), and the display returns to the menu screen.

5 Back to Operation Mode.
Hold down the OK button.

P. 22

c4 Quantity Reset Permission Setting

A manual reset of the count quantity is permitted.

When it is set to “_1”, you can reset the count by holding down the ▼ and ▲ buttons at the same time, without having to wait for the end of the quantity specified in the count quantity setting.

When it is set to “_1”

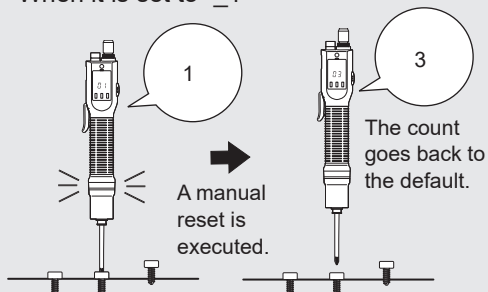

Setting Procedure

1 Switch to setting mode.
Set the forward/reverse lever to the trigger switch lock position, and hold down the OK button. **P. 22**

2 Choose “c4” by pressing the ▲ and ▼ buttons, and press the OK button.
A set value appears on the display.

3 Select a desired one by pressing the ▲ and ▼ buttons.
The default is “_1”.

Display	Quantity reset permission
- -	Not permitted (Manual reset disabled)
- 1	Permitted (The manual reset is permitted. To execute the manual reset, hold down the ▼ and ▲ buttons at the same time.)

4 Press the OK button to confirm it.
When the setting is completed, a buzzer sounds long (a long beep), and the display returns to the menu screen.

5 Back to Operation Mode.
Hold down the OK button. **P. 22**

c5 Ignore Judgement Time Setting

You can exclude unexpected rotations that are unrelated to work, such as brief idling and screw hole alignment in push start mode, from detection. Set the duration of rotations to exclude from detection.

When it is set to “0.3”

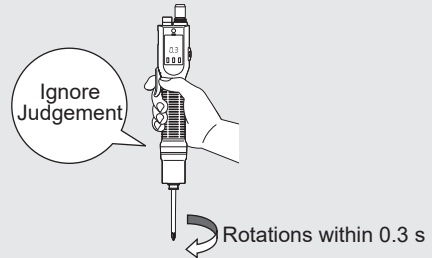

Rotations within 0.3 s are excluded from fastening detection.

Setting Procedure

- 1 Switch to setting mode.**
Set the forward/reverse lever to the trigger switch lock position, and hold down the OK button. **P. 22**
- 2 Choose “c5” by pressing the ▲ and ▼ buttons, and press the OK button.**
A set value appears on the display.
- 3 Select a desired one by pressing the ▲ and ▼ buttons.**
The default is “-.-”.

Display	Ignore judgement time
-.-	OFF
0.1	0.1 s
}	}
9.9	9.9 s

- 4 Press the OK button to confirm it.**
When the setting is completed, a buzzer sounds long (a long beep), and the display returns to the menu screen.
- 5 Back to Operation Mode.**
Hold down the OK button. **P. 22**

c6 Ignore Count Time Setting

You can set screws not to be counted even if they are fastened again after being determined as OK. Set the duration of fastening to exclude from counting after fastening is determined as OK.

- Counting is still enabled when you reverse rotations to redo or loosen screws.
- When both the “**c6** Ignore Count Time Setting” and the “**u6** Disable Fastening Time Setting” are enabled, the “**u6** Disable Fastening Time Setting” takes precedence. **P. 37**

Fastening OK

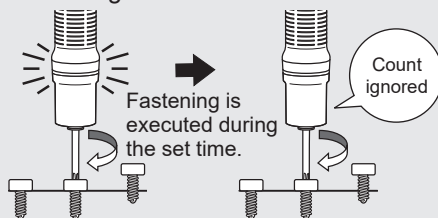

After being determined as OK, screws will not be counted during the time to ignore counting even if they are fastened again.

Setting Procedure

1 Switch to setting mode.
Set the forward/reverse lever to the trigger switch lock position, and hold down the OK button. **P. 22**

2 Choose “c6” by pressing the ▲ and ▼ buttons, and press the OK button.
A set value appears on the display.

3 Select a desired one by pressing the ▲ and ▼ buttons.
The default is “-.-”.

Display	Ignore count time
-.-	OFF
0.1	0.1 s
}	}
9.9	9.9 s

4 Press the OK button to confirm it.
When the setting is completed, a buzzer sounds long (a long beep), and the display returns to the menu screen.

5 Back to Operation Mode.
Hold down the OK button. **P. 22**

c7 Batch Complete Judgement Waiting Time Setting

You can set the waiting time from when the last screw fastening is determined as OK to when it is determined as count-up (count complete).

During the set waiting time, you can reverse rotations after finishing the last screw set in the count quantity.

- Forward rotations are not allowed during the waiting time.

When it is set to “3.0”

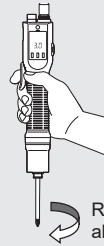

Reverse rotations are allowed for 3.0 s.

After the last screw fastening is determined as OK, no count-up will occur for 3.0 s, allowing you to reverse rotations to redo or loosen screws.

■ Setting Procedure

- 1 Switch to setting mode.**
Set the forward/reverse lever to the trigger switch lock position, and hold down the OK button. **P. 22**
- 2 Choose “c7” by pressing the ▲ and ▼ buttons, and press the OK button.**
A set value appears on the display.
- 3 Select a desired one by pressing the ▲ and ▼ buttons.**
The default is “-.-”.

Display	Batch complete judgement waiting time
-.-	OFF
0.1	0.1 s
}	}
9.9	9.9 s

- 4 Press the OK button to confirm it.**
When the setting is completed, a buzzer sounds long (a long beep), and the display returns to the menu screen.
- 5 Back to Operation Mode.**
Hold down the OK button. **P. 22**

UTILITY MENU (u + NUMBER)

u1 Soft Start & Soft Snug Time Setting

The duration of soft start and the start time of soft snug can be set.

The speed of soft start and the speed of soft snug should be set in “u2 Soft Start Speed Level Setting” and “u3 Soft Snug Speed Level Setting” respectively.

P. 33, 34

- The start time of the soft snug must not be shorter than the duration of the soft start.

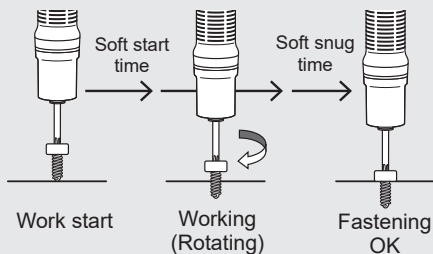

What is soft start?

In order to prevent cross threading and screw galling, initially a screw is rotated slowly at the beginning of fastening.

What is soft snug?

In order to prevent bit detachment and minimize the impact on the base material, the bit is rotated slowly before snugging.

Setting Procedure

1 Switch to setting mode.
Set the forward/reverse lever to the trigger switch lock position, and hold down the OK button. **P. 22**

2 Choose “u1” by pressing the ▲ and ▼ buttons, and press the OK button.
A set value appears on the display.

3 Select a desired one by pressing the ▲ and ▼ buttons.
The **duration of soft start** can be set. The default is “-.-”. If soft start is unnecessary, set it to “-.-”.

Display	Soft start duration
-.-	OFF
0.1	0.1 s
}	}
9.9	9.9 s

4 Press the OK button to confirm it.
When the setting is completed, a buzzer sounds long (a long beep).

5 Select a desired one by pressing the ▲ and ▼ buttons.
The **start time of soft snug** can be set. The default is “-.-”. If soft snug is unnecessary, set it to “-.-”.

Display	Soft snug start time
-.-	OFF
0.1	0.1 s
}	}
9.9	9.9 s

6 Press the OK button to confirm it.
When the setting is completed, a buzzer sounds long (a long beep), and the display returns to the menu screen.

The speed level should be set in “u2” for soft start and in “u3” for soft snug.

7 Back to Operation Mode.
Hold down the OK button. **P. 22**

u2 Soft Start Speed Level Setting

The speed of soft start can be set.
The duration of soft start should be set in “**u1** Soft Start & Soft Snug Time Setting”. **P. 32**

- Because of the structure of the motor, it requires some time to increase the speed of the soft start to the normal speed.

When it is set to “04”

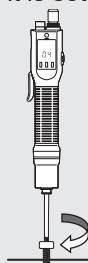

During the time set in soft start, a screw is fastened slowly at about 50% of the maximum speed.

Setting Procedure

- 1 Switch to setting mode.**
Set the forward/reverse lever to the trigger switch lock position, and hold down the OK button. **P. 22**
- 2 Choose “u2” by pressing the ▲ and ▼ buttons, and press the OK button.**
A set value appears on the display.
- 3 Select a desired one by pressing the ▲ and ▼ buttons.**
The default is “10”.
- 4 Press the OK button to confirm it.**
When the setting is completed, a buzzer sounds long (a long beep), and the display returns to the menu screen.
- 5 Back to Operation Mode.**
Hold down the OK button. **P. 22**

Soft start speed level (Rotations/minute)

	Level1	Level2	Level3	Level4	Level5
Display	01	02	03	04	05
EYADA112XC	300	400	500	600	700
EYADA212XC	300	400	500	600	700
EYADA218XC	450	600	750	900	1050
EYADA407XC	160	220	270	330	380
* Relative to the maximum number of rotations	About 25%			About 50%	

	Level6	Level7	Level8	Level9	Level10
Display	06	07	08	09	10
EYADA112XC	800	900	1000	1100	1200
EYADA212XC	800	900	1000	1100	1200
EYADA218XC	1200	1350	1500	1650	1800
EYADA407XC	430	490	540	600	650
* Relative to the maximum number of rotations		About 75%			About 100%

- The values (numbers of rotations) are only guidelines.

UTILITY MENU (u + NUMBER) (cont.)

U3 Soft Snug Speed Level Setting

The speed of soft snug can be set.

The start time of soft snug should be set in “[u1] Soft Start & Soft Snug Time Setting”.

P. 32

- Because of the structure of the motor, it requires some time to decrease the normal speed to the speed of soft snug.

When it is set to “04”

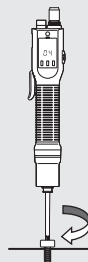

During the time set for soft snug, a screw is fastened slowly at about 50% of the maximum speed.

Setting Procedure

1 Switch to setting mode.

Set the forward/reverse lever to the trigger switch lock position, and hold down the OK button. **P. 22**

2 Choose “u3” by pressing the ▲ and ▼ buttons, and press the OK button.

A set value appears on the display.

3 Select a desired one by pressing the ▲ and ▼ buttons. The default is “10”.

4 Press the OK button to confirm it.

When the setting is completed, a buzzer sounds long (a long beep), and the display returns to the menu screen.

5 Back to Operation Mode.

Hold down the OK button. **P. 22**

Soft snug speed level (Rotations/minute)

	Level1	Level2	Level3	Level4	Level5
Display	01	02	03	04	05
EYADA112XC	300	400	500	600	700
EYADA212XC	300	400	500	600	700
EYADA218XC	450	600	750	900	1050
EYADA407XC	160	220	270	330	380
* Relative to the maximum number of rotations	About 25%			About 50%	

	Level6	Level7	Level8	Level9	Level10
Display	06	07	08	09	10
EYADA112XC	800	900	1000	1100	1200
EYADA212XC	800	900	1000	1100	1200
EYADA218XC	1200	1350	1500	1650	1800
EYADA407XC	430	490	540	600	650
* Relative to the maximum number of rotations		About 75%			About 100%

- The values (numbers of rotations) are only guidelines.

u4 Rotation Time-based Detection Setting

You can determine whether or not a screw is properly fastened based on the rotation time taken to fasten the screw. Set the lower and upper limits for the fastening time to be determined as OK. The optimum rotation time can be measured in “u7 Stopwatch Mode”.

P. 38

- The lower limit setting must not be higher than the upper limit setting.

When the lower limit and the upper limit are set to 0.3 and 0.6 respectively

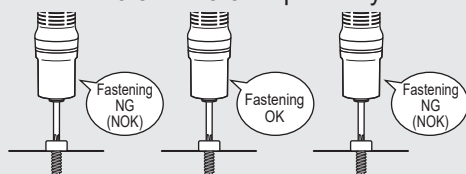

Snugs in 0.1 s Snugs in 0.5 s Snugs in 0.8 s

Fastening is determined as OK when the rotation time is between 0.3 s and 0.6 s before snugging.

Setting Procedure

- Switch to setting mode.**
Set the forward/reverse lever to the trigger switch lock position, and hold down the OK button. P. 22
- Choose “u4” by pressing the ▲ and ▼ buttons, and press the OK button.**
A set value appears on the display.
- Select a desired one by pressing the ▲ and ▼ buttons.**
The **lower limit** of the rotation time can be set.
The default is “-.-”.
If detection based on the lower limit is unnecessary, set it to “-.-”.

Display	Rotation detection time (Min)
-.-	OFF
0.1	0.1 s
}	}
9.9	9.9 s

- Press the OK button to confirm it.**
When the setting is completed, a buzzer sounds long (a long beep).

- Select a desired one by pressing the ▲ and ▼ buttons.**
The **upper limit** of the rotation time can be set. The default is “-.-”.
If detection based on the upper limit is unnecessary, set it to “-.-”.

Display	Rotation detection time (Max)
-.-	OFF
0.1	0.1 s
}	}
9.9	9.9 s

- Press the OK button to confirm it.**
When the setting is completed, a buzzer sounds long (a long beep), and the display returns to the menu screen.

- Back to Operation Mode.**
Hold down the OK button. P. 22

u5 Automatic Rotation Stop Setting

Rotation can be stopped automatically after the set time has passed.

This is effective in a process where it is necessary to stop rotation without snugging screws or in a process where there is a concern about the penetration of long screws due to screw mix-ups.

- The upper limit of the rotation time should be set in “[u4] Rotation Time-based Detection Setting”. **P. 35**
- When the rotation time reaches its upper limit, rotations stop without clutch activation. Screw fastening is not detected, and the detection lamp does not light up.

Also, no work data history is retained.

When it is set to “_1”

* The upper limit is set to 0.6 in “[u4] Rotation Time-based Detection Setting”.

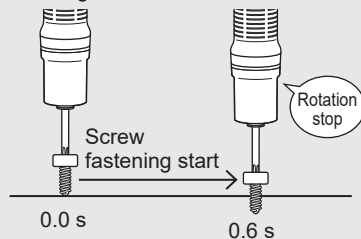

Rotation stops when the rotation time before snugging reaches 0.6 s.

Setting Procedure

1 Switch to setting mode.
Set the forward/reverse lever to the trigger switch lock position, and hold down the OK button. **P. 22**

2 Choose “u5” by pressing the ▲ and ▼ buttons, and press the OK button.
A set value appears on the display.

3 Select a desired one by pressing the ▲ and ▼ buttons.
The default is “_ _”.

Display	Automatic Rotation Stop
_ _	OFF
_ 1	ON

4 Press the OK button to confirm it.
When the setting is completed, a buzzer sounds long (a long beep), and the display returns to the menu screen.

The upper limit of the rotation time should be set in “[u4] Rotation Time-based Detection Setting”.

5 Back to Operation Mode.
Hold down the OK button. **P. 22**

u6 Disable Fastening Time Setting

You can set the tool not to start during the set time after fastening is determined as OK.

- When both the “[c6] Ignore Count Time Setting” and the “[u6] Disable Fastening Time Setting” are enabled, the “[u6] Disable Fastening Time Setting” takes precedence.

P. 30

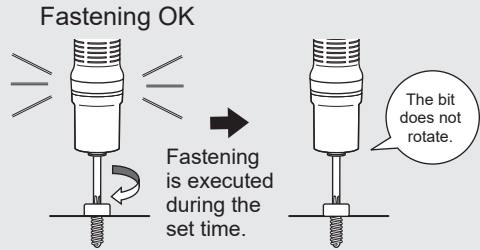

After fastening is determined as OK, the Electric Screwdriver does not start during the time set in the Disable Fastening Time Setting.

Setting Procedure

- 1 Switch to setting mode.**
Set the forward/reverse lever to the trigger switch lock position, and hold down the OK button. **P. 22**
- 2 Choose “u6” by pressing the ▲ and ▼ buttons, and press the OK button.**
A set value appears on the display.
- 3 Select a desired one by pressing the ▲ and ▼ buttons.**
The default is “0.5”.

Display	Disable fastening time
0.5	0.5 s
}	}
9.9	9.9 s

- 4 Press the OK button to confirm it.**
When the setting is completed, a buzzer sounds long (a long beep), and the display returns to the menu screen.
- 5 Back to Operation Mode.**
Hold down the OK button. **P. 22**

u7 Stopwatch Mode

You can measure the maximum and minimum values of the rotation time of screw fastening. Perform several measurements because there are variations in the measured values due to screw length and rotation speed.

- In stopwatch mode, fastening detection is disabled.
- Even while you are in stopwatch mode, you can configure settings in the utility menu.
- To exit stopwatch mode, set it to “__” again.

In stopwatch mode, the screw fastening time (in seconds) is displayed on the display.

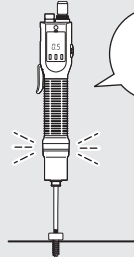

While you are in stopwatch mode, the detection lamp blinks cyan.

Operations while you are in stopwatch mode

- ▲ button: Displays the maximum value of rotation time.
- ▼ button: Displays the minimum value of rotation time.
- OK button: Redisplays the latest measured data.
- ▲ button held down: Resets the maximum and minimum values.
- ▼ button held down: Deletes the previous data.

Setting Procedure

- 1 Switch to setting mode.**
Set the forward/reverse lever to the trigger switch lock position, and hold down the OK button. **P. 22**
- 2 Choose “u7” by pressing the ▲ and ▼ buttons, and press the OK button.**
A set value appears on the display.
- 3 Select a desired one by pressing the ▲ and ▼ buttons.**
The default is “__”.

Display	Stopwatch Mode
— —	OFF
—	ON

- 4 Press the OK button to confirm it.**
When the setting is completed, a buzzer sounds long (a long beep), and the display returns to the menu screen.
- 5 Back to Operation Mode.**
Hold down the OK button. **P. 22**

NOTIFICATION MENU (n + NUMBER)

n1 Lamp Lighting Colour Setting

You can set the lighting colour of the detection lamp.

■ Setting Procedure

- 1 Switch to setting mode.**
Set the forward/reverse lever to the trigger switch lock position, and hold down the OK button. **P. 22**
- 2 Choose “n1” by pressing the ▲ and ▼ buttons, and press the OK button.**
A set value appears on the display.
- 3 Select a desired one by pressing the ▲ and ▼ buttons.**
The default is “_1”.

Display	Lamp lighting colour
	OFF (Off)
	Fastening OK: Green Count-up (Count complete): Blue
	Fastening OK: Blue Count-up (Count complete): Green

- 4 Press the OK button to confirm it.**
When the setting is completed, a buzzer sounds long (a long beep), and the display returns to the menu screen.
- 5 Back to Operation Mode.**
Hold down the OK button. **P. 22**

n2 Buzzer Pattern Setting

You can set the buzzer pattern for count-up (count complete).

■ Setting Procedure

- 1 Switch to setting mode.**
Set the forward/reverse lever to the trigger switch lock position, and hold down the OK button. **P. 22**
- 2 Choose “n2” by pressing the ▲ and ▼ buttons, and press the OK button.**
A set value appears on the display.
- 3 Select a desired one by pressing the ▲ and ▼ buttons.**
The default is “_1”.

Display	Buzzer pattern
	A long beep
	Three short beeps

- 4 Press the OK button to confirm it.**
When the setting is completed, a buzzer sounds long (a long beep), and the display returns to the menu screen.
- 5 Back to Operation Mode.**
Hold down the OK button. **P. 22**

NOTIFICATION MENU (n + NUMBER) (cont.)

n3 Lamp Lighting Pattern Setting

You can set the lighting pattern of the detection lamp for fastening NG (NOK) and error occurrence.

Setting Procedure

- 1 Switch to setting mode.**
Set the forward/reverse lever to the trigger switch lock position, and hold down the OK button. **P. 22**
- 2 Choose “n3” by pressing the ▲ and ▼ buttons, and press the OK button.**
A set value appears on the display.
- 3 Select a desired one by pressing the ▲ and ▼ buttons.**
The default is “_1”.

Display	Lamp lighting pattern
	OFF (Off)
	Fastening NG (NOK): Solid red Other errors: Blinking red
	Fastening NG (NOK): Blinking red Other errors: Solid red

- 4 Press the OK button to confirm it.**
When the setting is completed, a buzzer sounds long (a long beep), and the display returns to the menu screen.
- 5 Back to Operation Mode.**
Hold down the OK button. **P. 22**

n4 Buzzer (Volume) Setting

You can set the buzzer (volume).
* This is a common setting for the confirmation sound and operation sound at the time of fastening OK.

Setting Procedure

- 1 Switch to setting mode.**
Set the forward/reverse lever to the trigger switch lock position, and hold down the OK button. **P. 22**
- 2 Choose “n4” by pressing the ▲ and ▼ buttons, and press the OK button.**
A set value appears on the display.
- 3 Select a desired one by pressing the ▲ and ▼ buttons.**
The default is “_2”.

Display	Buzzer (Volume)
	OFF (Mute)
	Low volume
	Medium volume
	High volume

- 4 Press the OK button to confirm it.**
When the setting is completed, a buzzer sounds long (a long beep), and the display returns to the menu screen.
- 5 Back to Operation Mode.**
Hold down the OK button. **P. 22**



BASIC SETTING MENU (b + NUMBER)

b1 Brake Setting

You can enable or disable braking when rotation stops before clutch activation.

■ Setting Procedure

- 1 Switch to setting mode.**
Set the forward/reverse lever to the trigger switch lock position, and hold down the OK button. **P. 22**
- 2 Choose “b1” by pressing the ▲ and ▼ buttons, and press the OK button.**
A set value appears on the display.
- 3 Select a desired one by pressing the ▲ and ▼ buttons.**
The default is “_1”.

Display	Brake
	OFF: Braking disabled (Rotation stops slowly when you release the trigger switch.)
	ON: Braking enabled (Rotation stops immediately when you release the trigger switch.)

- 4 Press the OK button to confirm it.**
When the setting is completed, a buzzer sounds long (a long beep), and the display returns to the menu screen.
- 5 Back to Operation Mode.**
Hold down the OK button. **P. 22**



b2 External-Output Signal Setting

You can select “Count-up signal” or “Fastening NG (NOK) signal”, as the external output signal.

P. 45

■ Setting Procedure

- 1 Switch to setting mode.**
Set the forward/reverse lever to the trigger switch lock position, and hold down the OK button. **P. 22**
- 2 Choose “b2” by pressing the ▲ and ▼ buttons, and press the OK button.**
A set value appears on the display.
- 3 Select a desired one by pressing the ▲ and ▼ buttons.**
The default is “_1”.

Display	External-output signal
	Count-up signal
	Fastening NG (NOK) signal

- 4 Press the OK button to confirm it.**
When the setting is completed, a buzzer sounds long (a long beep), and the display returns to the menu screen.
- 5 Back to Operation Mode.**
Hold down the OK button. **P. 22**

b3 External-Input Drive Permission Setting

When connected to an external device with a communication cable, this unit can be controlled from the external device. **P. 44**

In work where multiple tools are used, you can prevent tool mix-ups by permitting the start only for the tools to use and by disabling the start of tools that are not permitted.

Also, you can make the detection lamp of the Electric Screwdriver being controlled blink or turn off.

When drive permission is given

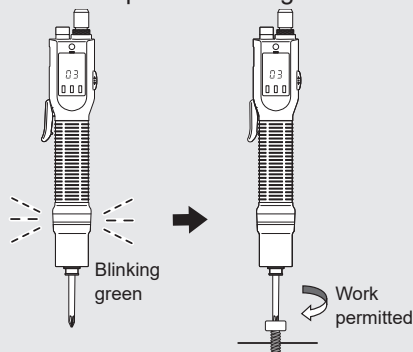

You are notified of the Electric Screwdriver to use, by blinking its detection lamp.

* You can also disable blinking.

When drive permission is not given

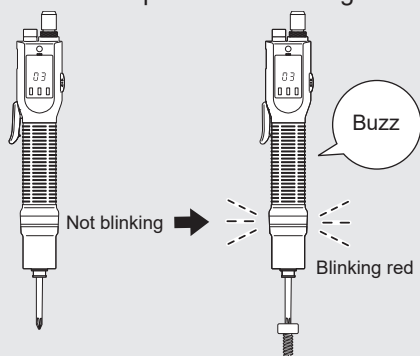

If you use an improper Electric Screwdriver, it will not start and its detection lamp will blink red with a buzzer.

Setting Procedure

- 1 Switch to setting mode.**
Set the forward/reverse lever to the trigger switch lock position, and hold down the OK button. **P. 22**
- 2 Choose “b3” by pressing the ▲ and ▼ buttons, and press the OK button.**
A set value appears on the display.
- 3 Select a desired one by pressing the ▲ and ▼ buttons.**
The default is “_ _”.

Display	External-input drive permission
	OFF (Not permitted)
	ON (Permitted, lamp blinking)
	ON (Permitted, lamp off)

- 4 Press the OK button to confirm it.**
When the setting is completed, a buzzer sounds long (a long beep), and the display returns to the menu screen.
- 5 Back to Operation Mode.**
Hold down the OK button.

P. 22

b4 Tool Reset Permission Setting

A tool reset is permitted.

When you set it to “_1”, you can initialise the tool by holding down the OK button, ▼ button, and ▲ button at the same time in setting mode. **P. 24**

When it is set to “_1”

The set value goes back to the default.

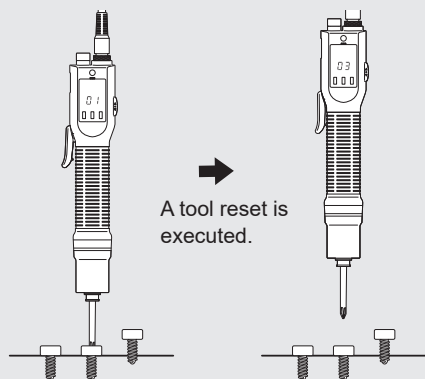

Setting Procedure

- 1 Switch to setting mode.**
Set the forward/reverse lever to the trigger switch lock position, and hold down the OK button. **P. 22**
- 2 Choose “b4” by pressing the ▲ and ▼ buttons, and press the OK button.**
A set value appears on the display.
- 3 Select a desired one by pressing the ▲ and ▼ buttons.**
The default is “_1”.

Display	Tool reset permission
— —	Not permitted (Tool reset disabled)
— 1	Permitted (The tool reset is permitted. To execute the tool reset, hold down the OK button, ▼ button, and ▲ button at the same time.)

- 4 Press the OK button to confirm it.**
When the setting is completed, a buzzer sounds long (a long beep), and the display returns to the menu screen.
- 5 Back to Operation Mode.**
Hold down the OK button. **P. 22**

HOW TO USE COMMUNICATION CABLE

By connecting a separately sold communication cable, you can perform data transmission and reception with external devices such as PLC.

When connecting or disconnecting the cable, turn OFF the power switch of the power adapter.

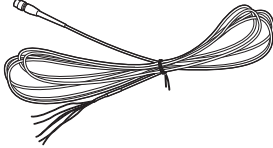

Attaching Communication Cable

- 1 Remove the connector cap.**

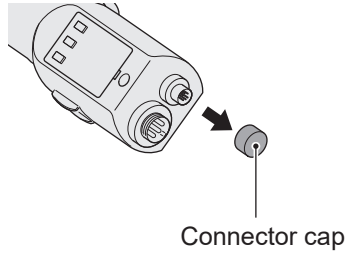

- 2 Check the orientation of the connector, and attach it firmly as far as it will go.**

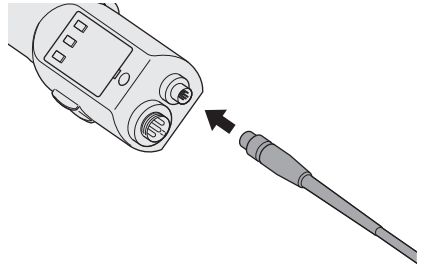

- 3 Tie the cables in a bundle to prevent the communication cable from breaking.**

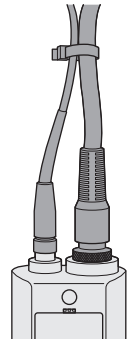

When you connect a communication cable with an external device, also read the Operating Instructions of the external device carefully.

Input/Output Signals

Wire colour	Input/Output	Signal name	Remark
Red	Output	Fastening OK signal	Output when fastening is OK. (Fixed for 0.5 s)
Blue	Output	Fastening NG (NOK) signal	Output when fastening is NG (NOK). (Fixed for 0.5 s)
		Count-up signal	Output when the set count quantity is completed. (Fixed for 0.5 s)
Yellow	Output	Motor forward signal	Output continues in a motor forward state.
Purple	Output	Motor reverse signal	Output continues in a motor reverse state.
Green	Input	Drive permission signal	When “_1” or “_2” is set through “ [b3] External-Input Drive Permission Setting”, the motor is driven only while an ON signal is being input. P. 42
Light blue	—	COM	This terminal is minus common. When applying a voltage, connect it to the negative side.

- Only either one of “Fastening NG (NOK) signal” or “Count-up signal” can be used. Select either one of them through “**[b2]** External-Output Signal Setting”. **P. 41**

Signal Timing

Example of actual work

- Work completed with two screws.
- Loosening is inserted once in between.

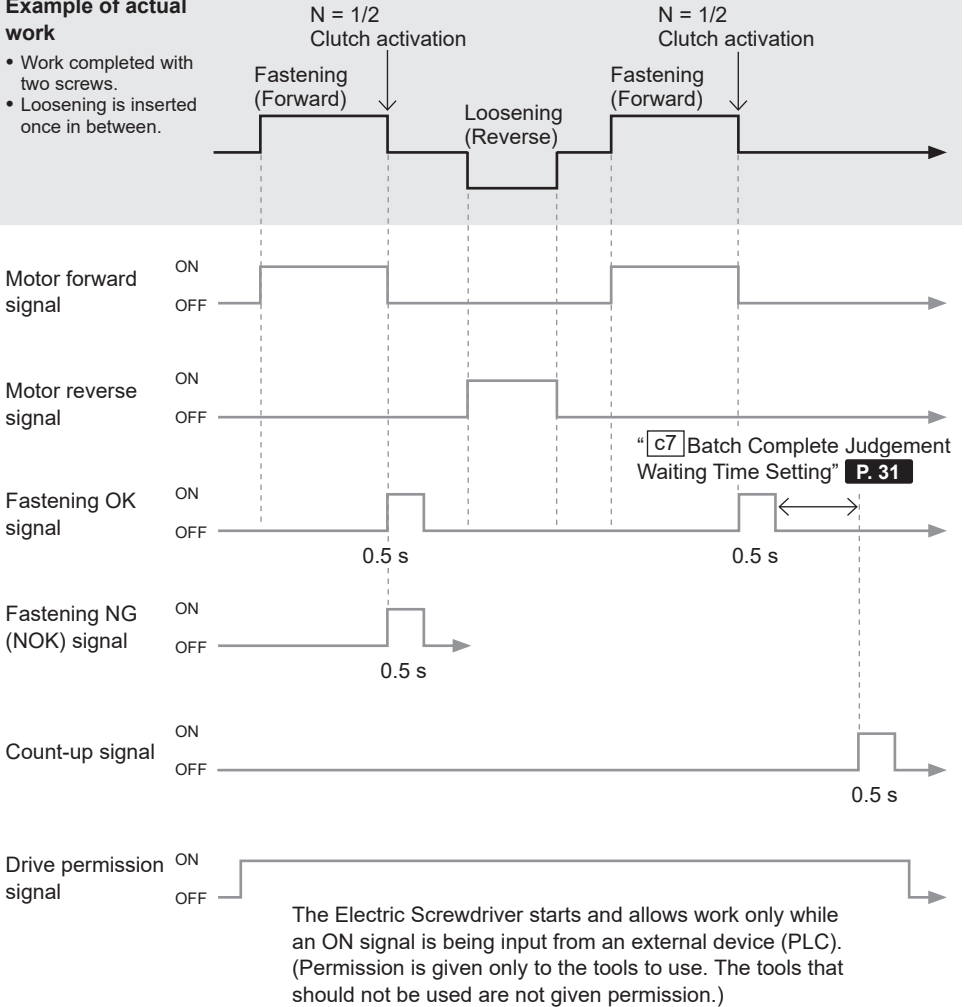

- Only either one of "Fastening NG (NOK) signal" or "Count-up signal" can be used. Select either one of them through "[b2] External-Output Signal Setting". P. 41

Internal Circuit Diagrams

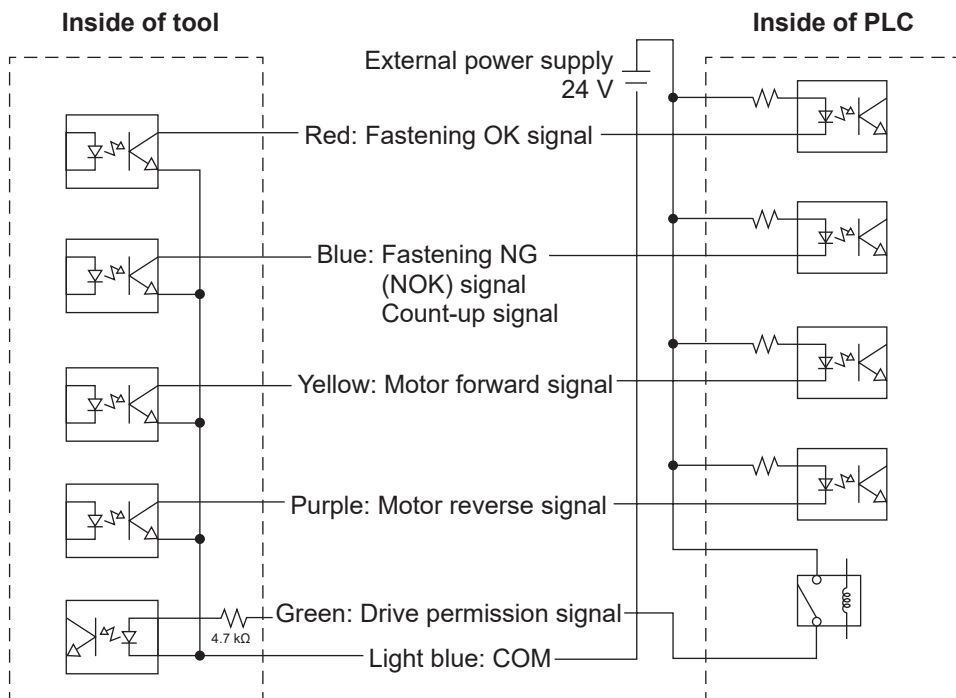

OPERATION

Information

■ Input circuit

- It is a photocoupler input circuit.
- The voltage must be 24 V DC \pm 10%.
- It consumes a current of approximately 5 mA per input.

■ Output circuit

- It is an open collector circuit.
- The voltage must be 24 V DC \pm 10%.
- The peak output current is 20 mA per output.

■ Input/Output circuit

- The absolute maximum ratings are 30 V for voltage and 20 mA for current.

- The output signal wire must be connected only to a PLC (photocoupler input).
- Do not directly connect a power supply to the signal output wire without using a current-limiting resistor.
Doing so breaks the photocoupler.
- Do not directly connect a relay, motor, lamp, or any other device to the signal output wire to drive it.
- Doing so may cause, for example, the surge voltage from the inductive load to break the tool.
- When applying a voltage to the signal output wire using an external power supply, connect the positive side to the input/output wire and the negative side to the COM.
- When no communication cable is connected, the drive permission signal is recognized as OFF.
- Note that when the tool is turned on or off, a signal may be output.

CAPACITY AND SPECIFICATIONS

Tool Capacity

Model No.	EYADA112XC	EYADA212XC	EYADA218XC	EYADA407XC
Recommended Work	Machine screw: M2 to M3.5	Machine screw: M2.5 to M4.5	Machine screw: M2.5 to M4	Machine screw: M3.5 to M5
Torque Setting Range	0.1 N·m to 1.0 N·m	0.3 N·m to 2.5 N·m	0.3 N·m to 2.0 N·m	1.5 N·m to 4.4 N·m
Torque Setting Steps	96 steps			
Fastening Torque Accuracy*	±10%			
Speed	1200 revolutions per minute (10-step adjustment)	1200 revolutions per minute (10-step adjustment)	1800 revolutions per minute (10-step adjustment)	650 revolutions per minute (10-step adjustment)

<Measurement conditions>

Based on our specified measurement conditions.

* Fastening torque and fastening torque accuracy vary depending on the work status. Be sure to check them with actual work before use.

Tool Specifications

Power Supply	Power supplied by power adapter (sold separately) 100 to 240 V AC 50/60 Hz
Motor	Brushless motor (30 V DC)
Bit Holder	One-touch bit locking mechanism Applicable bits (hex shank of 6.35 mm across flats, single-ended 9 mm to 13 mm, double-ended 12 mm to 17.5 mm)
Size (Estimated Dimensions)	Overall Length: 271 mm / Grip diameter: ϕ 38 mm
Mass (Weight)	About 630 g
Trigger Switch Mode	Both lever start mode and push start mode available (Switchable on a single unit)
Communication function	Wired (A separately sold communication cable is required.)
Output Signals	Fastening OK signal Fastening NG (NOK) signal Count-up signal Motor forward signal Motor reverse signal
Input Signals	Drive permission signal
Operation Panel (Display)	7-segment display
Operation Button	OK button / ▼ button / ▲ button

CAPACITY AND SPECIFICATIONS (cont.)

Notification (Lamp)	5-colour display (Detection lamp)
Notification (Buzzer)	3 steps of volume
Settings for Quantity Count	<ul style="list-style-type: none"> • Count method • Count return • Count reset • Ignore judgement time • Ignore Count Time • Batch complete judgement waiting time
Screw Fastening Quality Determination	Possible (Rotation time upper/lower limit setting)
Screw Fastening Support	<ul style="list-style-type: none"> • Soft start • Soft snug • Disable fastening time setting • Automatic rotation stop
Sequence Control	Possible (Setting required on the PLC side).
Others	Stopwatch Mode
Common Specifications	<ul style="list-style-type: none"> • Rotation direction switching (Forward/Reverse) • Braking ON/OFF setting
Included Items	<ul style="list-style-type: none"> • Screwdriver cord (2 m) • Screwdriver hanger • Clutch cover • Grip attachment (Supplied for EYADA407XC only)
Separately Sold Items	<ul style="list-style-type: none"> • Screwdriver cord (2 m/3 m) • Screwdriver hanger • Clutch cover • Grip attachment • Communication cable (3 m) • Power adapter (with a power cord)

These specifications are subject to change for performance improvement.

Power Adapter Specifications

Model No.	EYSZP001
Input Voltage	100 - 240 V AC, 50/60 Hz 2.6 A
Output Voltage	30 V DC, 3 A
Standby Power	0.16 W (100 V) 0.21 W (240 V) * When the screwdriver itself is not connected
Mass (Weight)	About 590 g
Size (Estimated Dimensions)	Overall Length (Long Side) 177 mm × Overall Height (Thickness) 44 mm × Overall Width (Short Side) 76 mm
Included Items	Power cord 1 m (With grounding plug. Detachable from power adapter itself)

CLEANING AND STORAGE

Cleaning

■ Wiping with Soft Cloth

Disconnect the power plug from the outlet, remove the screwdriver cord from the tool, and then wipe it with dry soft cloth.

Do not use wet cloth, thinner, benzene, alcohol, or other volatile liquids.

(Cause of discolouration, deformation, or crack)

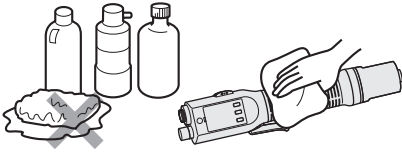

■ Conducting Periodic Inspection

- Periodically inspect for any loose screws, damage, or abnormal operation.
- Periodically inspect the power adapter for any signs of damage.

Storage

■ Avoid the following conditions during storage.

- Car cabin or other hot places
- Places exposed to direct sunlight
- Places exposed to water or dampness
- Places with a lot of foreign bodies or dust
- Places within reach of children
- Places with gasoline or other flammables
- Places with risk of fall

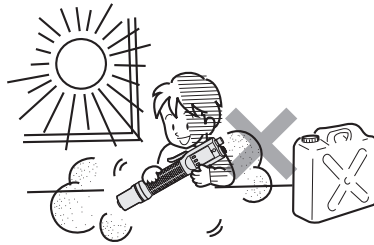

ERROR CODES

If there is any problem, an error code blinks on the display of the tool.

Consult the table below and take a necessary action.

- [E0] to [E7]
Pressing the OK button will clear the error display.
- [EE] and [F2] to [Fb]:
Press the OK button. Or pressing a switch will clear the error display.

If the problem persists, stop the use immediately.

Bring it to your dealer.

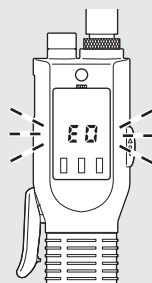

Display	Possible cause	Action
E0	In the setting mode, an inappropriate setting is input.	Review the setting to correct it. P. 54
E3	The tool is hot.	Interrupt the work and wait for it to cool down before use.
E4	The internal protective sensor is out of order.	Send the tool for repair.
E5	The tool is overloaded or the motor is out of order, for example.	Eliminate the condition(s) that caused the overload and recheck the condition. When this does not eliminate the problem, send the tool for repair.
E6	A cord or cords are not correctly connected.	Check whether the cords are correctly connected and whether no cords are broken. When no abnormality is found in the cords, the power adapter may be failed. Send the tool for repair.
E7	The tool circuit is failed or out of order, for example.	Send the tool for repair.
EE	The communication cable is broken or poorly connected, for example.	Check the communication cable.

■ Error codes for errors that occur during work.

Display	Possible cause	Action
F 2	During a fastening process, the tool was stopped before the clutch activated.	Nothing is wrong with the product. Keep the tool in action until the clutch activates.
F 3	During a fastening process, the rotation time has become higher than the upper limit or lower than the lower limit.	Nothing is wrong with the product. Check the workpiece and the setting for the rotation time. P. 35
F 6	During a fastening process, the forward/reverse lever was switched.	Do not switch the forward/reverse lever during a fastening process.
F 8	During a fastening process, the tool was overloaded or the motor failed.	Eliminate the condition(s) that caused the overload and recheck the condition. When this does not eliminate the problem, send the tool for repair.
F 9	During a fastening process, a cord or cords became poorly connected.	Check whether the cords are correctly connected and whether no cords are broken. When no abnormality is found in the cords, the power adapter may be failed. Send the tool for repair.
F A	During a fastening process, the internal protective sensor became out of order.	Send the tool for repair.
F b	During a fastening process, the tool became hot.	Interrupt the work and wait for it to cool down before use.

SETTING MODE LIST

c series count (Settings related to quantity count)					
c1	Count Quantity Setting P. 25	--	OFF	01	1 screw
c2	Count Method Setting P. 26	/		_1	Count-down mode
c3	Count Return Setting P. 27			--	OFF
c4	Quantity Reset Permission Setting P. 28	--	Not permitted	_1	Permitted
c5	Ignore Judgement Time Setting P. 29	-.-	OFF	0.1	0.1 s
c6	Ignore Count Time Setting P. 30	-.-	OFF	0.1	0.1 s
c7	Batch Complete Judgement Waiting Time Setting P. 31	-.-	OFF	0.1	0.1 s
u series utility (Utility settings that supports work)					
u1	Soft Start & Soft Snug Time Setting *1 P. 32	-.-	OFF	0.1	0.1 s
u2	Soft Start Speed Level Setting P. 33	/		01	Level 1 (About 25% of maximum)
u3	Soft Snug Speed Level Setting P. 34			01	Level 1 (About 25% of maximum)
u4	Rotation Time-based Detection Setting *2 P. 35	-.-	OFF	0.1	0.1 s
u5	Automatic Rotation Stop Setting P. 36	--	OFF	_1	ON
u6	Disable Fastening Time Setting P. 37	0.5	0.5 s	0.6	0.6 s
u7	Stopwatch Mode P. 38	--	OFF	_1	ON
n series notification (Settings related to notification, lamp, and buzzer)					
n1	Lamp Lighting Colour Setting P. 39	--	OFF (Off)	_1	Fastening OK: Green Count-up (Count complete): Blue
n2	Buzzer Pattern Setting P. 39	/		_1	A long beep
n3	Lamp Lighting Pattern Setting P. 40			--	OFF (Off)
n4	Buzzer (Volume) Setting P. 40	--	OFF (Mute)	_1	Low volume
b series basic (Basic settings and overall settings)					
b1	Brake Setting P. 41	--	OFF	_1	ON
b2	External-Output Signal Setting P. 41	/		_1	Count-up signal
b3	External-Input Drive Permission Setting P. 42			--	OFF (Not permitted)
b4	Tool reset permission P. 43	--	Not permitted	_1	Permitted

*1 Set two values, i.e. the time of soft start and the time of soft snug, in sequence.

*2 Set two values, i.e. the lower limit time and the upper limit time, in sequence.

	02	2 screws	~	99	99 screws
	_2	Count-up mode			
	_2	Return to start			
	0.2	0.2 s	~	9.9	9.9 s
	0.2	0.2 s	~	9.9	9.9 s
	0.2	0.2 s	~	9.9	9.9 s
	0.2	0.2 s	~	9.9	9.9 s
	02	Level 2 (About 33% of maximum)	~	10	Level 10 (Maximum speed)
	02	Level 2 (About 33% of maximum)	~	10	Level 10 (Maximum speed)
	0.2	0.2 s	~	9.9	9.9 s
	0.7	0.7 s	~	9.9	9.9 s
	_2	Fastening OK: Blue Count-up (Count complete): Green			
	_2	Three short beeps			
	_2	Fastening NG (NOK): Blinking red Other errors: Solid red			
	_2	Medium volume	_3	High volume	
	_2	Fastening NG (NOK) signal			
	_2	ON (Permitted, lamp off)			

INDEX

A	
Attaching Bit	14
Attaching Communication Cable	44
Attaching Grip Attachment.....	15
Attaching Screwdriver Hanger.....	13
C	
Changing Count Method.....	26
Communication Cable	12
Connecting to Power Supply	16
Count-down Mode	26
Count-up (Count Complete)	21
Count-up Mode.....	26
D	
Determining Fastening Status by Rotation Time	35
E	
Excluding Unexpected Rotations from Counting	29
F	
Fastening NG (NOK)	21
Fastening OK.....	20
Forward	13, 20
I	
Initialising Settings.....	24
L	
Lever Start Mode.....	17
M	
Making Rotation Stop Automatically after Set Time Has Passed	36
Manually Resetting Count	28
Measuring Rotation Time of Screw Fastening	38
P	
Permitting Tool Reset	43
Power Adapter	12, 16
Push Start Mode.....	17
R	
Redoing Screws after Count- up (Count Complete).....	31
Redoing Screws after Fastening OK ..	27
Removing Bit	14
Reverse Rotation.....	13, 20
Rotating Motor Slowly at Start of Fastening	32–33
Rotating Motor Slowly before Snugging	32–34
S	
Screwdriver Cord.....	12, 16
Selecting External Output Signal.....	41
Setting Braking for Rotation.....	41

Setting Buzzer (Volume) for Count-up (Count Complete).....	40
Setting Buzzer Pattern for Count-up (Count Complete).....	39
Setting Drive Permission for External Input.....	42
Setting Fastening Torque.....	18
Setting Lighting Colour of Detection Lamp	39
Setting Lighting Pattern of Detection Lamp for Problem Occurrence	40
Setting Number of Screws to Fasten..	25
Setting Screws Not to Be Counted If Fastened Again after Fastening OK.....	30
Setting Speed of Soft Snug	34
Setting Speed of Soft Start.....	33
Setting the Tool Not to Start during the Set Time after Fastening OK	37
Soft Snug.....	32
Soft Start.....	32
Stopwatch Mode.....	38
Switch to Setting Mode.....	22
Switching Rotation Direction of Electric Screwdriver	20
Switching Start Modes.....	17

T	
Trigger Switch Lock	13
U	
Using Forward/Reverse Lever.....	13
W	
When Connecting to PLC	44

-MEMO-

-MEMO-

-MEMO-

[India Only]

Information on hazardous constituents as specified in sub-rule1 of rule16 in electrical and electronic equipment.

Declaration of Conformity with the requirements of the E-Waste (Management) Amendment Rules, 2023 with the sub-rule1 of rule16 limits with respect to Lead, Mercury, Cadmium, Hexavalent chromium, Polybrominated biphenyls, Polybrominated diphenyl ethers.

The content of hazardous substance with the exemption of the applications listed in SCHEDULE II of the E-Waste (Management) Second Amendment Rules, 2023:

1. Lead (Pb) – not over 0.1% by weight.
2. Cadmium (Cd) – not over 0.01% by weight.
3. Mercury (Hg) – not over 0.1% by weight.
4. Hexavalent chromium (Cr6+) – not over 0.1% by weight.
5. Polybrominated biphenyls (PBBs) – not over 0.1% by weight.
6. Polybrominated diphenyl ethers (PBDEs) – not over 0.1% by weight.



For the purpose of recycling to facilitate effective utilization of resources, please return this product to a nearby authorized collection center, registered dismantler or recycler, or Panasonic service center when disposing of this product. Customer care number (Toll free) : 1800 103 1333 , 1800 105 1333 Please see the Panasonic website for further information on collection centers, etc. or call the customer care toll-free number <https://www.panasonic.com/in/corporate/e-waste-management.html>

Do's & Don'ts		
No.	Do's	Don'ts
1	All electrical and electronic products are required to be handed over only to the Authorized recycler.	The product should not be opened by the user himself / herself, but only by authorized service personnel.
2	The product should be handed over only to authorized recycler for disposal.	The product is not meant for re-sale to any unauthorized agencies / scrap dealers / kabariwalas.
3	Keep the product in an isolated area, after it becomes non-functional / unrepairable so as to prevent its accidental breakage.	The product is not meant for mixing into household waste stream.
4	Refer to Operating Instructions for handling of end of life products	Do not keep any replaced spare part(s) from the product in an exposed area.
5	Always dispose of products that have reached end of life at Panasonic Life Solutions India Authorized Service Centre.	Do not donate old electronic items to anybody. Do not dispose of your product in garbage bins along with municipal waste that ultimately reaches landfill.
6	Wherever possible or as instructed, separate the packaging material according to responsible waste disposal options and sorting for recycling.	Do not give e-waste to informal and unorganized sectors like Local Scrap Dealers / Rag Pickers.

[中国大陆]

松下住宅电器(上海)有限公司
上海市松江工业区江田东路 258 号
Panasonic 客户咨询电话：4008-209-376

Panasonic Corporation

1006, Oaza Kadoma, Kadoma-shi, Osaka 571-8501, Japan
<https://www.panasonic.com>

CN, EN
EY9310ADA203 2024.03 S
发行：2024年3月

中国印刷