

Panasonic



Certificates & Standards

RoHs / CISPR15 / SIRIM

Dimension and Materials

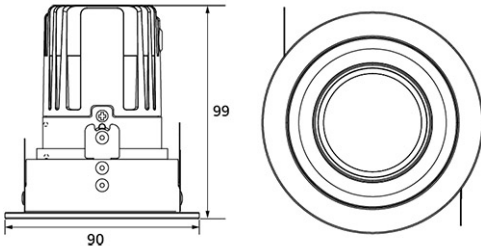

Photometric Chart

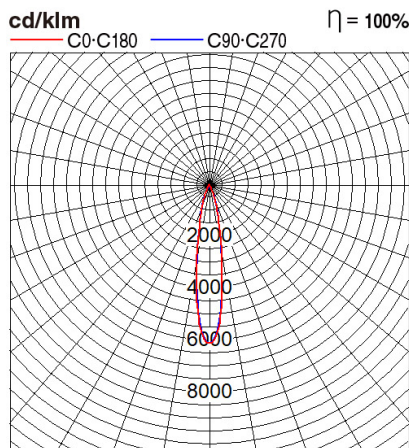

Ref. No.	
Type of Luminaire	Downlight
	Low Wattage Standard DL (Pro)
	AG
Set Model No.	NNV72056WE1A
Type of Light Source	LED
Power Input	13W
System Lumen Output	890 lm
System Efficacy	68 lm/W
Power Voltage	220-240V
Power Factor	0.95
Lifetime	50000H(L70)
CCT	3500K
CRI	90
SDCM	<5
Input Frequency	50/60Hz
Dimming	non-Dimmable
Dimming Range	
UGR	
Glare Cut Angle	
Beam Angle	15deg.
Rotation Angle	
Tilt Angle	
IP code	20
IK code	
Ambient Temperature Range	5 - 35°C
Surge Protection	
Classification of Luminaires	
THDi	
Effective Projected Area	
Driver	External
Cut Out Size	75mm
Dimensions	90mm*99mm
Weight	0.3 kg
Body	ADC
Reflector	PC
Diffuser	PC
Trim	
Casing	
Country of Origin	China
Brand	Panasonic
Remarks	Cut-out size: Φ 75mm

Spec and certification may change without notice.

Others